

SPINNING REEL REGAL RG-X5500-2B/REG-X6000-2B

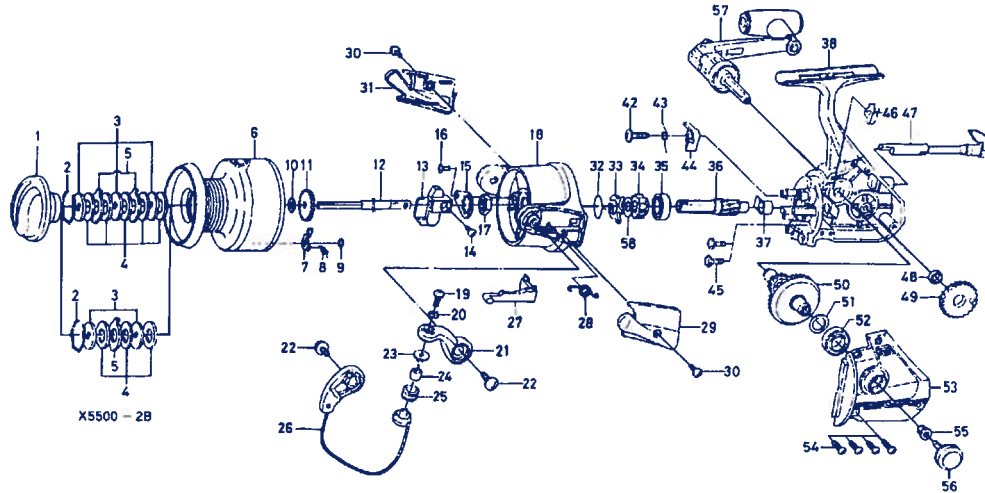

| Key No. | Parts No. | Parts Name |
|---------|-----------|---------------------------------|
| 2-9 | L13-6302 | Spool assembly (Aluminum Spool) |
| | E51-4105 | Spool assembly (Extra Spool) |
| 1 | F36-9802 | Drag knob |
| 2 | 171-7701 | Drag washer retainer |
| 3 | L03-1301 | Key washer |
| 4 | 373-3712 | Drag washer |
| 5 | B89-9501 | Eared washer |
| 6 | L13-6402 | Spool assembly |
| 7 | B07-8201 | Click pawl |
| 8 | 145-2101 | Click spring |
| 9 | 320-1402 | Click retainer |
| 10 | F22-5501 | Spool washer |
| 11 | L11-8501 | Click gear |
| 12 | F42-9501 | Main shaft |
| 13 | F42-9101 | Oscillating slider |
| 14 | 351-8901 | Oscillating slider screw |
| 15 | B02-1601 | Rotor nut holding plate |
| 16 | L01-1702 | Rotor nut holding plate screw |
| 17 | 340-8301 | Rotor nut |
| 18 | F39-4402 | Rotor |
| 19 | E45-4002 | Line roller screw |
| 20 | 160-8401 | Lock washer |
| 21 | F39-4302 | Bail arm |
| 22 | E00-7601 | Bail arm screw |
| 23 | F08-8301 | Line roller collar |
| 24 | E50-5901 | Line roller bushing |
| 25 | E50-6001 | Line roller |
| 26 | F39-3802 | Bail assembly |
| 27 | F41-3401 | Bail trip lever |
| 28 | F43-6401 | Bail spring |
| 29 | F39-3302 | Bail spring cover |
| 30 | E24-8101 | Bail spring cover screw |
| 31 | F39-3402 | Bail trip cover |
| 32 | F21-2001 | Anti-reverse pawl spring A |
| 33 | L07-0701 | Anti-reverse pawl spring B |
| 34 | F39-4201 | Anti-reverse ratchet |
| 35 | LC3-6401 | Ball bearing A |
| 36 | L11-4401 | Pinion gear |
| 37 | L00-6001 | Pinion collar |

| Key No. | Parts No. | Parts Name |
|---------|-----------|----------------------------|
| 38 | E53-5101 | Body assembly |
| 42 | L06-6501 | Anti-reverse pawl screw |
| 43 | L06-6401 | Anti-reverse pawl spring C |
| 44 | L07-8601 | Anti-reverse pawl |
| 45 | L01-1601 | Bearing retainer screw |
| 46 | E01-1801 | Anti-reverse cam -Spring |
| 47 | L10-0702 | Anti-reverse lever |
| 48 | B47-4101 | Oscillating gear collar |
| 49 | L11-4701 | Oscillating gear |
| 50 | L07-1701 | Drive gear |
| 51 | 371-2821 | Drive gear washer |
| 52 | B54-6001 | Ball bearing B |
| 53 | E53-5301 | Side cover |
| 54 | BS3-5002 | Side cover screw |
| 55 | F40-9001 | Handle collar |
| 56 | L00-9102 | Handle lock screw |
| 57 | F41-4601 | Handle assembly |
| 58 | F43-1001 | Ratchet washer |

RG-X6000-2B Special Parts

| | | |
|-----|----------|---------------------------------|
| 2-9 | F43-2501 | Spool assembly (Aluminum Spool) |
| | F43-2601 | Spool assembly (Extra Spool) |
| 18 | F39-4702 | Rotor assembly |
| 26 | F39-4002 | Bail assembly |
| 27 | F39-3501 | Bail trip lever |
| 38 | E53-4902 | Body assembly |
| 53 | E53-5303 | Side cover |