



26 SEABORG 500J (AS)

Instruction Manual

Index

Thank you for purchasing a SEABORG 500J. Please read this operation manual carefully and use the product safely and correctly to take full advantage of this electric reel with many convenient features for your on-board fishing. Please keep this operation manual carefully together with your reel for your future reference.

Caution

This document contains important instructions for using your electric reel. Please be sure to read them thoroughly before use. Note that we will not warrant for any use of the product without reading the Instruction Manual and the "Warning List" supplied with the product before use.

About the signs



This sign means "prohibited actions." Within the area or near this sign, specific prohibited actions are described.



This sign means "actions that require caution." Within the area or near this sign, specific actions that require caution are described.



This sign means "mandatory actions." Within the area of this sign, specific mandatory actions are described.



WARNING

The following pertains to matters that could cause problems or serious, even life-threatening injuries should the instructions be ignored or incorrectly followed.

-Be careful not to catch your fingers between the reel and the level wind, which is used to wind line into the spool evenly. It may cause injury.



Hands off!

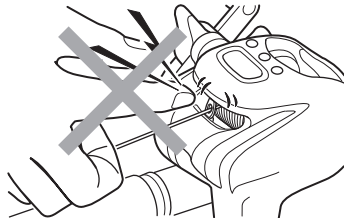

-When you turn on the clutch while feeding line (operated by the motor), it winds up the line. Be careful not to catch your fingers. It may cause injury.



Hands off!

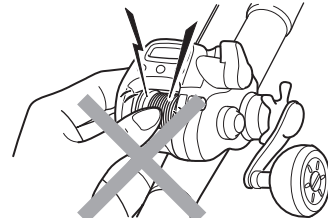

-Keep your eyes on your reel during use. Failure to do so may result in an unexpected accident or injury.



-For a big game fishing using large sized electric reel, make sure to fix the reel properly and firmly to the rod clamp or the holder. Failing to fix it firmly may result in an unexpected accident or injury.

Attach the reel onto the rod using the clamp provided.

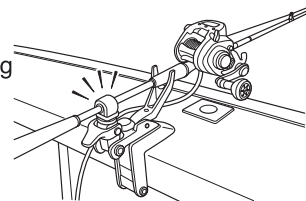

-Do not use the reel in an unbalanced and unnatural stance. Stand with your feet planted firmly on the ground to give you a balanced stance.

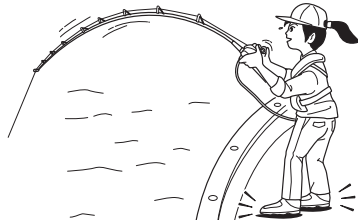

-Adults or parent's must supervise closely any use of this product by children. Use extreme caution to keep their fingers and hands away from moving parts or openings in the reel.



Cautious handling!

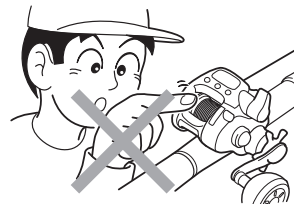

-A large sized electric reel has high power and careful handling is required. When applying a high load, please be careful of causing accidents, injuries and or damage to the rod holder, boat attachment, or rod, or people being dragged into the sea or the boat being pulled.

Caution

WARNING

The following pertains to matters that could cause problems or serious, even life-threatening injuries, should the instructions be ignored or incorrectly followed.

-Wear appropriate clothes and equipment during use. When you are not careful, you may be caught in the rotating parts or injured due to flying debris, resulting in serious injury or disability.

1. Keep your hair, clothing, and or gloves away from the rotating parts.
2. Wear non-slip footwear.
3. Cover long hair with a cap or hair cover.
4. Do not wear necklaces, neckties, or other jewelry and accessories that may be caught unexpectedly.
5. Be sure to wear equipment that protects your eyes, such as polarized glasses or eyeglasses.

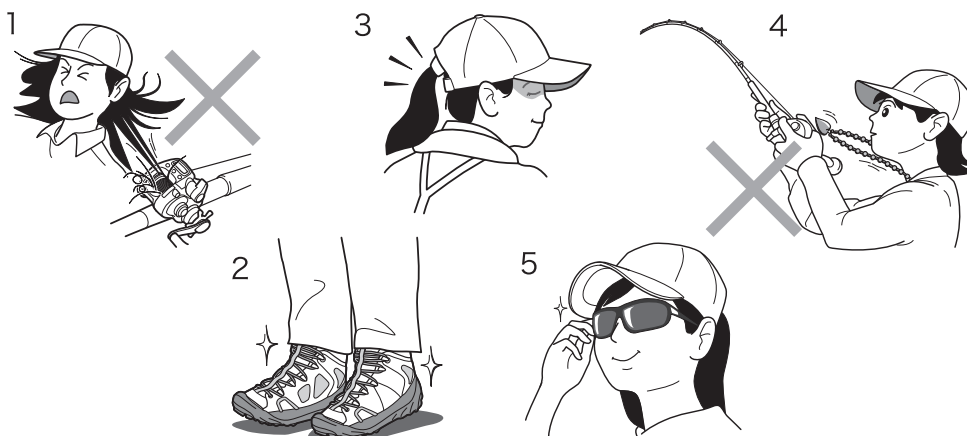

-Do not use and keep this product within the reach of children. Keep out of reach of children for storing or use of the product, as well as the reel itself, the packaged items and accessories.



Secure storage!



-When using batteries or the power supply of a boat, only apply the designated voltage. Other voltage may cause an abnormally high temperature in the electric reel, that could burn your hand or damage the microchip. Do not connect to house current or any AC (alternating current) power supply. The circuit may be short-circuited and result in smoke and fire.

-While using an electric reel, weak radio waves will be generated, which may affect medical equipment, such as malfunction of hearing aids and pacemakers. In particular for a person implanted with a heart pacemaker, use of electric reel may cause palpitations or dizziness; Do Not use this product.



Do not use!



Do not use!

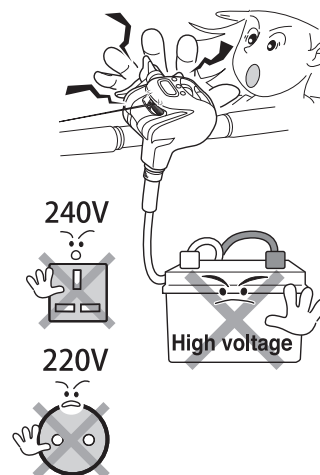

Caution

! WARNING

The following pertains to matters that could cause problems or serious, even life-threatening injuries, should the instructions be ignored or incorrectly followed.

-Do not immerse the battery in a conductive material such as water. Doing so may cause the battery to be shorted out, resulting in damage, fire or getting burned.



-Do not fasten an electric reel with a harness onto your body. You may risk your life if pulled into the seawater by a big fish or in other situations.



Do not use!



-Keep the reel, cords, and batteries away from combustible materials and flammable substances (liquids, gases, and powder dust) to prevent ignition or explosion.

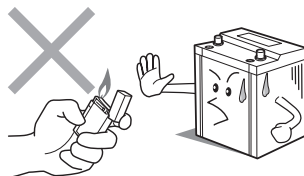

-Should the motor fail to stop for some reason while fishing, use caution to prevent your fingers being caught in the reel. Disconnect the power supply immediately.

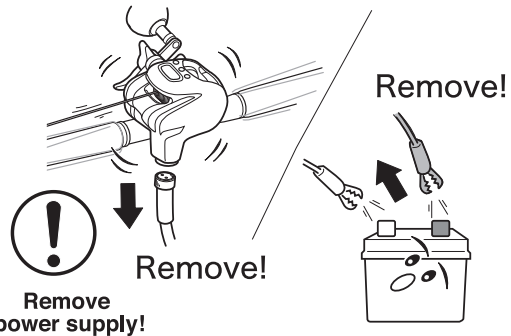

-Ensure to fix the electric reel securely to the reel seat before use. Do not use the reel if it is seated unsteadily and rattled or if it cannot be fixed firmly. If the reel comes off during fishing, you may be injured.

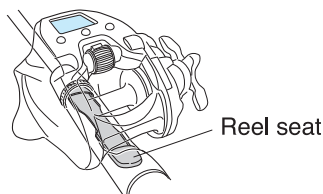

-Do Not connect the reel with the battery and or the cord when your hands are wet. Failure to do so may result in electric shock. If you connect it during rain, wipe your hands with a dry towel or the like and connect it quickly.

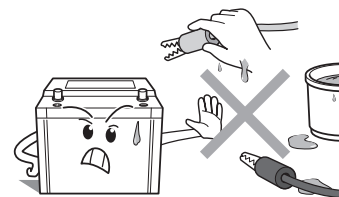

-Be careful not to get the power cord wrapped around your body. Failure to do so may result in getting dragged into the sea.



Cautious handling!



-Do not touch moving parts while in operation. It may cause injuries.



Hands off!

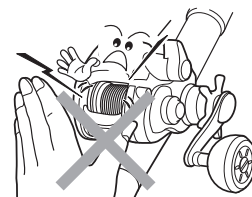

Caution

! WARNING

The following pertains to matters that could cause problems or serious, even life-threatening injuries, should the instructions be ignored or incorrectly followed.

-Follow the national and local regulations to dispose of the product and battery.

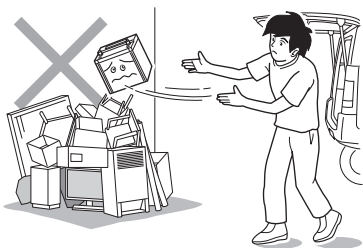

-Be sure to turn OFF the auto-wind lever before setting the dragging power. Failure to do so may result in your hand getting cut by the line while you are pulling it manually for setting the dragging power.



Stop winding

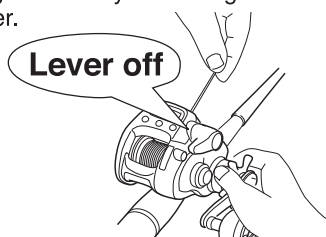

-Do not touch or grab the line when it is being released or wound rapidly. The line may cut your fingers.



Hands off!

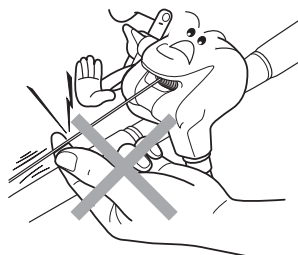

-Before reconnecting the power cable on the boat, thoroughly wipe away any moisture such as saltwater from the connecting parts with a dry cloth. If you connect it wet, it may short-circuit causing electric shock, smoke, or even fire.



Cautious handling!



-When you do not use the product for fishing, turn off the winding lever and power supply. Failure to do so may result in unintended operation of the product, resulting in injury or other problems.

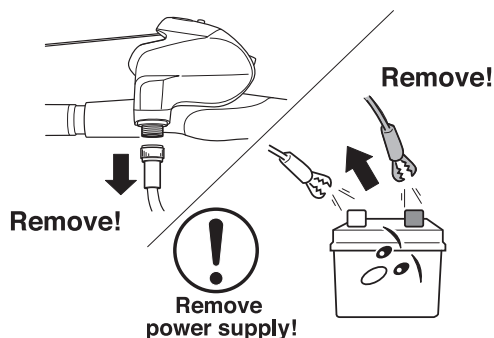

-Depending on the conditions of use or storage of the product, the cord may break or be shorted out, resulting in smoke or fire. Be sure to follow the "Precautions for Handling Cord", "Instructions for Maintenance of Cord" and "Other Precautions for Maintenance". Be sure to disconnect the power supply before maintenance of the cord. An old cord may cause breakage, short-circuit, or trouble. We recommend to replace the cord every two years or every 60 times of use, in order to maintain the performance of the reel.

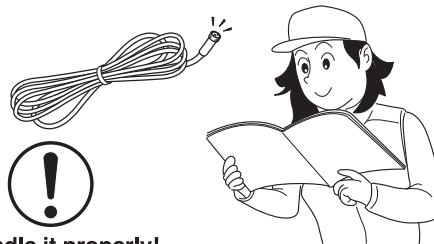

Handle it properly!

-Do not touch the heat-dissipating parts of the motor or the heat-generating parts of the drag as these parts may become hot, and there is a risk of burns.



Hands off!

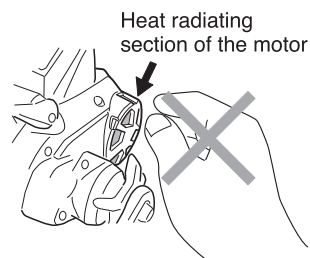

Caution

WARNING

The following pertains to matters that could cause problems or serious, even life-threatening injuries, should the instructions be ignored or incorrectly followed.

-Do Not attempt to disassemble or modify the reel. Failure to do so may cause problems with the performance of the reel or lead to malfunction. Also, this is not covered by the product warranty.



Do not modify!



-Do not modify the cable. It may cause a short-circuit or other problems and could result in smoke or fire.



Do not modify!



-Stop the operation before disconnecting the power supply. Failure to do so may result in malfunction. Shutting off the power while the reel is rotating may cause sparks, fire or explosion.

Remove!

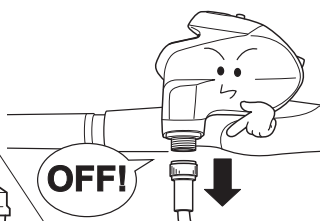
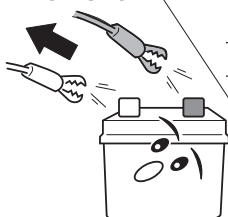

-In the event of abnormalities such as smelling burnt or leakage of electricity, immediately stop the operation and disconnect the power supply. Failure to do so may result in abnormal heat generation, fire, or electric shock.

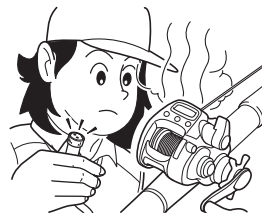

Remove power supply!

Remove!

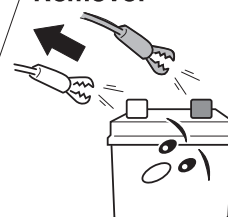

-Shocks, such as dropping the product, may cause breakage or damage to the internal electronic parts, cracks resulting in water intrusion, or short-circuit of the circuit board resulting in functional failure. Be careful not to apply strong shocks or heavy pressure to the product. (Even if there is no abnormality on its appearance, the product may be malfunctioned). Dropping the product also may cause you to be injured.



Cautious handling!

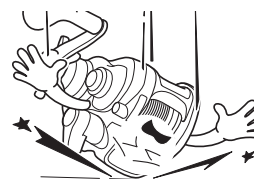

-Before going fishing, please check the reel for proper operation to ensure an enjoyable fishing trip.

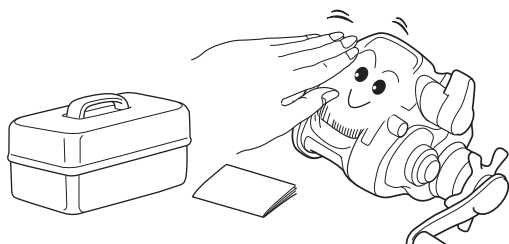

-Be careful not to get a piece of cloth, clothes, hair caught in the reel while winding up the line. Be careful not to wind the loosen line due to backlash, etc.

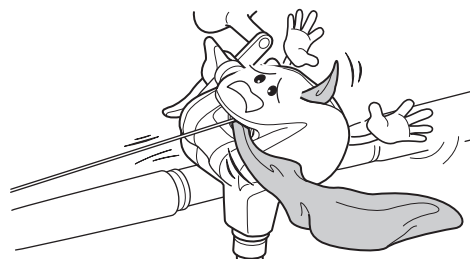

Caution

⚠ CAUTION

The following pertains to matters that could cause problems or serious, even life-threatening injuries, should the instructions be ignored or incorrectly followed.

-If the reel is dropped or shocked, the counter or the main body of the reel may crack resulting in water intrusion. Use of the reel in such a condition may cause the motor to be out of control, resulting in injury. Stop using the product and bring it to your nearest DAIWA dealer for repair.



Do not use!

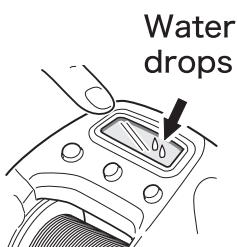

-When winding up line indoors, do so at high speed. If wound up at low speed and high tension, the motor may heat up abnormally and emit smoke. Power to wind up electronically may deteriorate.



Cautious handling!

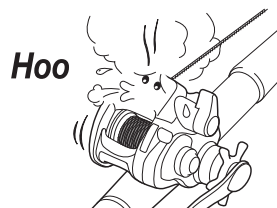

-Do not wind up with excessive force when line is tangled with other angler's lines or snagged on the bottom. It may cause damage to your rod and other components.



Handle with care!

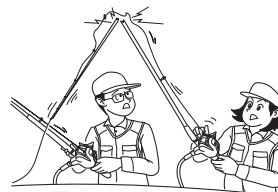

-Do not put a magnetic item such as magnet closer to the product. Otherwise, it malfunctions or causes failure.

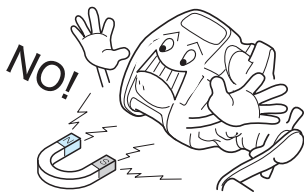

-When your hook is caught in the bottom, do not jerk the rod to free it. Pull the line with your hand and cut it if it fails to pull free. (Be sure to protect your hands with gloves or a towel.) If you use thick leader and cannot cut it with hands, talk to the captain for a safe treatment.



Risk of injury!



-Handle it cautiously as to not to stain your clothes with grease or oil from moving parts.



Cautious handling!



-Before connecting it to the power supply, be sure to loosen the drag well. If the IC breaks, and the motor does not stop, the terminal rig may be wound into the reel and the rod may break.



Required handling!

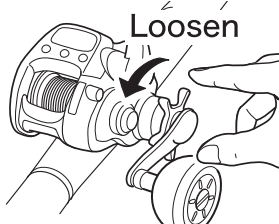

-Do not use wire line with your reel. It may cause corrosion or damage to the spool.



Do not use!

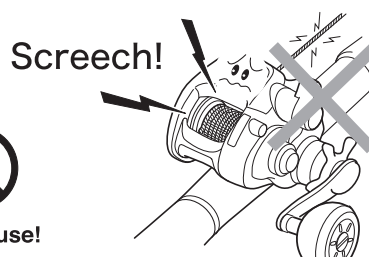

Caution

⚠ CAUTION

The following pertains to matters that could cause problems or serious, even life-threatening injuries, should the instructions be ignored or incorrectly followed.

-Use the reel only for the purpose of fishing.



Never use it for other purpose!

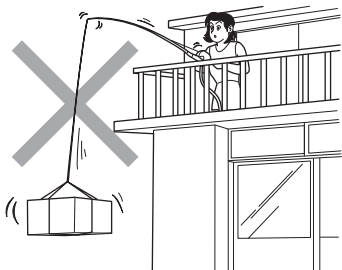

-Reset the counter whenever it displays the wrong number, you have cut off line, disconnected the power supply or changed Line thickness. If you use the reel without resetting the counter, your terminal rig may be pulled into the reel and break the rod or other components. Forgetting to reset it with your terminal rig at the water surface may cause the same problem.



Required operation!

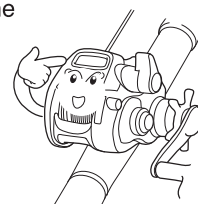

-Do not touch parts where the surface or top coatings (such as paint) are peeled off. It may cause injuries.



Hands off!



-Do not step on or place objects upon the reel. It may cause problems with the reel.

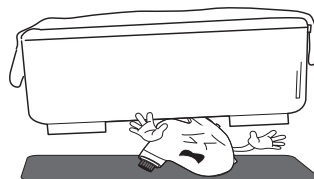

-Do not insert a stick or metallic object into the opening between the spool and the frame or other parts of the reel. It may cause problems with the reel.

NG!

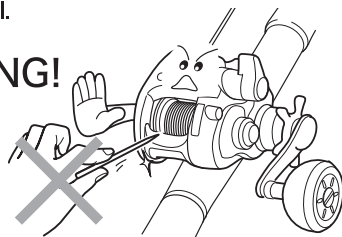

-Do not leave the reel near heating appliances. Resin may melt and deform or deteriorate causing problems.

Hoo

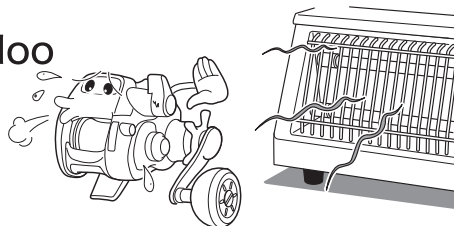

-Do not store a wet reel in a plastic bag or a fishing bag because it may cause rust or malfunction.

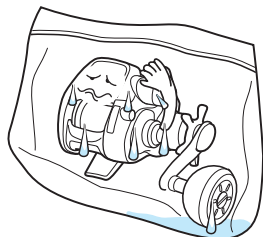

-When storing the reel for a long time, wipe down the moisture completely and preserve it in as well a ventilated place as possible without direct sunlight. Loosen the drag when storing it.

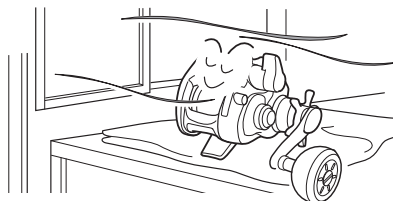

Caution

⚠ CAUTION

The following pertains to matters that could cause problems or serious, even life-threatening injuries, should the instructions be ignored or incorrectly followed.

-Use neutral detergent (dish washing detergent) when washing the electric reel. Do not use chlorine, acidic, or alcohol type cleaners. It may deteriorate resin and cause problems with the reel.

Neutral
detergent

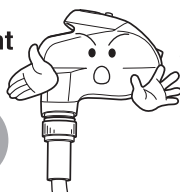

Chlorine, acidic,
alcohol



-Unplug the power supply and the cable when not in use.

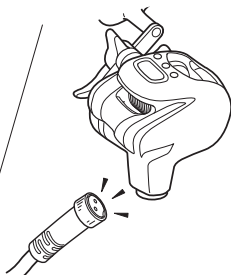

-Auto stopping position varies depending on the tension at which the line is wound up. Please do not reset to zero if the line is wound up under strong tension.

* Allow enough margin for setting the auto stop point. If you set it without enough margin, your fishing rod may be broken.



Cautious
handling!

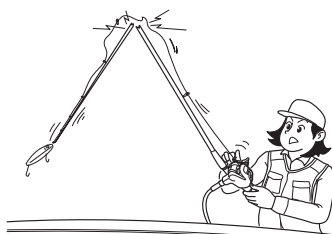

-When the reel is stored with the wet line with salt seawater, the spool may rust. Wash only the spool part with tap water to rinse off seawater sufficiently, and then dry it in a well ventilated place without direct sunlight before storing it.



-Do not store the reel with tightly-wound, damp line. During storage, the line may dry up and shrink, resulting in damage to the spool. Do not wind nylon or fluorocarbon line onto a model designated exclusively for PE line (braided line).

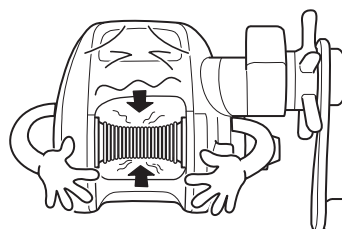

-If the breaker triggers repeatedly, the size of the reel does not match your fishing method or your target fish. Use a reel with the specifications and size that is best for your fishing.

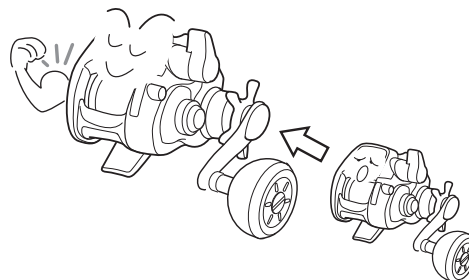

Caution

⚠ CAUTION

The following pertains to matters that could cause problems or serious, even life-threatening injuries, should the instructions be ignored or incorrectly followed.

-When shrinking a telescopic rod, do not tap rod butt on the ground with the reel attached. The reel may be damaged.

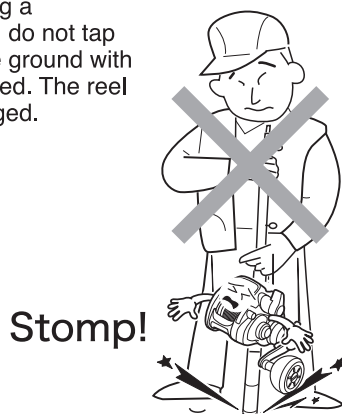

-When fixing the rod into a hole on the boat edge with the reel attached, verify that the reel does not touch the edge. When it touches, do not place it into the hole. The reel may be damaged.

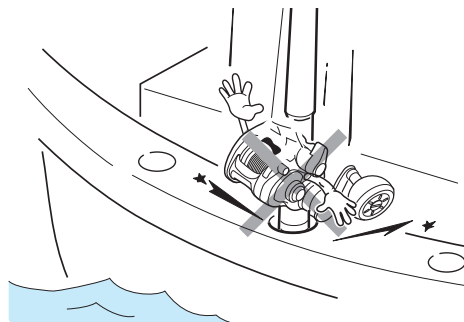

-Do not use the reel continuously without synchronizing the level-winding motion of the line and the withdrawal position of the line as the use of the reel under such conditions without synchronizing them may result in performance deterioration of rig dropping and drag pull out performance due to hindrances such as the line all being wound into the reel. Such hindrances may also lead to damage to the level wind and may cause injury from broken parts, so please avoid using the reel in such condition. If the above condition occurs, please withdraw all main line once from the reel and rewind it again.

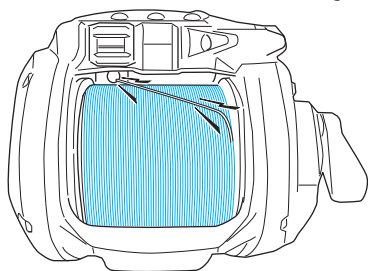

-During electric winding, if the drag slips while the motor is turned ON and the spool is not winding up the line for period, the grease and washers in the drag section may heat up, smoking and or burning, leading to damage to the breaker operation or damage of the main unit due to high temperature. Please avoid using of the reel under such abnormal condition.

In such case please be careful not to burn yourself by directly touching a part of the reel since it will become very hot under the above conditions. If any of the above conditions occur, overhauling of the reel is highly recommended as the drag and peripheral parts may not perform as they should.

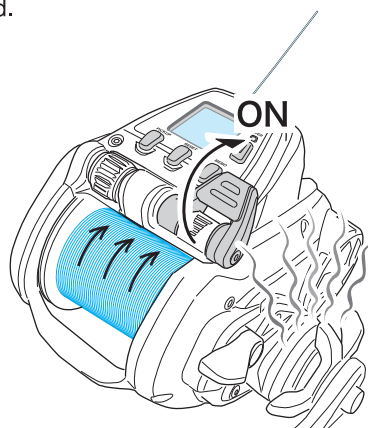

-In case drag withdrawal at high tension, at high speed is repeated for long period, the grease applied on the drag section and washers may heat up and smoke, leading to damage to the unit due to high temperature.

In such case please be careful not to burn yourself by directly touching a part of the reel since it will become very hot under the above conditions.

If any of the above conditions occur, overhauling of the reel is highly recommended as the drag and peripheral parts may not perform as they should.

Caution

(MAGSEALED mounted model) INSTRUCTIONS FOR HANDLING

This document contains important instructions regarding special attention that may be required when using an electric reel. Please be sure to read them thoroughly before use.

■ MAG SEALED

MAG SEALED is a revolutionary mechanism designed to make a wall with magnetic fluid and keep water out. While maintaining smooth rotation, it sustains the initial rotation performance for a long time by keeping out water and foreign substances. The elimination of annoying salt adhesion can remove degraded rotation or noise created during long-term use, resulting in significantly improved durability.

■ MAG SEALED ball bearing

Our unique technology has turned the ball bearing itself to MAG SEALED. The wall of magnetic fluid prevents water or foreign substances from entering the inner ball bearing, which substantially eliminates noise and rust or salt adhesion on the ball bearing.



Attention

- Never lubricate the MAG SEALED ball bearing to avoid the loss of the MAG SEALED function.
- Never disassemble the ball bearing to avoid the loss of the MAG SEALED function.



Attention

- The excellent rustproof and dustproof performances of the MAG SEALED ball bearing are provided by the wall of magnetic fluid (MAG OIL) enclosed in the ball bearing.
- MAG OIL enclosed slightly greater in quantity could seep out of the ball bearing surface, but it will not affect performances.
(Do not wipe off the oil seeping out of the surface.)
 - Never touch or wipe the MAG SEALED ball bearing with your finger, cloth or a cotton bud.
Wiping off MAG OIL could impair the MAG SEALED function.

◆ About the counter display

1. Excessively cold or hot weather, mid-winter (display's surface temperature is below -10 degrees centigrade) and mid-summer (display's surface temperature is above 60 degrees centigrade).
*In the above cases, the characters may be difficult to see due to the characteristics of the liquid crystal. Please note.
2. When light strikes the display from certain angles, the display's digits may have shadows. This does not affect its function.

Registered trademark: This is a product for which DAIWA has obtained a registered trademark. Please be careful of counterfeit and similar products. The manufacture and sale of counterfeit products is punishable by the laws of each country.

Power source

How to connect the power source

1. Attach the cord clips to the battery.
Red covered clip is the plus (+), and the black covered clip is the minus (-).
2. Insert the connector into the reel. After this, the display appears as below.
By taking the appropriate steps, the indication will change as shown below and the data will be set.

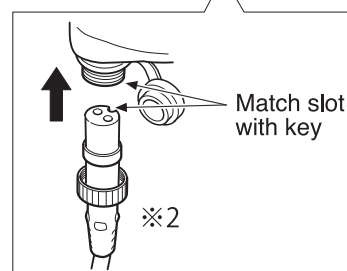
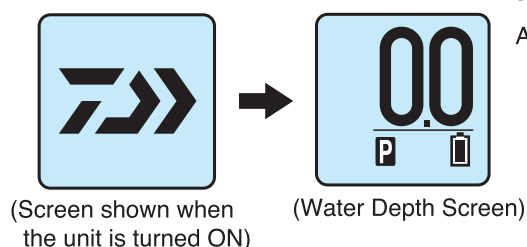
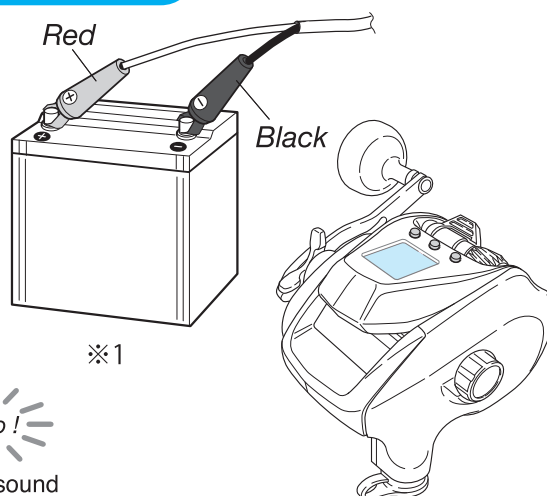

⚠ WARNING

* 1: Pay attention to the correct polarity. If the power cord is connected in reverse polarity (+/-), it will not conduct electricity and may also cause damage to the battery, the main unit, and the cord.

* Do not connect the power supply while your hands are wet with freshwater or seawater. Attempting to do so may result in electric shock. If you connect it during rain, wear rubber gloves before connecting it.

* 2: If it is connected incorrectly, it will not conduct electricity. Incorrect connection may cause short circuit, resulting in the power cord being broken.

* Do not place combustibles or inflammables near the power supply, the reel, or this product. It may cause fire.

Never connect lithium batteries in series, as this may cause a fire.

⚠ Attention

When changing batteries, the display's back up memory stays active for about 15 minutes after the old battery is disconnected. Thus the above display startup sequence does not need to replay when the new battery is connected within the 15 minute time frame.

Power source

About the power source

This reel is designed to be compatible with direct current DC 12 to 16.8 V. You may not use any power sources other than those specified to this reel (for example, AC100V from a household power supply and DC24V equipped on a boat).

The power source voltage on a boat tends to lose stability as it is largely influenced by a generator on board and wiring which may trigger the protective circuit causing sudden stop or intermittent operation of the reel. To maximize the reel performance, be sure to use the electric reel specific batteries.

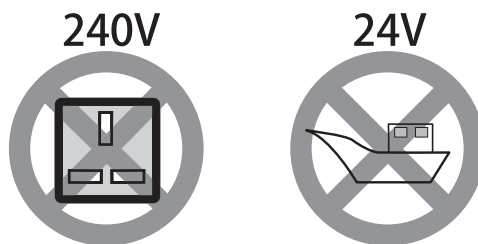

WARNING

1. We will not warrant any malfunctions or damages caused by the battery.
* Daiwa does not recommend to use any batteries of which product standards or safety standard Daiwa is not involved in and are labelled as compatible with Daiwa electric reels. Daiwa will not be liable for any accidents and damages caused by use of these batteries with Daiwa products. If you dare to use them, the use is at your own risk. Particularly, pay attention to the use of lithium batteries, which are likely to cause serious accidents.
2. Use of the power supply of your boat may cause damage to the supply system of the boat.
* If you use the power supply of the boat, do not use up all the power capacity while the engine is turned off.
* If the power supply is run out, the engine will not start and you will not be able to control your boat.
3. This reel is driven by DC 12V to 16.8V.
* Connecting it to a power supply with a voltage higher than 24 V or connecting to household power supply will damage the electronic circuit of the electric reel, resulting in the motor getting out of control. Incorrect connection may result in smoke or fire. Be sure to check the power supply environment and the specifications.

Attention

1. Do not use any power supply other than the specified ones.
As for the power source, we recommend the use of DEEPCYCLE battery which is waterproof secured for marine use.
Only the specified lithium power supply (in the country where it is sold) can be used for the reel.
* Please contact your nearest DAIWA dealer.
2. Connecting the unit directly to a household or marine power source may cause damage.
3. Recharge the battery before your fishing trip. Over time, a battery can naturally discharge.
4. Confirm the boat can provide the proper power source (i.e. voltage, connector shape etc).
-Corroded connections can prevent the flow of electric current. Remove any corrosion or dirt from the connectors.
5. Use a battery of the correct voltage output. Winding up with a high load while the voltage is low may damage electronic components.

Power source

Battery level indicator

When the battery voltage is lowered while powered ON, the battery level indicator becomes as shown below.

When the voltage goes down to 10V or less, the winding power of the reel is restricted and the maximum performance cannot be gained.

If this indicator is blinking while the motor is not running, battery voltage may be low due to decreasing of the residual capacity of the battery. If it is blinking, replace the battery with a recharged one (If you use the on-board power supply, check the voltage and the terminal of your boat).

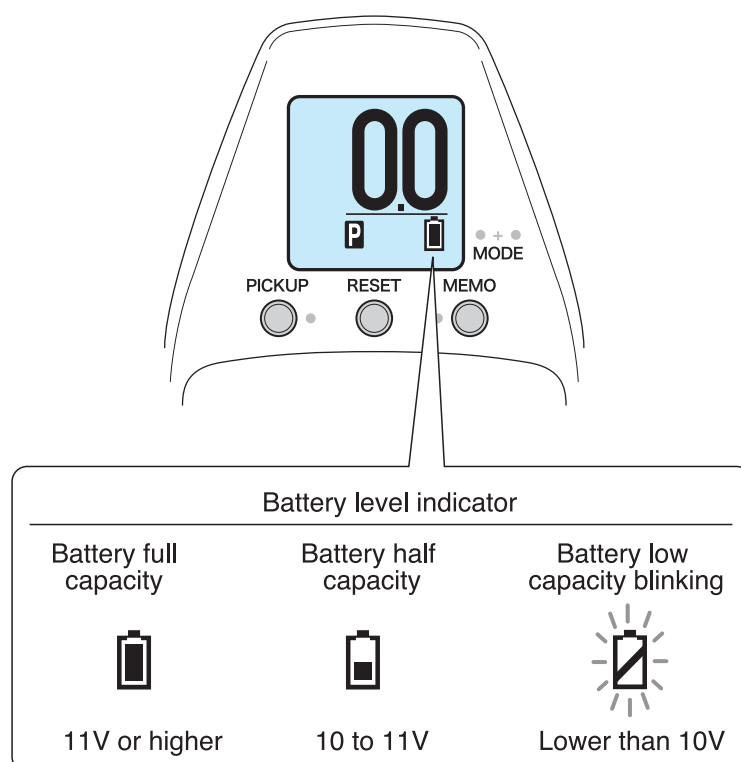

*There may be a slight difference between the reel detection voltage and the actual voltage of the power supply.

*When the battery runs out and the counter display goes out, be sure not to operate your electric reel manually to wind the line and be sure to replace the battery with a recharged one before doing any operations (relating to fishing). Any manual operation in such condition may cause the water depth counter to go out of order, resulting in the tip of fishing rod being broken due to accidentally winding up all the line when you restart an electrical winding later with a replaced battery.

*If you manually wind the line when the counter display is off, be sure to reset the water level to zero before loading the line next time. Since the counter value is out of order, there is a risk of damage to the rod due to entanglement.



-When a low battery indication appears, replace the battery with a fully charged one, as operation with low battery may cause problems with electric winding and or IC functions, etc.

Maintenance

About maintenance

This is a washable reel. Wash away salt residue and grit after fishing.

Maintenance procedure

1. Wash the reel with a dish washing detergent and a soft sponge. Do not use solvents.

*Do not use soap or other detergents. Other soaps or solutions may damage the reel both externally and internally.

*Recommended quantity: 1.5 ml per liter of water. The solution may damage the outside coating of the reel and may breakdown the grease inside of the reel creating an overflow of grease.

2. Rinse detergent and dirt away with running water, rinsing the spool very well to get rid of salt. Use warm water, under 30 degrees centigrade.

3. Dry the reel well.

*Loosen the drag when stored.

4. Lubricate the worm shaft, handle knob, and clutch.

*Excessive application of grease may adversely affect the original performance. Please be careful.

*Recommended grease: Genuine reel guard grease (product code: 2 380027)

Get the specific spray from a fishing-tackle store.

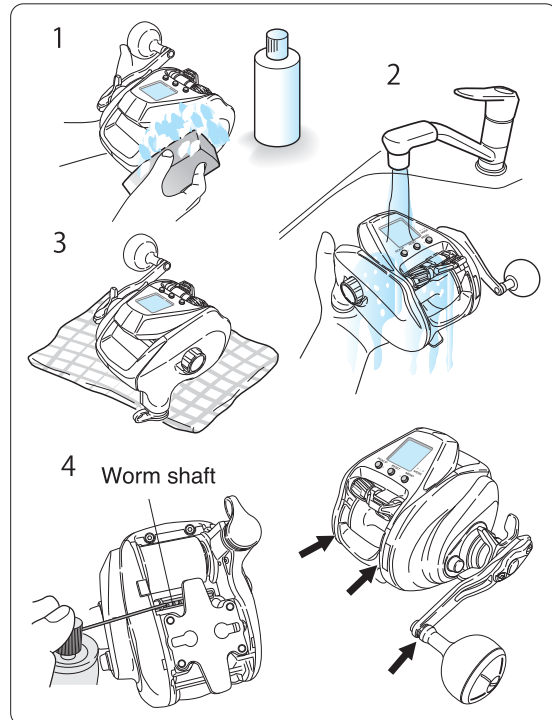

Attention

1. Do not wash with seawater or soak in water.
2. Do not use organic solvents such as benzene and thinner.
3. Do not use a steel brush or abrasive cleanser.
4. The fed oil may spring back and squirt. Do not peer down the worm shaft part.
5. Do not feed oil to water discharge hole.
6. Do not put magnetic force closer to the product main body.

-Do not lubricate the area around the IC counter or clean it with chemicals or other organic solvents. Doing so may lead to malfunction of the electrical components.

-Lubrication of any oils other than the specified one by the lubrication manual may cause malfunction of the reel.

-Do not disassemble the reel to clean the gears or other parts of the reel, as the internal structure is complicated.

-Do not use commercially available rust-preventive lubricants, etc., as they may result in the deterioration of the durability of the ball bearings and internal mechanical parts.

-When the reel is not in use, wrap it in the provided reel bag for storage.

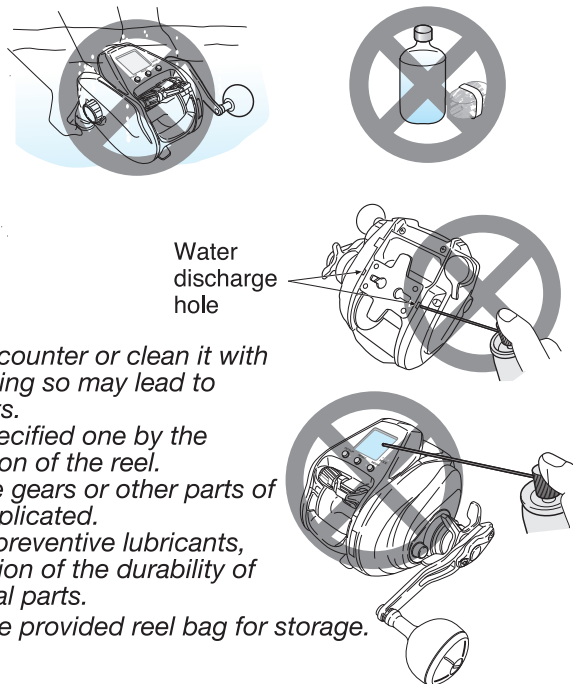

Maintenance

Handling and maintenance of the power cord

Follow the restrictions below to avoid troubles caused by disconnection of power cord and the like. Be sure to use the specific power cord supplied with the reel unit.

*Note that the unit is not compatible with any other power cord.

*Do not modify the power cord. It may cause an unintended failure. Be sure to keep the power cord intact.

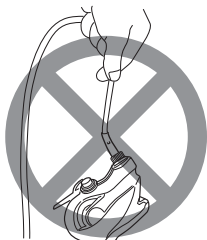

-Do not hang the reel by the power cord.

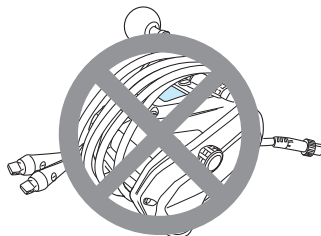

-Do not wind the power cord around the reel body with the connector inserted into the reel.

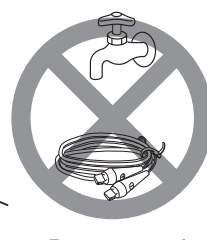
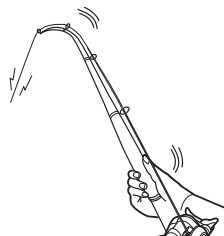

-Do not wash the power cord.

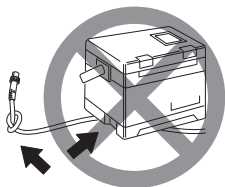

-Do not set heavy items on the power cord, or tie knots in the power cord.

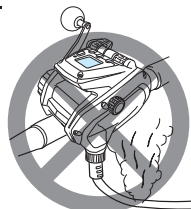

-If any abnormal events occur, including smoke and abnormal odor, stop the use of the power cord and remove it immediately from the battery.

-Note that the inner electric cable may be disconnected or broken despite of no visible damage on the appearance, if you step on the power cord, or if you pull the power cord strongly when it is trapped with cargoes, during use.

Maintenance of the power cord

-Wipe the power cord with a wet cloth and dry it well.

-Pay special attention to drying the tips, with cover removed.

-Grease the connector after it is dried.

*Recommended grease: SLPW connector grease 501 (Product code: 4 386502) The dedicated grease is available at fishing tackle shops.

-Disconnect the power cord from the reel before storing.

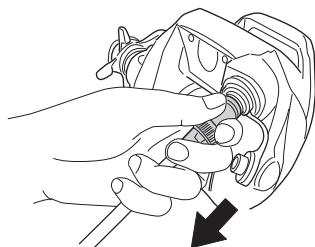

Hold the connector, not the power cord, to pull the power-cord from the reel.

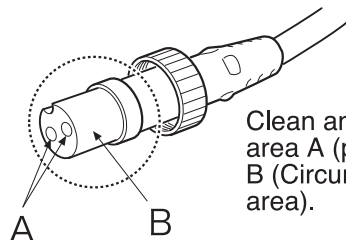

Clean and grease area A (pins) and area B (Circumferential area).

Other maintenance points

-This reel is a precision instrument that employs electric circuitry and motor. Do not disassemble the reel by yourself.

-Cover the power connector on the reel with its protection cap.

-An old cord may cause breakage, short-circuit, or trouble. We recommend to replace the cord every two years or every 60 times of use, in order to maintain the performance of the reel.

Names and functions of each part

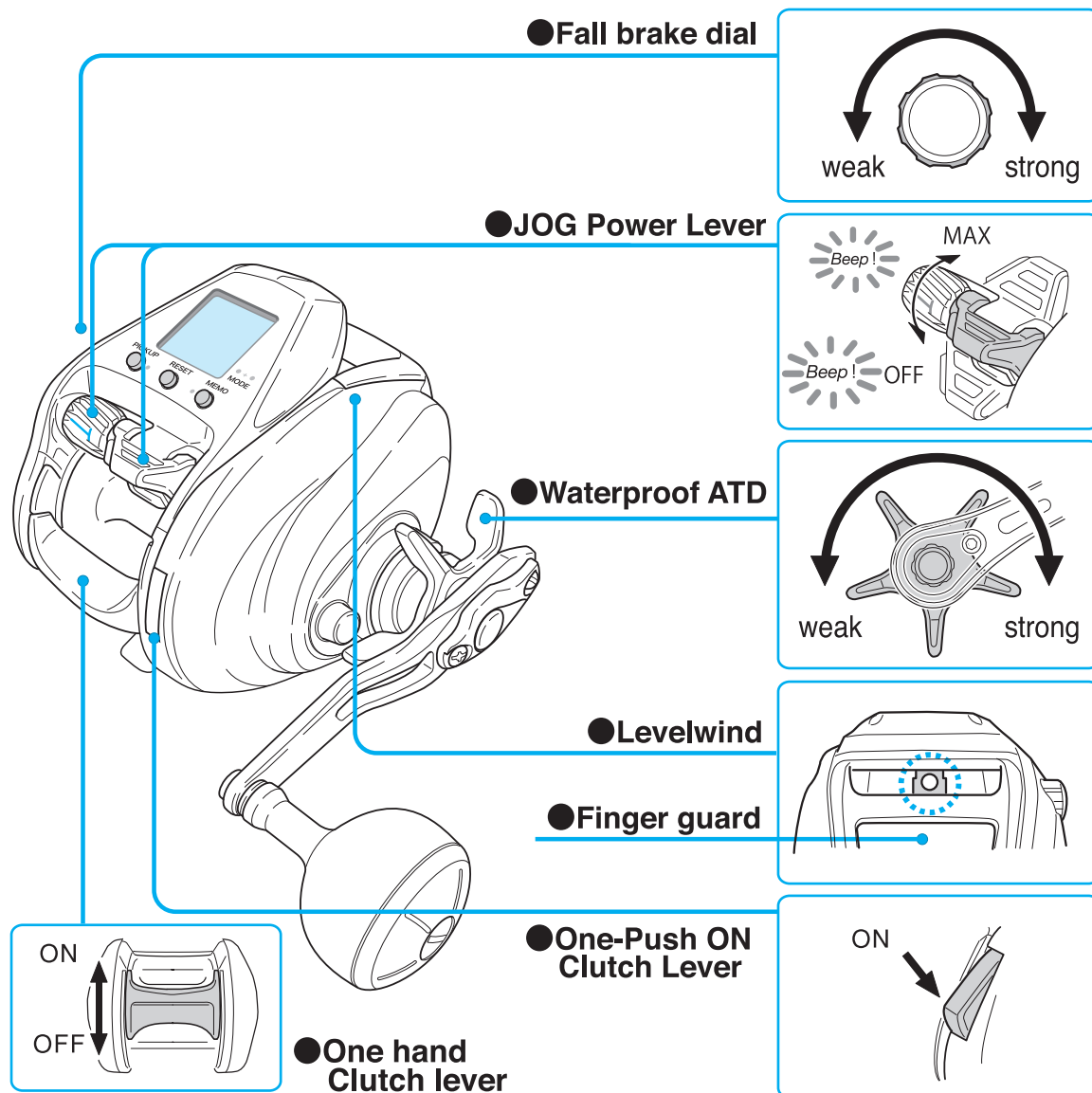

Accessories

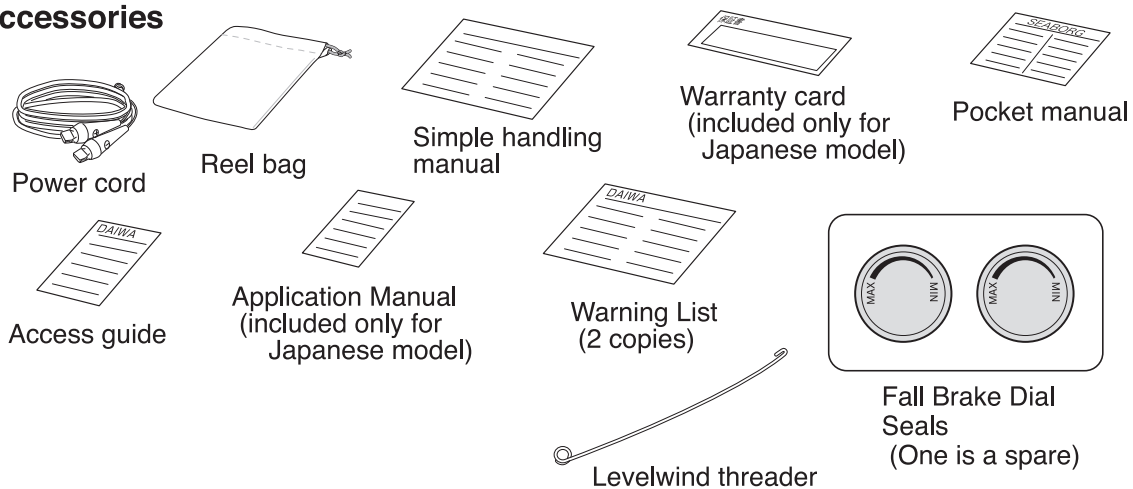

Names and functions of each part

●JOG Power Lever

- The right lever can be operated by pinching with your thumb and index finger.
- The left lever can be operated by rotating it with your thumb.
- You can freely adjust the winding power or the winding speed from OFF to MAX by using the lever.
- Turning the lever forward (toward MAX) will increase the winding power.
- Turning the lever back (toward OFF) will decrease the power.
- Check the position of the lever before you start winding. If it is not at OFF position, turn it back to OFF position (an audible alarm will sound to tell you that the lever has backed to the OFF position). Then, push the lever forward to start winding.
- Note that the lever does not accept your lever manipulation near the pre-set auto stop point for safety reasons.
- The displayed value for setting by the lever may fluctuate due to winding load fluctuation but it is not abnormal event.

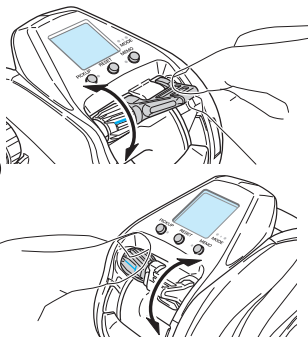

●Waterproof ATD *With a drag knob click system

- This is designed to provide a mechanism whereby adjusting the star drag allows the spool to slip against a strong pull to avoid line breakage.
- 1. Set the reel on the rod and put the line through the rod guide before adjusting the drag.
- 2. Adjust the tightness of the drag, with the clutch ON, manually pulling the line out from the reel. Normally, adjust the drag allowing the spool to slip before the line breakage (trace line).

●One-Hand Clutch Lever

- You can disengage the clutch by slightly pressing down with your thumb.
- ◆While it is turned ON: Turn the handle to wind up the line.
- ◆While it is turned OFF: Spool is free. Turn the handle clockwise to turn ON the clutch.

●One-Push ON Clutch Lever

- The clutch turns to ON by pressing the lever when the clutch is OFF.
- You can turn the clutch to ON quickly with your hand holding the rod.

●Motor ON/OFF interlocking clutch

- When the clutch is turned OFF during motorized winding (motor rotation), motor rotation stops temporarily. When the clutch is turned ON again, motorized winding (motor rotation) is automatically resumed.
- This allows the angler to catch a delicate sensing such as a fish bite during the fall or a squid's touch.
- When the line feeding is ON, the Motor ON/OFF Interlocking Clutch is turned OFF.

●Fall brake dial

- This is the unique brake system that allows anglers to instantly set the speed at which the bait falls by operating a dial.
- This system can also prevent backlash (line tangling caused by slacking of the line).
- Adjust the degree of tightening according to the swinging of your boat and the weight of the rig according to the markings on the dial.

●Levelwind

- The levelwind allows to ensure an even winding of the line on the spool that is passed through the guide.
- *The line may be wound unevenly on the spool depending on the winding condition in some cases.

●Accessories

- Power cord/Reel bag/Access Guide/Warning List (2 copies)/Simple handling manual/Warranty card (included only for Japanese model)
- *Motor only has 3-year warranty.
- Application Manual (included only for Japanese model)
- Pocket manual I(Jigging mode operation method)
- Levelwind threader
- It is used to put the line through the level wind.
- Fall Brake Dial Seals (One is a spare)
- Enclosed Fall Brake Dial seals are provided for you to stick on the dial to mark the target value of the sinking speed at which you wish to set.

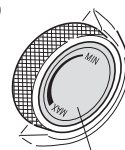

Fall Brake Dial Seal

- * Note: REMOTE JOG is sold separately.

⚠ Attention

- * When casting, the impact of the cast will cause the handle to rotate and the clutch to return. This is very dangerous as it may hit people around you or yourself. It may also lead to damage to the gears and internal parts. Please do not do this under any circumstances.
- * Do not place your fingers on the clutch lever when winding in the line. Also, do not set the hook or turn the handle while the clutch lever is pressed in. This can cause the clutch and stopper to malfunction or break.

Names of the buttons and the display

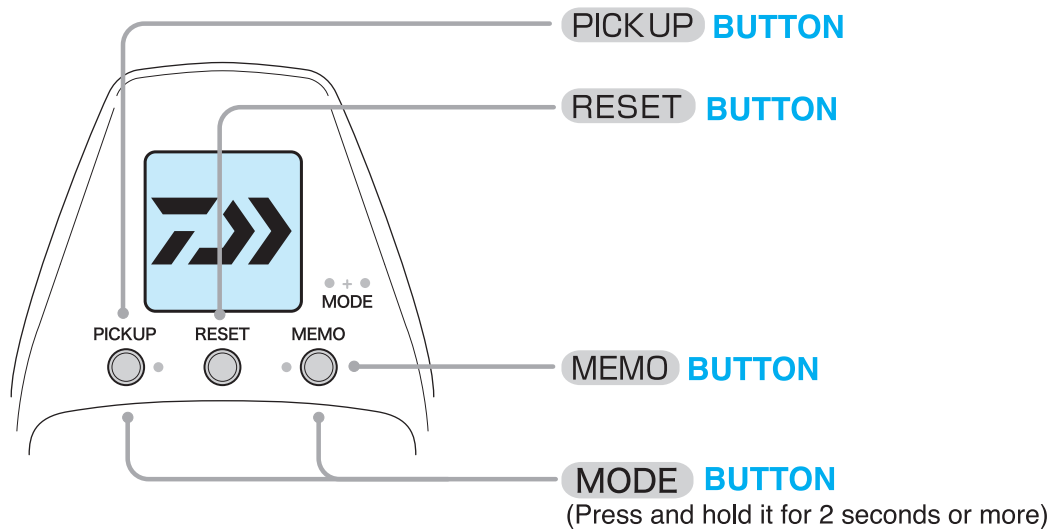

● RESET

- Press the **RESET BUTTON** once always before you start fishing.
The auto stop position is set based on the point where you pressed the **RESET BUTTON**.
- Pressing and holding this button for 2 seconds or more allows you to correct the data when the line has broken.

● MEMO

- This button is used to reset the inverse counter or resume the timer.
- Pressing and holding this button allows you to set the auto stop point.
- This button acts as **OK BUTTON** in the Menu screen.

● PICKUP

- This is used for quick winding, stopping, and jigging mode.
- This button acts as a **RETURN BUTTON** in the Menu screen.

● MODE (MENU)

- Simultaneously pressing and holding both **MEMO BUTTON** and **PICKUP BUTTON** for 2 seconds or more will open the screen where you can set various convenient functions.
- The button is used to execute Pickup, Pause and Jigging.
- This button acts as a **RETURN BUTTON** in the Menu screen.

Introduction

First connect to the power supply and select the language.

1. Turn ON your reel.

*As for connecting method, see
P10 "How to connect the power
source".

2. Select your desired language
with the JOG Power Lever.

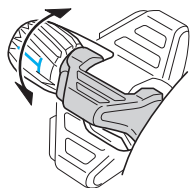

(Power ON screen)



3. Confirm if the language selected is OK
and press **OK** (**MEMO** **BUTTON**).

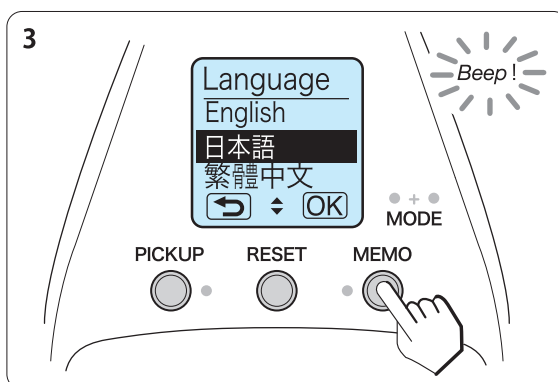

(Menu screen)

4. Select unit with the JOG Power Lever only
when you select "English"
and press

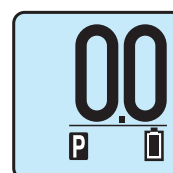
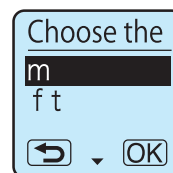
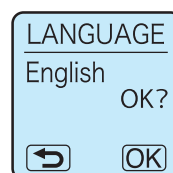

5. If the screen returns to the "Water Depth
screen", then the setting is completed.

Attention:

The language and unit initially set can be
changed afterward from the MENU
screen.

*Please refer to the page P64 "Language
setting ", page P64 "Unit setting" for the
details.

Functional setting [1. How to operate the Menu screen]

Setting of useful functions

-The Menu provides various useful functions for your fishing.

*Once you have set up a parameter, it is saved in the memory for your next fishing.
(Settings may not be saved in the memory if you turn off the power immediately after setting)

1. When the display shows **0.0** press and hold both **MEMO** **BUTTON** and **PICKUP** **BUTTON** simultaneously for 2 seconds to show the Menu screen.

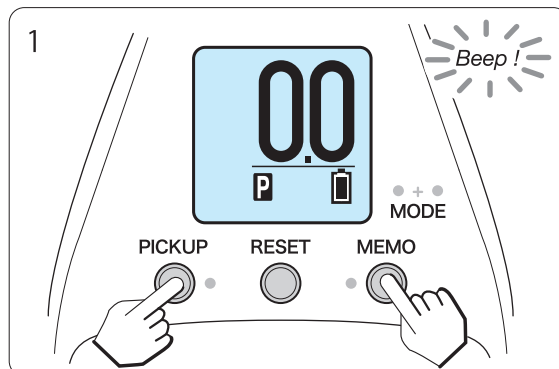

(Water Depth screen)

2. Select a parameter using the JOG Power Lever and press **OK** (**MEMO** **BUTTON**) to go the screen for setting.

*For details on setting of each parameter, please refer to the following pages.

You can select your desired parameter using the JOG Power Lever.

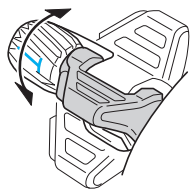

MEMO **BUTTON** +
PICKUP **BUTTON** (Press and hold)

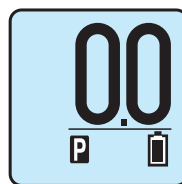

(Water Depth screen)

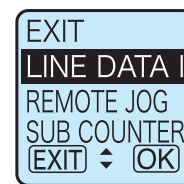

(Menu screen)

EXIT	
LINE DATA INPUT	
REMOTE JOG	
SUB COUNTER	
AUTO STOP	
JIGGING MODE	
SHORT WINDING/STOP	
LINE RELEASE ASST	
CHUM TIMER	
FUKASE MODE	
ALARM	
FIXED SPEED	
DRAG SOUND	
DEPTH ALARM	
DEPTH REVISION	
HISTORY	
LANGUAGE(言語)	
UNIT	
CERTIFICATION	
EXIT ⬇ OK	

→	See P21 - 33
→	See P34 and 35
→	See P36 - 38
→	See P40 and 41
→	See P44 - 48
→	See P43
→	See P42
→	See P53
→	See P55 and 56
→	See P62
→	See P54
→	See P50
→	See P51
→	See P57 and 58
→	See P59
→	See P62
→	See P63
→	See P63

Functional setting [1. How to operate the Menu screen]

■ Operation in the Menu screen

Here, the Menu screen is used as an example to how to operate the screen.

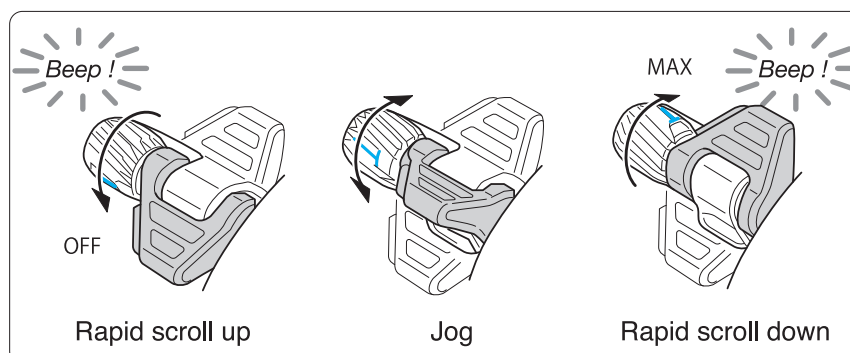
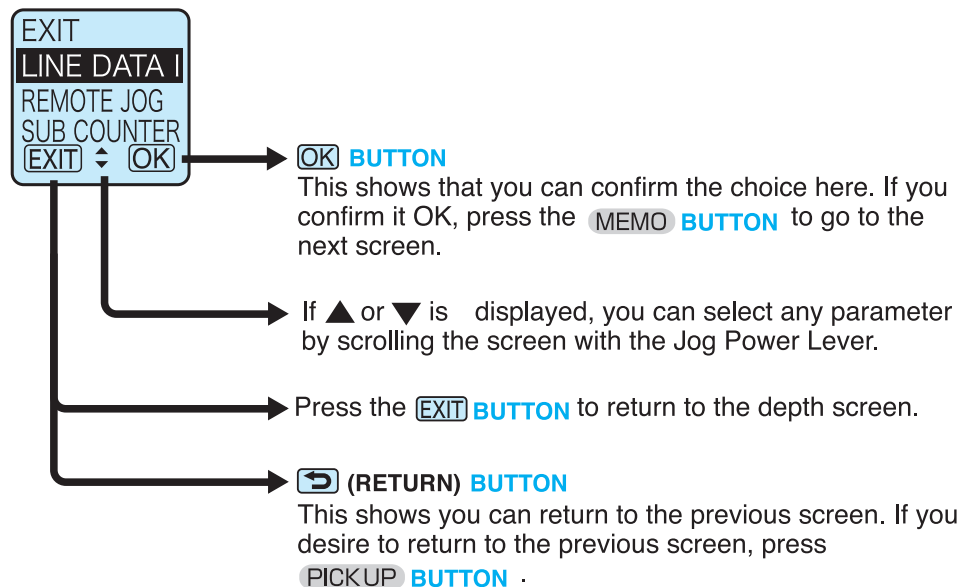

3. Once the settings have been completed, return to the Water Depth screen to start fishing.

Functional setting [2. Main line input]

P1 Line input

This function is convenient when you know the length of the fishing line to be wound on the reel.

(The following example explains how to insert a PE #4-500m fishing line.)



Watch out for Burns!

An overly heated motor may cause the frame to become very hot, so do not touch it directly when inserting the main line. Insert the line while holding the frame with a wet towel, etc.

1. Pass the main line through the Level Wind and tie it to the spool.

- *The enclosed threading pin facilitates the process.
- *Make sure to tie the line to the line stopper to prevent the line from slipping on the spool.
- *Tighten the drag.

2. Return the JOG Power Lever to OFF.

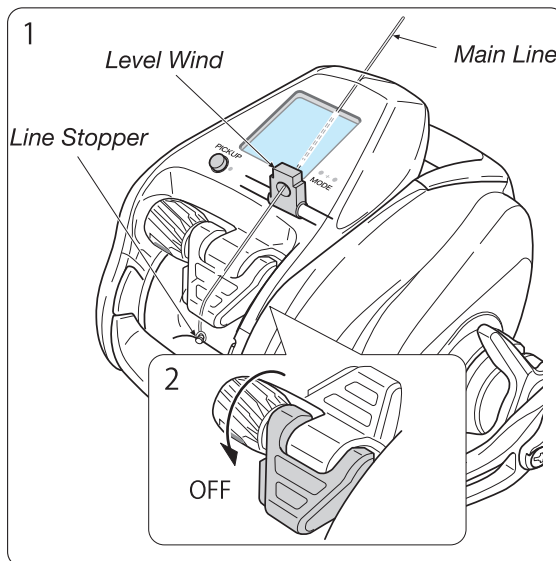

3. Turn on the reel.

*Please refer to the page 10 “[How to connect Power Supply](#)” for the details of the connection method.

3



(The screen when the reel is switched on)

4. When **0.0** is displayed, press and hold the switches **MEMO** **BUTTON** and **PICKUP** **BUTTON** simultaneously for 2 seconds.

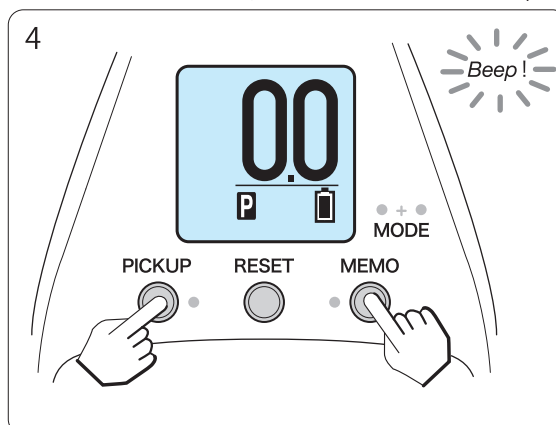

(Water Depth Screen)

Functional setting [2. Main line input]

P1 Line input

5. Select “**LINE DATA INPUT**” with the JOG Power Lever and press **OK** (**MEMO** **BUTTON**).

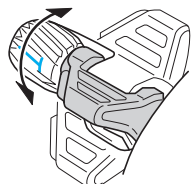

*By moving the JOG Power Lever, the selected item is highlighted on the screen.

*When the text «**Start**» is displayed, press **OK** (**MEMO** **BUTTON**) one more time.

6. Select “P1 When line length is known” and then press **OK** (**MEMO** **BUTTON**).

7. After adjusting the tension, turn the JOG Power Lever to the MAX position and then wind the main line.

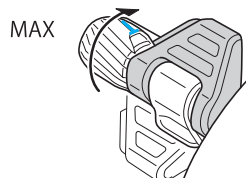

*While winding up the line, try to adjust the tension so that the mark ▼ stays around the screen center.

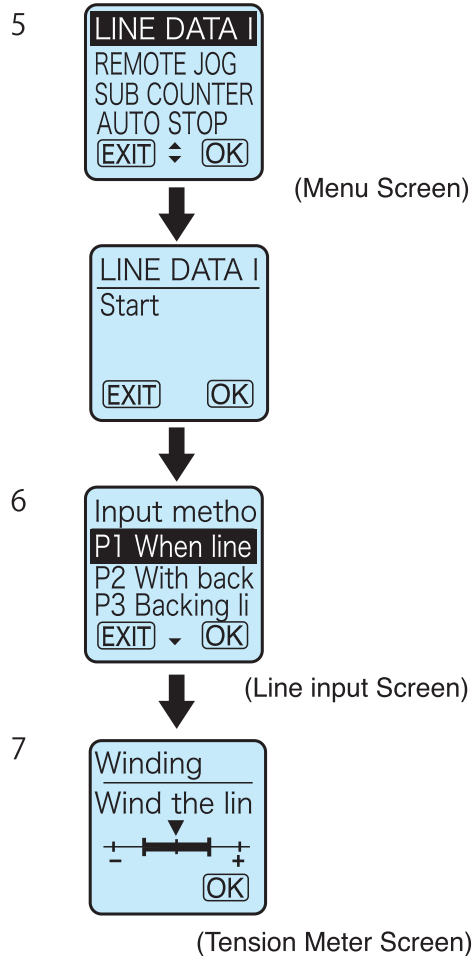

Attention

-The reel may be damaged if the line touches the finger-guard or the frame. Keep the line from touching these components.
-Winding the line indoors for a prolonged period at a low speed with an elevated tension may cause the motor to overheat and thus fail. When winding the line, turn the JOG Power Lever to the MAX position. When actually fishing outdoors, there is no need to worry because it is cooled with seawater, etc.

Functional setting [2. Main line input]

P1 Line input

8. When winding is complete, turn the JOG Power Lever back to the OFF position and then press **OK** (**MEMO** **BUTTON**) .

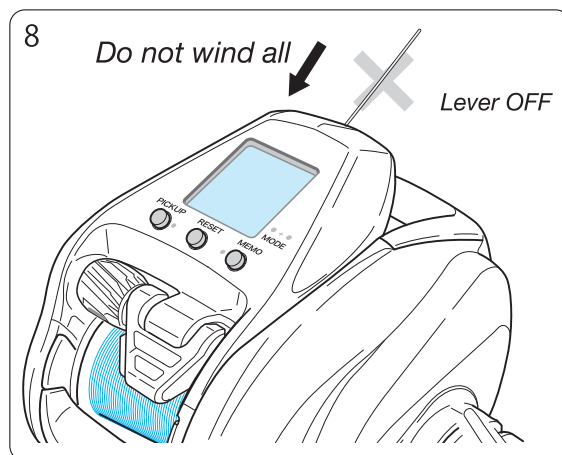
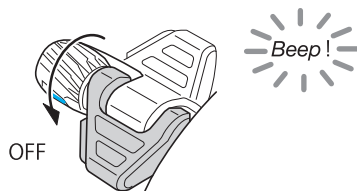

Attention

- Do not wind all the line. Before winding up all of the line, turn the JOG Power Level to the OFF position and then wind up the remaining line manually with the handle. Winding up all may cause an error with the counter.
- This winding method cannot be applied to lines thinner than PE #2.
- When winding a PE #2 line, the line may enter the gap between the spool and the frame if wound close to the spool's outer diameter; so it is advisable to wind the line up to about 1mm inside the outer edge of the spool.

9. Select the line length with the JOG Power Lever and then press **OK** (**MEMO** **BUTTON**) .

* When changing digits, press the **RESET** **BUTTON** to scroll.

*The illustration shows a case of inserting 500m.

*The default value is set at 500m.

*The value can be set for every 10m.

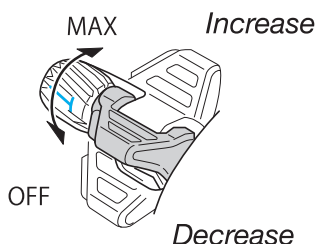

9

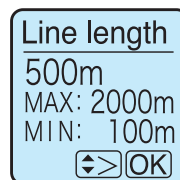

10

10. When "Complete" is displayed on the screen, press **OK** (**MEMO** **BUTTON**) and the display will return to the water depth screen to complete inserting the line.

*When "Error" is displayed while inserting the line, press **OK** (**MEMO** **BUTTON**) to return to the water depth screen and re-start the process from the beginning.

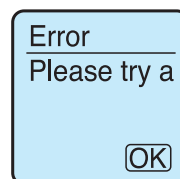
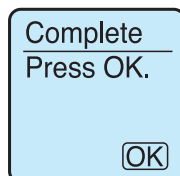

Functional setting [2. Main line input]

P2 Backing line input

Note that a 100 m or longer line of which length is known is necessary.



Watch out for Burns!

An overly heated motor may cause the frame to become very hot, so do not touch it directly when inserting the main line. Insert the line while holding the frame with a wet towel, etc.

1. Pass the main line through the Level Wind and tie it to the spool.

*The enclosed threading pin facilitates the process.

*Make sure to tie the line to the line stopper to prevent the line from slipping on the spool.

*Tighten the drag.

*If you have already completed winding of the backing line, skip this step and go to the next step.

2. Return the JOG Power Lever to OFF.

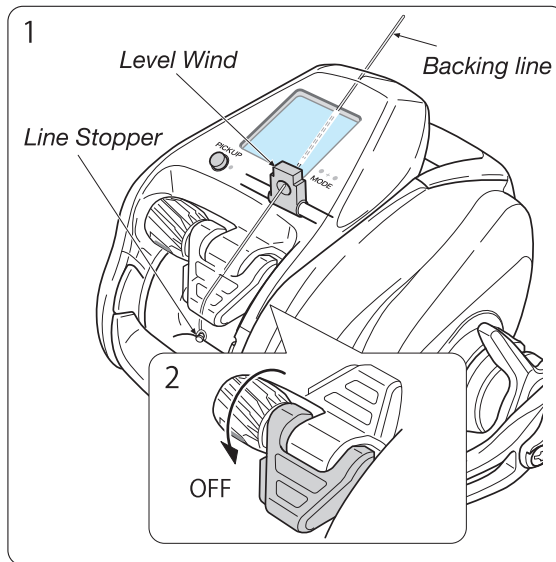

3. Turn on the reel.

*Please refer to the page 10 “[How to connect Power Supply](#)” for the details of the connection method.



(The screen when the reel is switched on)

4. When **0.0** is displayed, press and hold the switches **MEMO BUTTON** and **PICKUP BUTTON** simultaneously for 2 seconds.

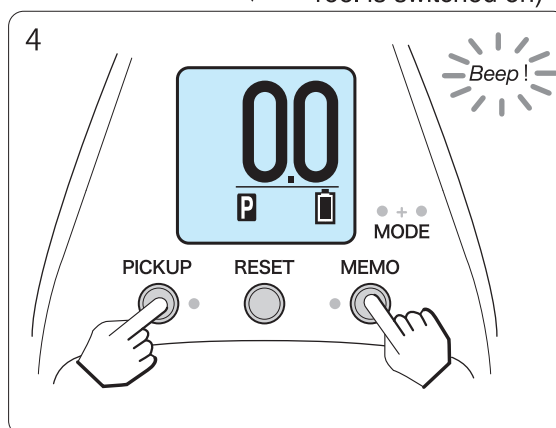

(Water Depth Screen)

Functional setting [2. Main line input]

P2 Backing line input

5. Select “**LINE DATA INPUT**” with the JOG Power Lever and press **OK** (**MEMO** **BUTTON**).

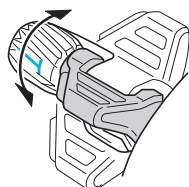

*By moving the JOG Power Lever, the selected item is highlighted on the screen.

*When the text «**Start**» is displayed, press **OK** (**MEMO** **BUTTON**) one more time.

6. Select “**P2 With backing line**” and then press **OK** (**MEMO** **BUTTON**).

7. Wind up the backing line. If winding of the backing line is completed, press **OK** (**MEMO** **BUTTON**).

* If you have already completed winding of the backing line, skip this step and go to the next step by pressing **OK** (**MEMO** **BUTTON**).

8. Firmly tie the main line to the backing line.

9. After adjusting the tension, turn the JOG Power Lever to the MAX position. and wind the main line up until the remaining line is 100 m, as checking the line color.

*While winding up the line, try to adjust the tension so that the mark ▼ stays around the screen center.

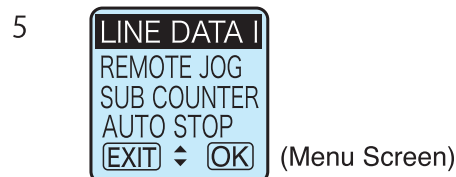
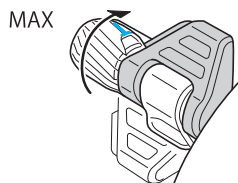

(Menu Screen)

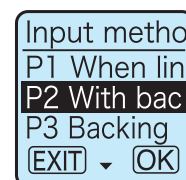
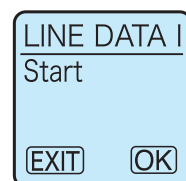

(Screen to select Backing Line Input)

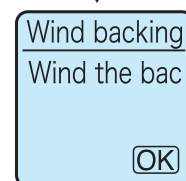

(Screen shown backing line winding)

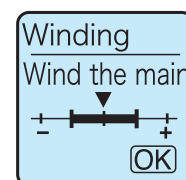
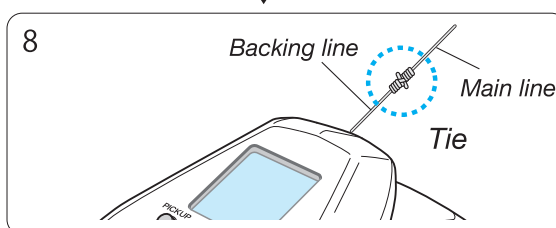

(Screen shown main line winding)

Functional setting [2. Main line input]

P2 Backing line input

Attention

- The reel may be damaged if the line touches the finger-guard or the frame. Keep the line from touching these components.
- Winding the line indoors for a prolonged period at a low speed with an elevated tension may cause the motor to overheat and thus fail. When winding the line, turn the JOG Power Lever to the MAX position. When actually fishing outdoors, there is no need to worry because it is cooled with seawater, etc.

10. When winding is completed, turn the JOG Power Lever back to the OFF position and then press **OK** (**MEMO** **BUTTON**).

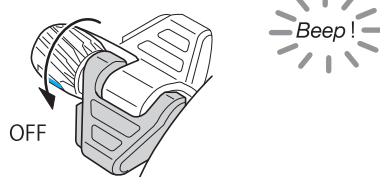

11. After adjusting the tension, turn the JOG Power Lever to the MAX position. Wind on another 50 m of line as checking the line color.

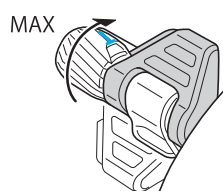

11

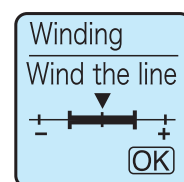

(Screen shown main line winding)

*While winding up the line, try to adjust the tension so that the mark ▼ stays around the screen center.

12. When winding is completed, turn the JOG Power Lever back to the OFF position and then press **OK** (**MEMO** **BUTTON**).

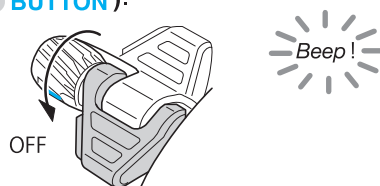

13. After adjusting the tension, turn the JOG Power Lever to the MAX position and wind the main line up to its end as checking the line color.

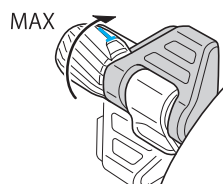

13

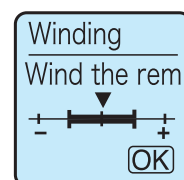

(Screen shown main line winding)

*While winding up the line, try to adjust the tension so that the mark ▼ stays around the screen center.

Functional setting [2. Main line input]

P2 Backing line input

Attention

- Do not wind all the line. Before winding up all of the line, turn the JOG Power Level to the OFF position and then wind up the remaining line manually with the handle. Winding up all may cause an error with the counter.
- This winding method cannot be applied to lines thinner than PE #1.
- When winding PE #1 or #2, winding the line near to the spool outer diameter may cause the PE line to get pinched between the spool and frame. So, it is recommended to wind the line approximately 1 mm less than the spool outer diameter.

14. When winding is completed, turn the JOG Power Lever back to the OFF position and then press **OK** (**MEMO** **BUTTON**).

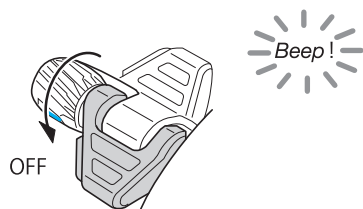

15. When “Complete” is displayed on the screen, press **OK** (**MEMO** **BUTTON**) to return to the Water Depth screen and complete the data input of the line.

*If “Error” appears on the screen while inputting the line data, press **OK** (**MEMO** **BUTTON**) to return to the Water Depth screen and re-start the process from the beginning.

15

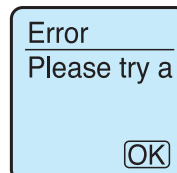

Functional setting [2. Main line input]

P3 Line re-input

This method is convenient for re-feed the line after pulling it out from completely wound-up spool. However, a main line of measurable length of at least 100 meters is required.

1. Pass the main line through the Level Wind and tie it to the spool.

- *The enclosed threading pin facilitates the process.
- *Make sure to tie the line to the line stopper to prevent the line from slipping on the spool.
- *Tighten the drag.

2. Return the JOG Power Lever to OFF.

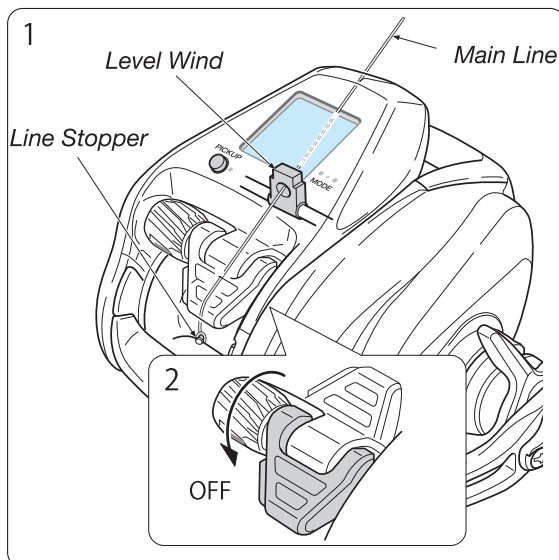

3. Turn on the reel.

- *Please refer to the page 10 “[How to connect Power Supply](#)” for the details of the connection method.

3



(The screen when the reel is switched on)

4. When **0.0** is displayed, press and hold the switches **MEMO BUTTON** and **PICKUP BUTTON** simultaneously for 2 seconds.

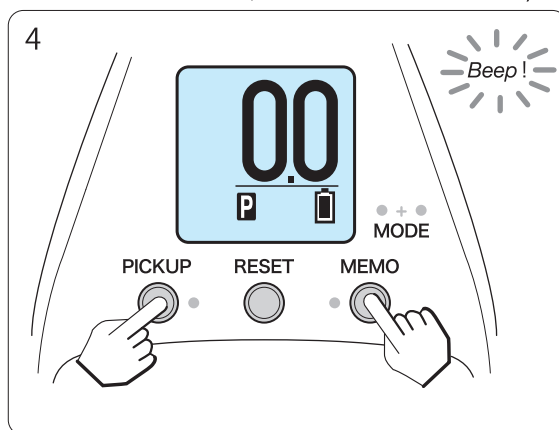

(Water Depth Screen)

Functional setting [2. Main line input]

P3 Line re-input

5. Select “**LINE DATA INPUT**” with the JOG Power Lever and press **OK** (**MEMO** **BUTTON**).



*By moving the JOG Power Lever, the selected item is highlighted on the screen.

*When the text «**Start**» is displayed, press **OK** (**MEMO** **BUTTON**) one more time.

6. Select “**P3 Backing line 2**” and then press **OK** (**MEMO** **BUTTON**).

7. After adjusting the tension, turn the JOG Power Lever to the MAX position and then wind the main line.

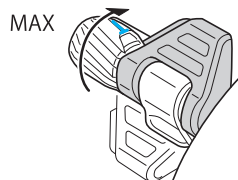

*While winding up the line, try to adjust the tension so that the mark ▼ stays around the screen center.

*When you have already completed winding the main line, simply press **OK** (**MEMO** **BUTTON**).

5

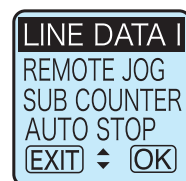

(Menu Screen)

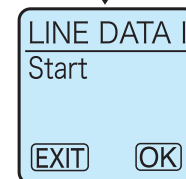

6

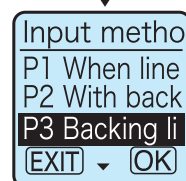

(Line input Screen)

7

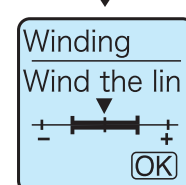

(Tension Meter Screen)



Attention

- The reel may be damaged if the line touches the finger-guard or the frame. Keep the line from touching these components.
- Winding the line indoors for a prolonged period at a low speed with an elevated tension may cause the motor to overheat and thus fail. When winding the line, turn the JOG Power Lever to the MAX position. When actually fishing outdoors, there is no need to worry because it is cooled with seawater, etc.
- This line mounting method cannot be used for fine lines of less than PE #1.
- When winding PE #1 or #2, winding the line near to the spool outer diameter may cause the PE line to get pinched between the spool and frame. So, it is recommended to wind the line approximately 1 mm less than the spool outer diameter.

Functional setting [2. Main line input]

P3 Line re-input

8. When winding is completed, turn the JOG Power Lever back to the OFF position and then press **OK** (**MEMO** **BUTTON**) .

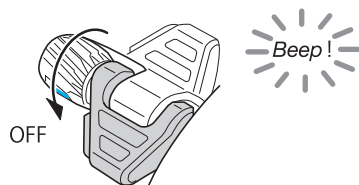

9. Pull 50 m of the line out of the reel as checking the line color and press **OK** (**MEMO** **BUTTON**) .

10. Pull another 50 m of the line out of the reel as checking the line color and press **OK** (**MEMO** **BUTTON**) .

11. When “Complete” is displayed on the screen, press **OK** (**MEMO** **BUTTON**) to return to the Water Depth screen. Wind up the line that you pulled out from the reel. If you wound it up, the procedure is completed.

*If “Error” appears on the screen while inputting the line data, press **OK** (**MEMO** **BUTTON**) to return to the Water Depth screen and re-start the process from the beginning.

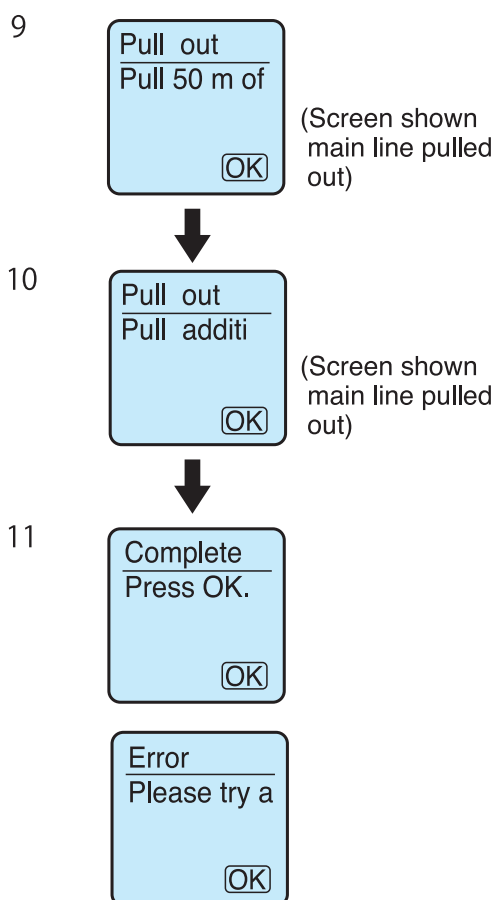

Functional setting [2. Main line input]

P4 Line re-input

This is the method to feed the line by pulling it out 10 meters from the fully wound-up spool.

※This method cannot be used after an error occurs during P1/P2/P3 input, or when the line is already fully wound.

1. Pass the main line through the Level Wind and tie it to the spool.

*The enclosed threading pin facilitates the process.

*Make sure to tie the line to the line stopper to prevent the line from slipping on the spool.

*Tighten the drag.

2. Return the JOG Power Lever to OFF.

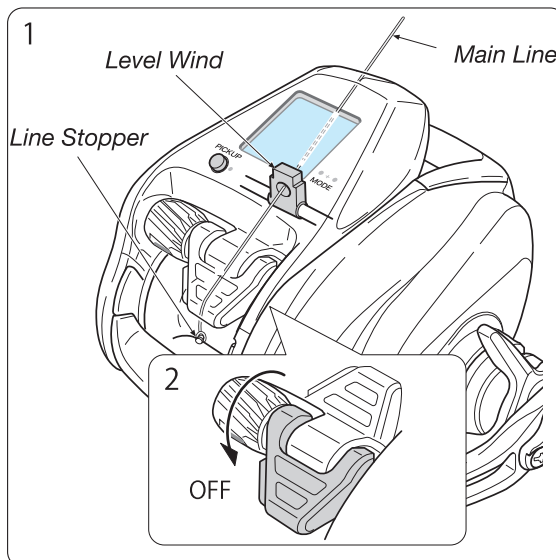

3. Turn on the reel.

*Please refer to the page 10 “[How to connect Power Supply](#)” for the details of the connection method.

3



(The screen when the reel is switched on)

4. When **0.0** is displayed, press and hold the switches **MEMO** **BUTTON** and **PICKUP** **BUTTON** simultaneously for 2 seconds.

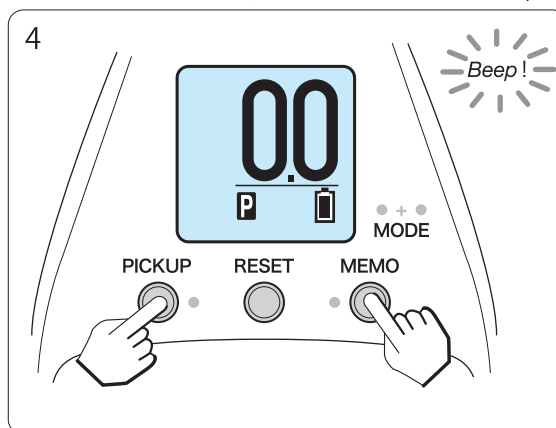

(Water Depth Screen)

Functional setting [2. Main line input]

P4 Line re-input

5. Select “**LINE DATA INPUT**” with the JOG Power Lever and press **OK** (**MEMO BUTTON**).

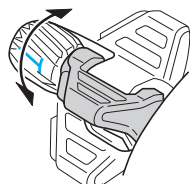

*By moving the JOG Power Lever, the selected item is highlighted on the screen.

*When the text «**Start**» is displayed, press **OK** (**MEMO BUTTON**) one more time.

6. Select “**P4 Backing line 4**” and then press **OK** (**MEMO BUTTON**).

7. After adjusting the tension, turn the JOG Power Lever to the MAX position and then wind the main line.

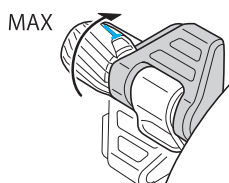

*While winding up the line, try to adjust the tension so that the mark ▼ stays around the screen center.

5

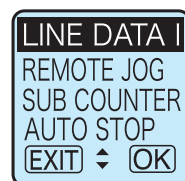

(Menu Screen)

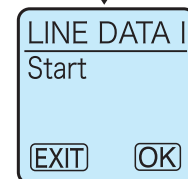

6

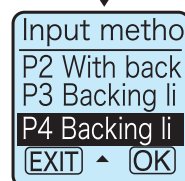

(Line input Screen)

7

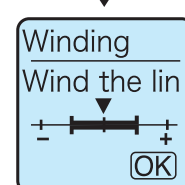

(Tension Meter Screen)



Attention

- The reel may be damaged if the line touches the finger-guard or the frame. Keep the line from touching these components.
- Winding the line indoors for a prolonged period at a low speed with an elevated tension may cause the motor to overheat and thus fail. When winding the line, turn the JOG Power Lever to the MAX position. When actually fishing outdoors, there is no need to worry because it is cooled with seawater, etc.
- This line mounting method cannot be used for fine lines of less than PE #2.
- When winding PE #2, winding the line near to the spool outer diameter may cause the PE line to get pinched between the spool and frame. So, it is recommended to wind the line approximately 1 mm less than the spool outer diameter.

Functional setting [2. Main line input]

P4 Line re-input

8. When winding is completed, turn the JOG Power Lever back to the OFF position and then press **OK** (**MEMO** **BUTTON**).

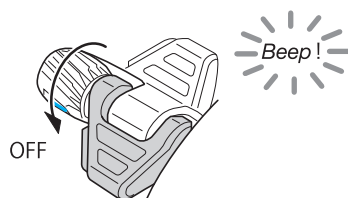

9. Pull 10 m of the line out of the reel as checking the line color and press **OK** (**MEMO** **BUTTON**).

10. When “Complete” is displayed on the screen, press **OK** (**MEMO** **BUTTON**) to return to the Water Depth screen. Wind up the line that you pulled out from the reel. If you wound it up, the procedure is completed.

*If “Error” appears on the screen while inputting the line data, press **OK** (**MEMO** **BUTTON**) to return to the Water Depth screen and re-start the process from the beginning.

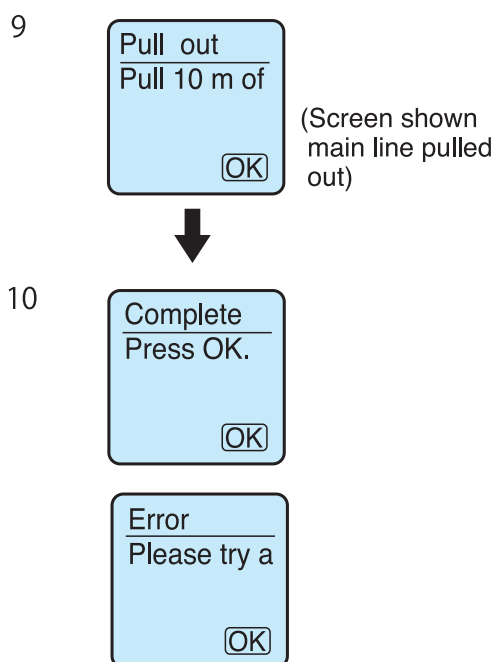

Functional setting 「3. REMOTE JOG Connection」 [Sold separately]

By connecting an electric reel to the REMOTE JOG, you are able to know the water depth at a distance from the reel and reel operation is enabled.

※This is available only for JPN models.

REMOTE JOG Connection method

When connecting both the REEL and REMOTE JOG for the first time, please refer to the Remote Jog Manual (REMOTE JOG Manual: Connection Pattern 1)

*Refer to the REMOTE JOG Manual also for other connection methods.

----- [REEL] -----

----- [REMOTE JOG] -----

*Note: No operation is required for , while ——— requires operation.

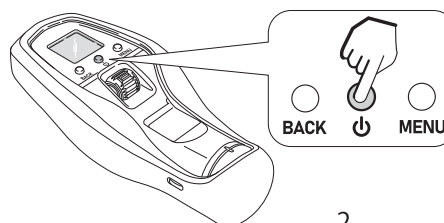
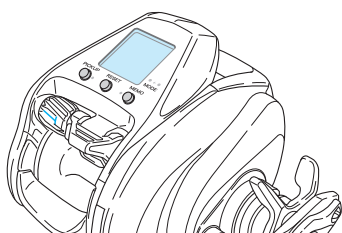

1. Firstly, energize the reel.

*Press **MEMO** **BUTTON** and **PICKUP** **BUTTON** simultaneously for 2 seconds to display the menu screen.

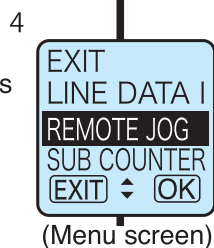
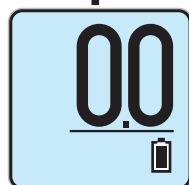
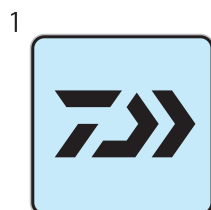
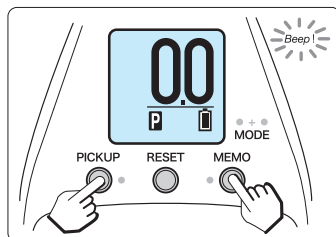

(Menu screen)

Press OK

2. Press **POWER** **BUTTON** for 5 seconds to activate the remote jog.

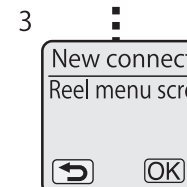
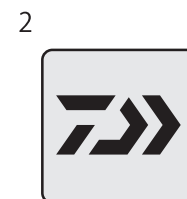

Press OK

4. Select "**REMOTE JOG**" from the screen and press **OK** (**MEMO** **BUTTON**).

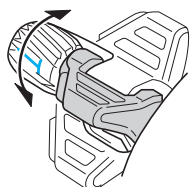

3. When the New Connection screen appears, press the **OK** (**MENU** **BUTTON**).

Functional setting 「3. REMOTE JOG Connection」 [Sold separately]

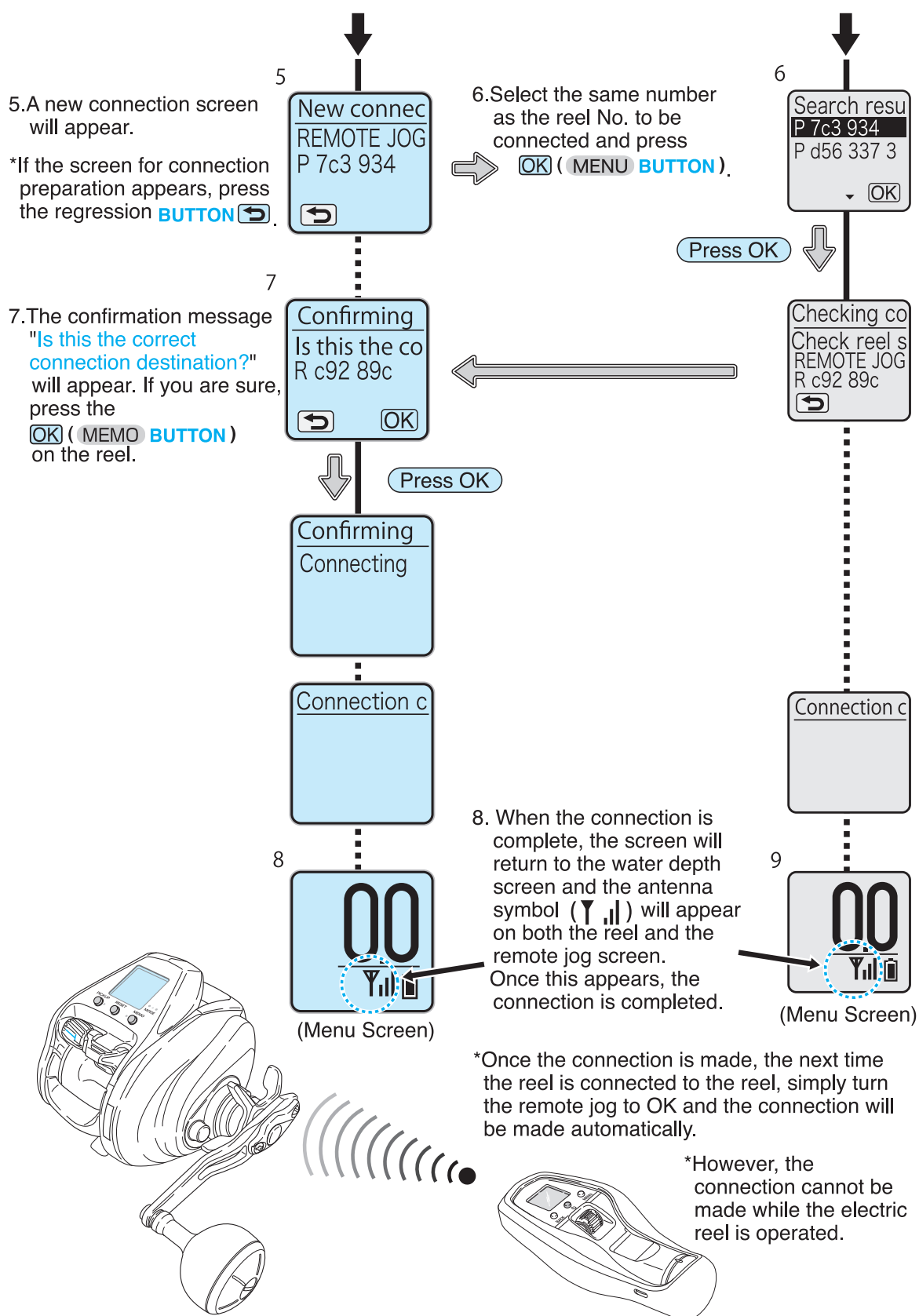

Functional setting [4. Sub counter]

Sub counter can be displayed below the Water Depth counter. You can select one from 3 options; i.e. “Inverse counter”, “Winding speed” and “Remaining time to auto stop”

*Sub counter is set to “No display” by default.

Inverse counter

You can easily identify a shelf in the strike zone for fishing with the distances from the boat and from the bottom by two counters.

1. Press and hold both **MEMO** **BUTTON** and **PICKUP** **BUTTON** simultaneously for 2 seconds to go to the Menu screen.
2. Select the option “**SUB COUNTER**” with the JOG Power Lever and press **OK** (**MEMO** **BUTTON**). Then, select “**Inverse counter**” and press **OK** (**MEMO** **BUTTON**).

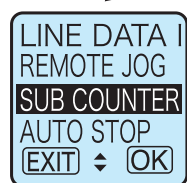
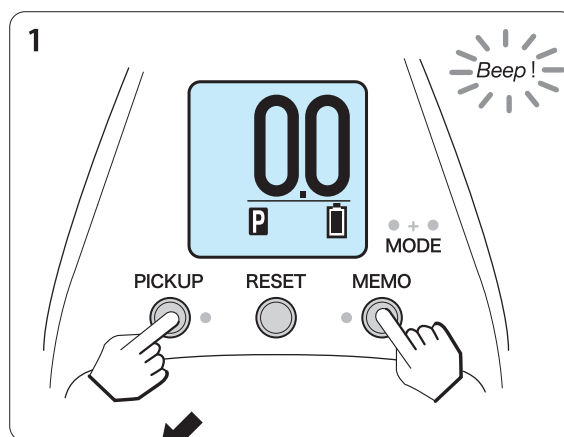
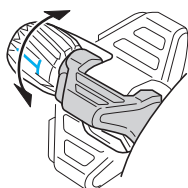

(Menu screen)

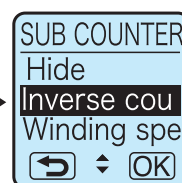

(Sub counter)

3. The Inverse counter will appear below the Water Depth counter.
4. When you press the **MEMO** **BUTTON** at the depth in the strike zone for fishing after lowering the terminal rig, including the bottom and your aiming shelf, the Inverse counter displays **0** as the reference point for showing the distance from such point.



Functional setting [4. Sub counter]

Winding speed

This option displays the winding speed actually measured while the electrical winding up is in action.

1. Press and hold both **MEMO** **BUTTON** and **PICKUP** **BUTTON** simultaneously for 2 seconds to go to the Menu screen.
2. Select the option "SUB COUNTER" with the JOG Power Lever and press **OK** (**MEMO** **BUTTON**). Then, select "Winding speed" and press **OK** (**MEMO** **BUTTON**).

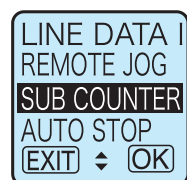
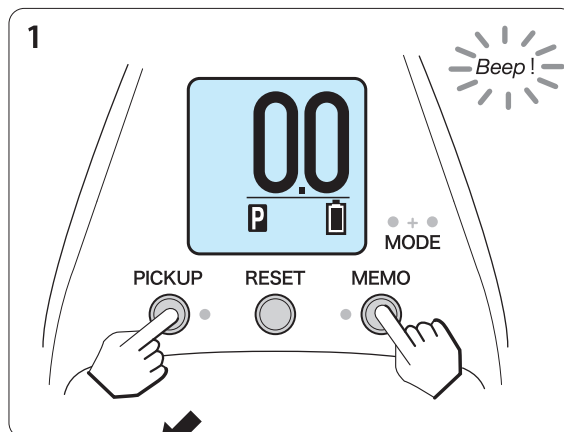
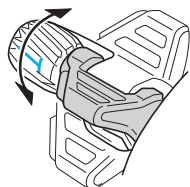

(Menu screen)

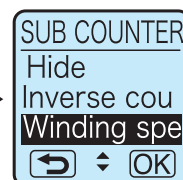

(Sub counter)

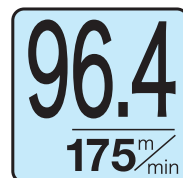

(Example of display)

3. The winding speed will be displayed below the Water Depth counter.

*This is displayed only while electrical winding up is in action.

Functional setting [4. Sub counter]

Time to wind up

This option displays the timer roughly indicating the remaining time to auto stop at the boat side.

*A gap in the time may be caused by the fluctuation of the actual winding speed.

1. Press and hold both **MEMO** **BUTTON** and **PICKUP** **BUTTON** simultaneously for 2 seconds to go to the Menu screen.
2. Select the option “**SUB COUNTER**” with the JOG Power Lever and press **OK** (**MEMO** **BUTTON**).
Then, select “**Remaining time to auto stop**” and press **OK** (**MEMO** **BUTTON**).

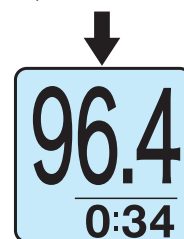
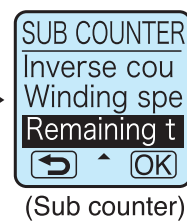
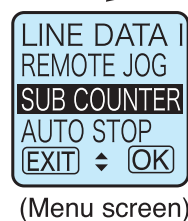
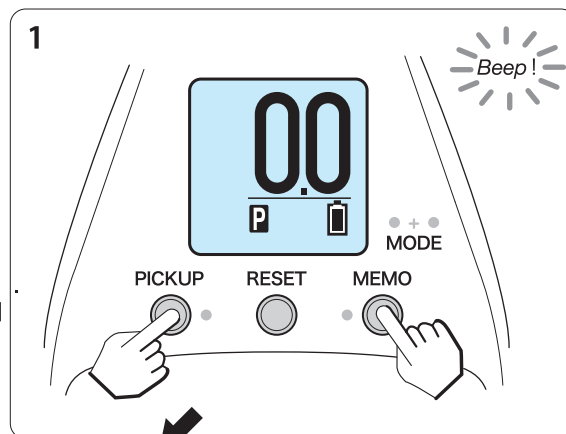
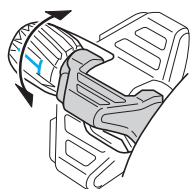

(Example of display)

3. The time to wind up will be displayed below the Water Depth counter.

*This is displayed only while electrical winding up is in action.

Functional setting [5. Before start fishing]

Water surface zero setting

Before you start fishing, always perform this zero setting to identify a more accurate depth of the strike zone for fishing.

1. Connect the reel to the battery. Pass the line through all the guides, and prepare your terminal rig.
2. Lower the terminal rig to the water surface and press the **RESET BUTTON**.

Setting is completed when the display shows **0.0**.

While electrical winding up is in action, winding will automatically stop at 2 m before auto stop at the boat side.

*If this Water surface zero setting is not made, winding will automatically stop at 5 m before the auto stop point for safety.

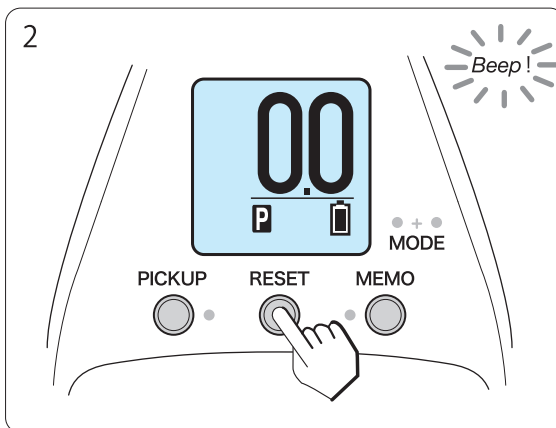
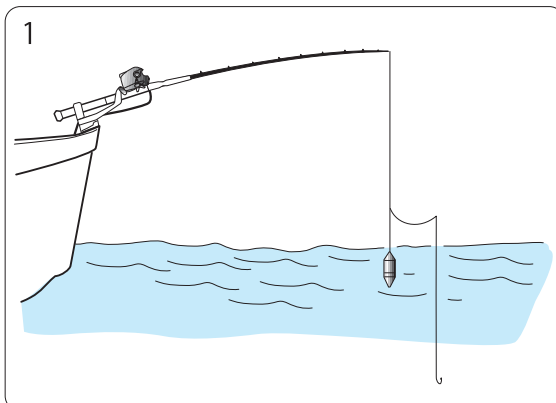

Attention

- Auto stop position may vary depending on the line winding up tension. The position may shift when you wind up the line with strong force, however, please do not make zero-set in such case.
- Depending upon the rolling of the boat or sinker weight, auto stop point can overrun slightly. Should this happen, increase the depth of the auto stop.
- Fishing at a depth over 100 m with a load largely fluctuating may cause a gap in the stop point. Thus, the terminal rig may be accidentally wound up and the rod may be broken. In such fishing, it is recommended to have sufficient margin in setting of auto stop point to avoid such events.

If the main line is broken

-Should your line break, revise data as follows.

Revise the data of the broken line. Wind the line to the rod tip while the reel is powered on. Then, press the **RESET BUTTON** for 2 seconds or more. When the display shows **0.0**, then your re-adjustment is completed.

*The line data will be overwritten (revised) by the procedure described above.

*Do not press and hold the **RESET BUTTON**, except for data correction of a broken line; it may cause an error in the counter.

Functional setting [6. Auto stop]

Adjustable stop setting

The auto stop point can be set to meet your own specific needs and ease your preparatory works such as checking and changing of baits and sinkers.

- You can set the auto stop point by setting the adjustable depth within the range 1 m to 5 m from the point where you press **RESET BUTTON** (in 10 cm increments). Especially in case of chumming, it is recommended to set the adjustable auto stop point so that a chumming bait sinker comes to your hand side when you raise your rod tip, for more convenient checking and changing of baits and sinkers.
- Note that it is designed not to allow you to set the auto stop point to any value below 2 m for safety reasons.
- Note that the JOG Power Lever may not be allowed to manipulate around the auto stop point for safety reasons.

There are two different ways to set the adjustable auto stop; setting in the Menu screen and setting in the Water Depth screen.

● Setting in the Menu screen

1. Press and hold both **MEMO BUTTON** and **PICKUP BUTTON** simultaneously for 2 seconds to go to the Menu screen.
2. Select "AUTO STOP" with the JOG Power Lever and press **OK** (**MEMO BUTTON**).
3. Then, select your desired auto stop point with the JOG Power Lever and press **OK** (**MEMO BUTTON**) to return to the Water Depth screen.

- *You are not allowed to set the adjustable auto stop if you have not yet set the water surface zero setting. Be sure to carry out the water surface zero setting.
- 4. If you carry out electrical winding up after lowering the terminal rig, your terminal rig will automatically stop at the pre-set point.

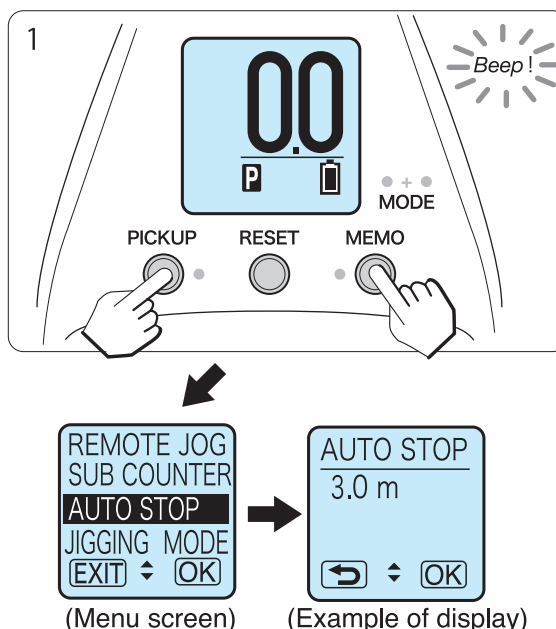

● Auto stop setting

- Depends on the conditions, the line may be stretched due to the depth of water or tension charged and such makes the indication of depth and stop position deviate from the actual one. Especially in the case of deep-sea fishing, the number of hooked fish, tidal resistance, and other factors cause the tension of the line to fluctuate with each cast of the hook. This tends to increase the error in position. Please set the depth of Auto stop position as large as possible and please be very careful to avoid rolling in troubles. If the reset button is pressed after the stop position has been shifted, it may cause such roll in trouble at the next fishing gear retrieval. For this reason, please do not reset the setting, keep as it is and continue to throw in the next piece of fishing gear.

Functional setting [6. Auto stop]

● Setting in the Water Depth screen

1. While the reel is powered on and your terminal rig is on the water surface, press the **RESET BUTTON** (water surface zero setting).

The display will show **0**.

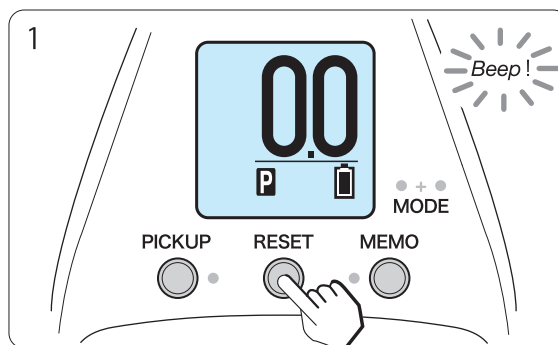

2. Raise your rod tip and pull the line out adjusting the line length from the rod tip so that you can reach the rig easily.

In the figure, its length is 1.5 m.

Use

Chumming

It is recommended to set the auto stop so that a chumming bait sinker comes to your hand side when you raise your rod tip, for more convenience for checking and changing of baits and sinkers.

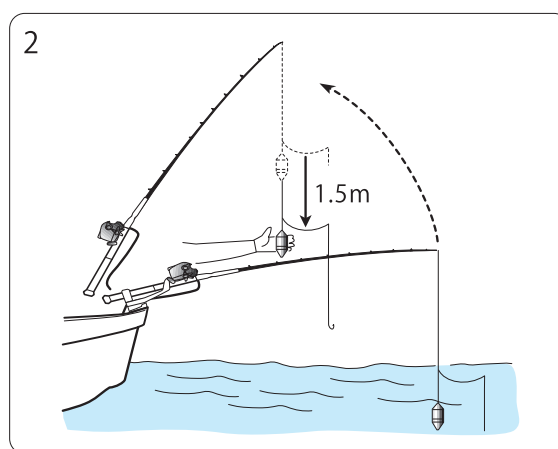

3. When the line length has been properly adjusted, press and hold the **MEMO BUTTON** for about 2 seconds.

*Auto stop is set to 2 m by default.
(If **RESET BUTTON** is not pressed, the reel stops at 5m)

4. The electrical winding up automatically stops at the pre-set point. So, raise the rod tip to bring your terminal rig to your hand side.

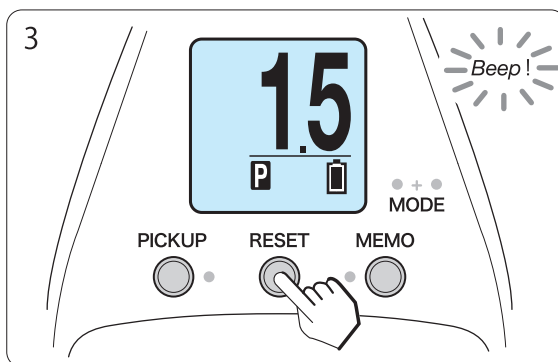

Functional setting [7. Line feeding function]

Line feeding function

Motor gear reverses to allow the spool to rotate in the direction of the line going out that assists line feeding.

Line Feeding

1. Press and hold both **MEMO** **BUTTON** and **PICKUP** **BUTTON** simultaneously for 2 seconds to display the MENU screen.
2. Select "Line Feeding" with the Jog Power lever and press **OK** (**MEMO** **BUTTON**). Then, select "ON" with the Jog Power Lever and press **OK** (**MEMO** **BUTTON**) to complete the setting.

2

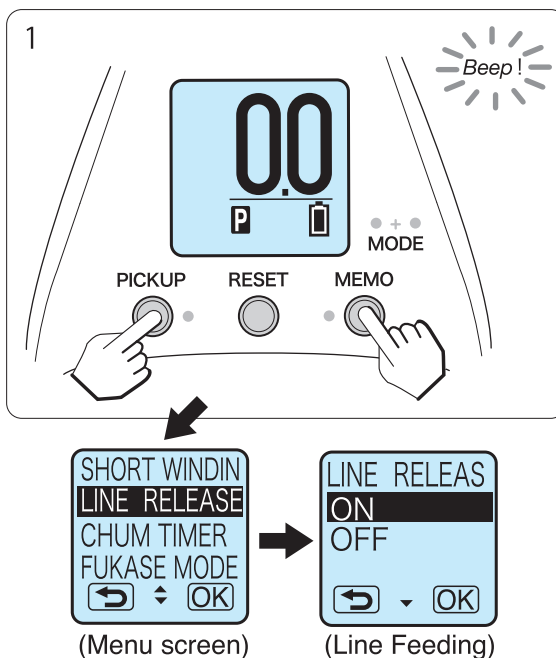
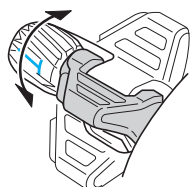

- When you turn the Clutch to OFF and throw your terminal rig into the water, the line feeding function will be activated from the preset auto stop depth plus 2.5 m.
- The line feeding output will be automatically adjusted according to the speed of the spool rotation with the terminal rig dropping.
- If the Jog Power Lever moved while feeding the line, the line feeding will be stopped.
- Once the line feeding is stopped for more than a certain time due to backlash etc., it will not restart.

Attention

- If you turn the Clutch to ON during the line feeding (motor in operation), the line may get wound.
- If you throw your terminal rig into the water with the Line Feeding set to ON in the condition where the boat intensely moves up and down or the wind is strong, backlash easily occurs, which may interfere the smooth dropping of your terminal rig.
- If you set the Line Feeding to ON while the Drift mode is set to ON, the Drift mode will be automatically turned to OFF.
- When you turn the line feed setting ON, the Motor ON/OFF Interlocking Clutch becomes turned OFF.
- When Line Feeding is turned ON and the Jog Power Lever is pushed down while the clutch is OFF, the motor starts driving and allows you to adjust degree of line feeding. However, sudden turning ON of the clutch while the Jog Power Lever is at high rotation speed (20 or above) mode, it may damage the clutch. If you adjust the Jog Power Lever by yourself, please turn the clutch ON while the Jog Power Lever is set lower than 20.

Functional setting [8. Pickup / Pause]

Pickup

This is very useful. You can wind the line by the electric reel only while pressing the **PICKUP BUTTON**. The pickup speed is set to 15 by default. You can change it in the Menu screen.

Pause

This is very useful. You can pause the electrical winding up only while pressing the **PICKUP BUTTON**. When you release the button, the reel restarts winding up at the speed specified by using the JOG Power Lever.

Pickup / Pause setting

1. Press and hold both **MEMO BUTTON** and **PICKUP BUTTON** simultaneously for 2 seconds to go to the Menu screen.
2. Select "PICKUP/JIGGING" with the JOG Power Lever and press **OK** (**MEMO BUTTON**). Then, select "Pickup" from the PICKUP/JIGGING options and press **OK** (**MEMO BUTTON**).

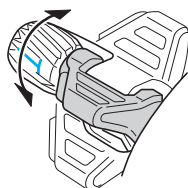

3. Set the speed with the JOG Power Lever.

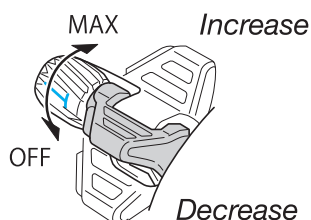

The setting range is from 1 to Hi.
(The figure shows the setting at 20 for a quick wind.)

If you select "Quick Stop" in *2, the setting in 3.4 is not applied, and returns to the water depth screen.

4. Press **OK** (**MEMO BUTTON**) to return to the Water Depth screen. Now, the setting is completed.

*The reel cannot be wound within the distance of Boat Stop Position + 3 meters for safety reasons.

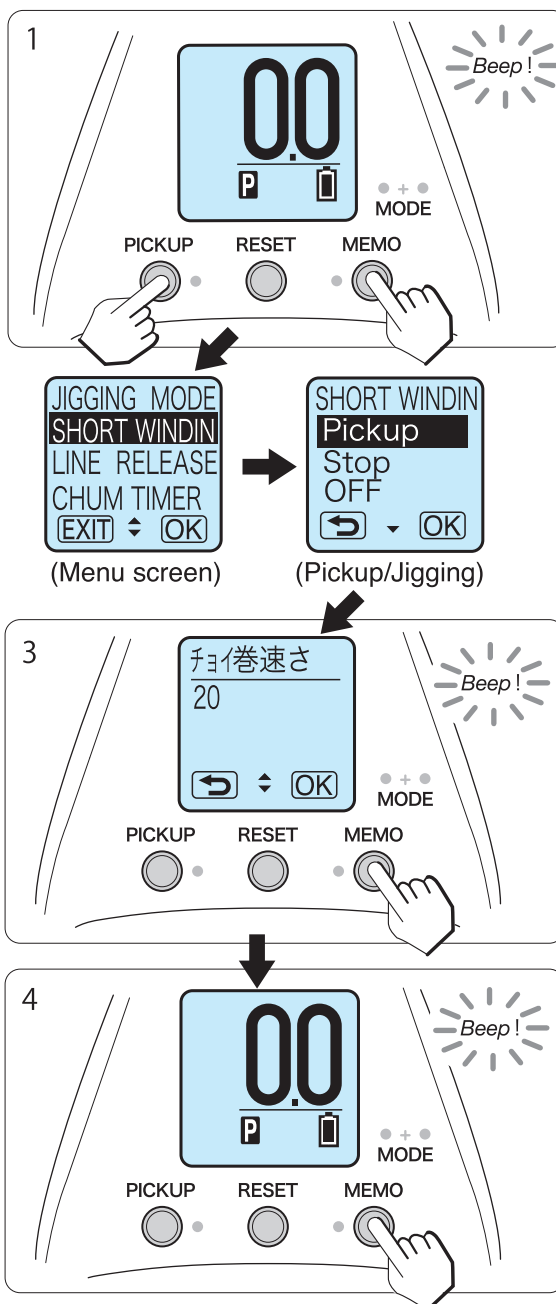

Functional setting [9.JIGGING MODE]

JIGGING MODE

This is a useful function to allow the electric reel to start a lure action (luring fish). Once you set this mode, you can start the Jigging mode by pressing **PICKUP BUTTON**. The setting can be changed in detail to meet the needs of anglers.

How to set JIGGING MODE

1. Press and hold both **MEMO BUTTON** and **PICKUP BUTTON** simultaneously for 2 seconds to go to the Menu screen.

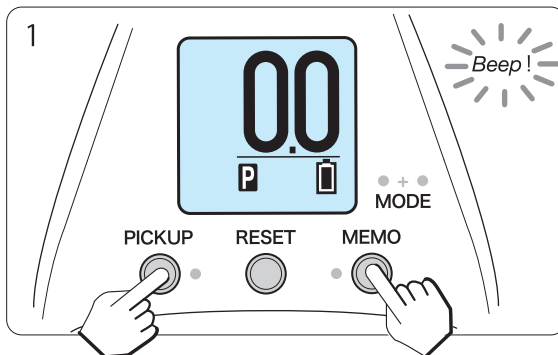

2. Select "JIGGING MODE" with the Jog Power Lever and press **OK** (**MEMO BUTTON**).

2

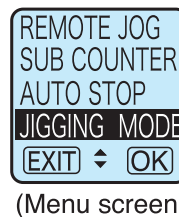
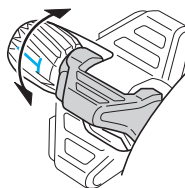

3. Select one of options of "Sequential jerk", "Sequential jerk + pause", "Combination jerk" or "OFF", with the Power Lever and press **OK** (**MEMO BUTTON**).

3

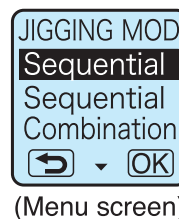
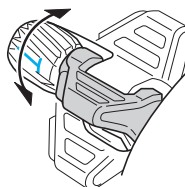

*The default is set to OFF.

4. Select one of options of "Standard mode" or "Custom" and press **OK** (**MEMO BUTTON**).

4

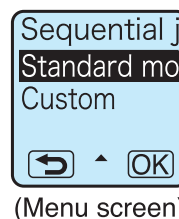
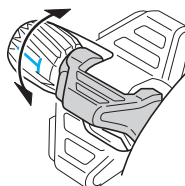

*Standard mode: Basic operation in each of Jigging mode.

*Custom: You can combine your desired Jerk Pattern for setting. (as described later)

Functional setting [9.JIGGING MODE]

How to operate during actual fishing after setting the JIGGING MODE

1.Ensure that the indicator **J** is displayed on the counter.

2.Turn OFF the clutch to drop your jig.

3.Press **PICKUP** **BUTTON** when feeding out your line 9.1 m or more. Or, press **PICKUP** **BUTTON** when your jig reaches to the bottom.

4.The indicator **J** on the counter starts blinking.

5.Turn ON the clutch to start Jigging mode.

6.Jigging mode stops when the line is wound up to the Jerk Range. Then, turn OFF the clutch and lower the jig again.

7.If you repeat the Jigging mode, press **PICKUP** **BUTTON** again.

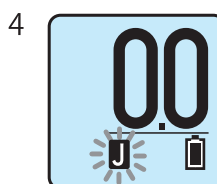
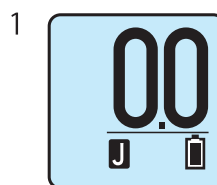

Notes on JIGGING MODE

- 1.Jigging mode works up to the Auto Stop point.
 - 2.When the clutch is turned OFF in the middle of the Jerk Range, the winding stops with the indicator J blinking continuously. When the clutch is turned ON again, Jigging mode restarts. But, if the winding is started from the point of the counter indication as 9.0 m or less, the indicator J does not blink and this mode is paused even when the clutch is turned OFF.
 - 3.From the point of the counter indication as 9.0 m or less to the Auto Stop point, the wind-up speed will be less than [20].
 - 4.Simultaneous setting of Jigging mode and PICKUP/PAUSE setting is not allowed. The mode you set later will be given priority.
- J (Jigging mode), PIC (Pickup), or NO-PIC (Pause) will be displayed on the counter.

Functional setting [9.JIGGING MODE]

How to set Custom parameters for each JIGGING MODE

■ Sequential jerk

You can set "Jerk Length", "Jerk Speed", "Jerk Interval (winding stop time)", and "Jerk Range".

* Each figure shown below shows the standard setting (default setting).

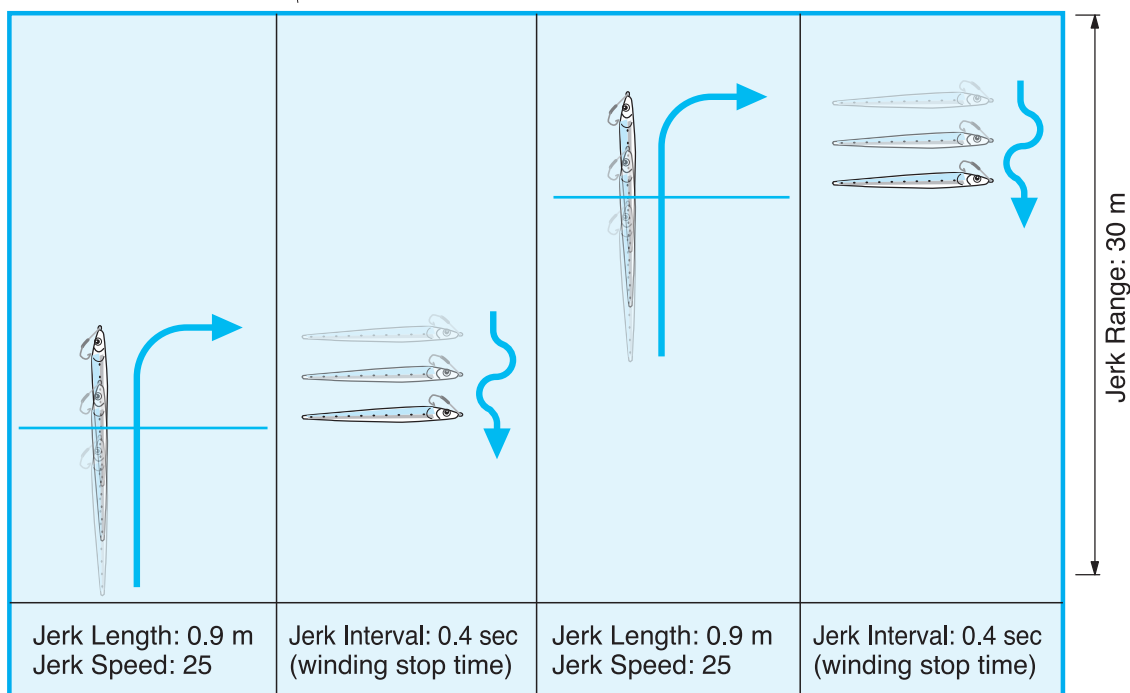
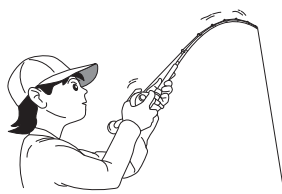

The setting screens appear subsequently as shown below.

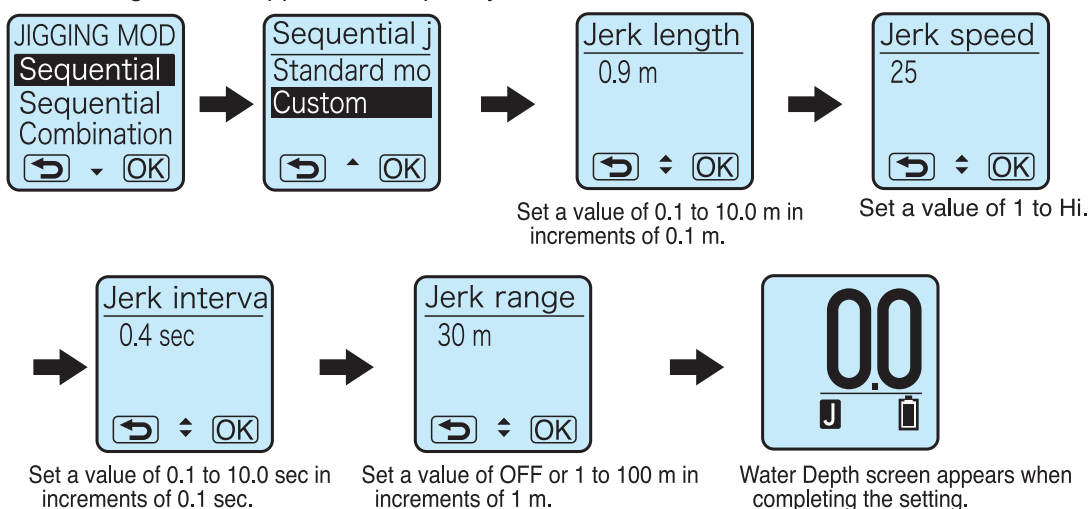

Functional setting [9.JIGGING MODE]

■ Sequential jerk+pause

Each setting of "Jerk Pattern (setting of number of steps)", "Jerk Length", "Jerk Speed", "Jerk Interval (winding stop time)", and "Jerk Range".

* Each figure shown below shows the standard setting (default setting).

* The setting of conventional "Jigging" is the same as this mode.

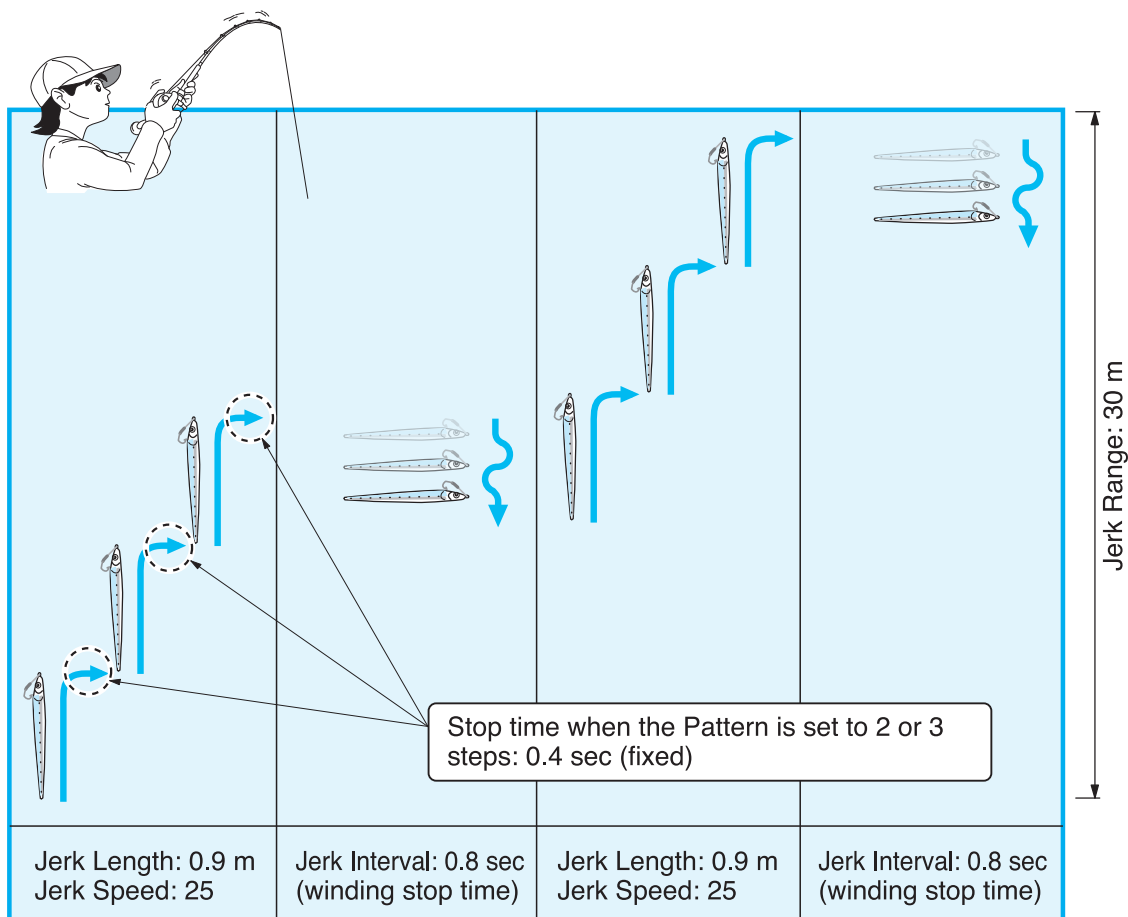

The setting screens appear subsequently as shown below.

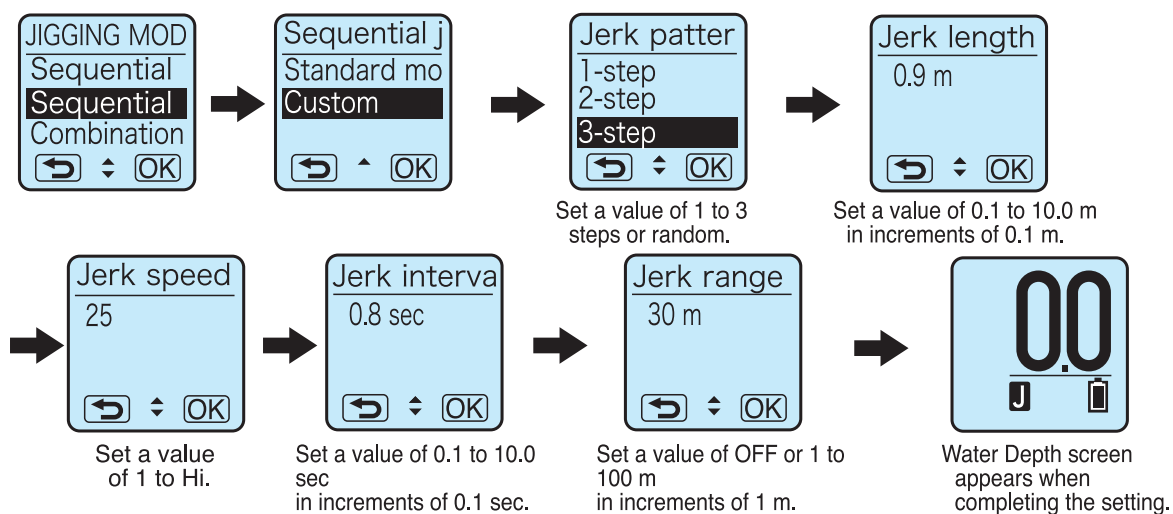

Functional setting [9.JIGGING MODE]

■ Combination jerk

You can set "Retrieve Length", "Retrieve Speed", "Jerk Length", "Jerk Speed", "Jerk Interval (winding stop time)", "Number of Jerks" and "Jerk Range".
* Each figure shown below shows the standard setting (default setting).

Retrieve Length : 10 m Retrieve Speed : HI	Jerk Length: 0.9 m Jerk Speed: 25 Jerk Interval: 0.4 sec Number of Jerks: 5 jerks	Retrieve Length : 10 m Retrieve Speed : HI	Jerk Length: 0.9 m Jerk Speed: 25 Jerk Interval: 0.4 sec Number of Jerks: 5 jerks

The setting screens appear subsequently as shown below.

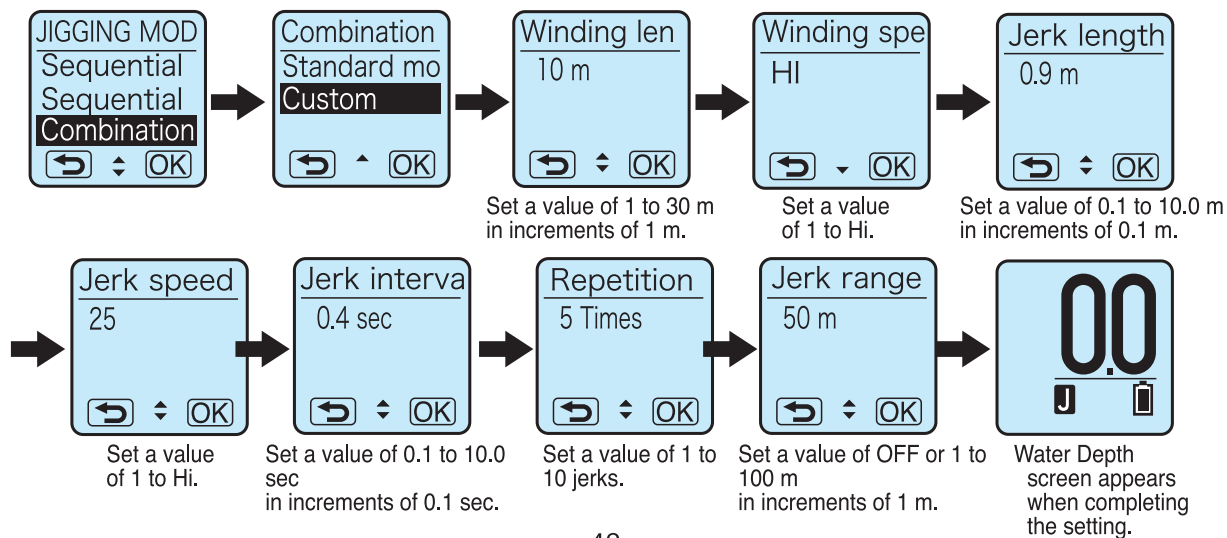

Functional setting [10. Motor ON/OFF Interlocking Clutch]

The motor rotation stops when the clutch is turned OFF during electric winding (while the motor is rotating). The electric winding (motor rotation) automatically restarts when the clutch is turned ON again.

*The default setting is made as shown below.

How to operate Motor ON/OFF Interlocking Clutch

1) Operation while the clutch is turned OFF (motor is stopped)

You can set the wind-up speed (1 to Hi) with the JOG Power Lever while the water depth is 9.1 m or more.

*The value shown at the left bottom of the counter screen blinks.

When the clutch is turned ON, electric winding is started at the set wind-up speed (motor rotation).

2) Operation while the clutch is OFF (motor rotation)

You can set the wind-up speed (1 to Hi) with the JOG Power Lever while the water depth is 9.1 m or more.

* The value shown at the left bottom of the counter screen blinks.

* Electric wind-up is performed at the set wind-up speed (motor rotation).

When the clutch is turned OFF, electric winding stops (motor stop).

You can alternately and repeatedly turn the clutch ON (motor rotation) or OFF (motor stop).



WARNING <Warning for your use of the product>

•Your fingers may be pinched or rolled in while the clutch is turned ON. Immediately turn OFF the Lever to stop the operation.



CAUTION <Caution for your use of the product>

**Do not turn the clutch ON while the line is tangled around the rod tip. Otherwise, the rod tip may be broken.*

**Do not turn the clutch ON while the line is backlashed. Otherwise your reel may be broken.*



CAUTION <Caution for your operation>

**When the line is wound up to the point of water depth less than 9.0 m while repeating the winding, the wind-up speed will be reset.*

In such case, set it again.

-The set winding speed is disabled in jigging mode and during quick winding operation.

-Motor ON/OFF Interlocking Clutch function is disabled when line feeding is turned ON.

Functional setting [11. Electronic Drag Sound]

This is a function to alert you by electronic beep when the drag is pulled out. You can select one from three types of alarm sounds and OFF. It is set to "Pattern 1" (High-tone) by default.

Options for Electronic Drag Sound

Pattern 1: High-tone
Pattern 2: Middle tone
Pattern 3: Low-tone
OFF: No alarm beeping

How to set Electronic Drag Sound

1. Press and hold both **MEMO** **BUTTON** and **PICKUP** **BUTTON** simultaneously for 2 seconds to go to the Menu screen.

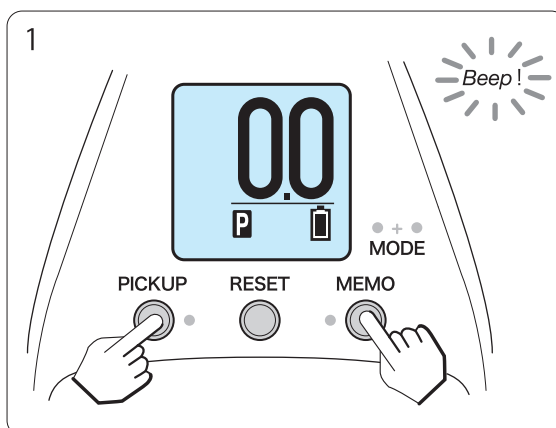

(Water Depth Screen)

2. Select "DRAG SOUND" with the JOG Power Lever and press **OK** (**MEMO** **BUTTON**).

2

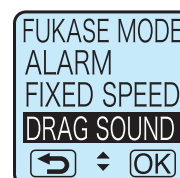
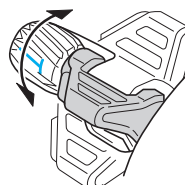

(Menu screen)

3. Select one of options for "DRAG SOUND" and press **OK** (**MEMO** **BUTTON**).

3

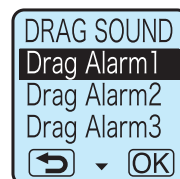
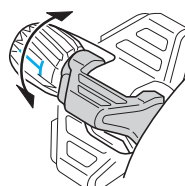

(Menu screen)

*It is set to "Drag Alarm1" by default.

Functional setting [12. Depth Alarm]

This is a function to inform you the water depth counted every 10 m by alarm beeping. You can select the alarm setting for both Fall (FL) and Wind-up (UP).

* It is set to “FL 1” and “UP 1” by default.

Options for Alarm Sound

You can select one of four options for Alarm Sound including alarm beep OFF.

(1)FL/UP 0: Alarm beep OFF

(2)FL/UP 1: One beep repeated every 10 m of water depth

(3)FL/UP 3: One to three beeps repeated every 10 m of water depth

(4)FL/UP 5: One to five beeps repeated every 10 m of water depth

The options (1) to (4) can be set for each of Fall and Wind-up to ON or OFF.

How to set Depth Alarm

1. Press and hold both **MEMO** **BUTTON** and **PICKUP** **BUTTON** simultaneously for 2 seconds to go to the Menu screen.

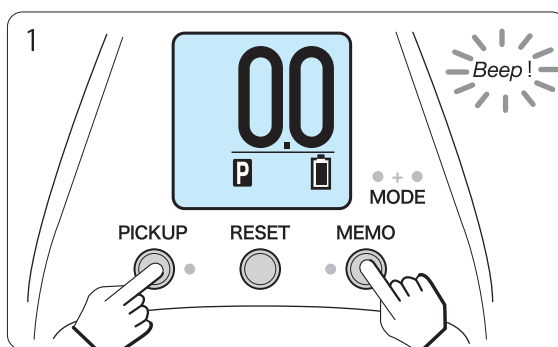

(Water Depth Screen)

2. Select “**DEPTH ALARM**” with the JOG Power Lever and press **OK** (**MEMO** **BUTTON**).

2

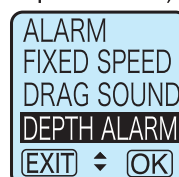
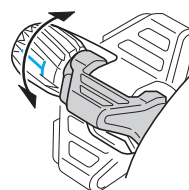

(Menu screen)

3. Select “**ON**” under “**DEPTH ALARM**” with the JOG Power Lever and press **OK** (**MEMO** **BUTTON**).

3

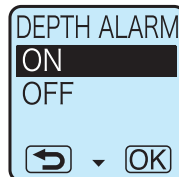
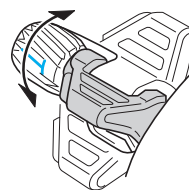

(Menu screen)

4. Select one of options for “**Depth Alarm (falling)**” and press **OK** (**MEMO** **BUTTON**).

4

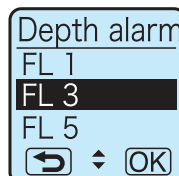
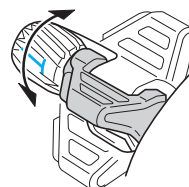

(Menu screen)

5. Select one of options for “**Depth alarm (winding)**” and press **OK** (**MEMO** **BUTTON**).

5

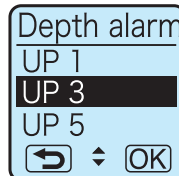
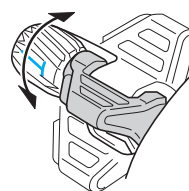

(Menu screen)

*When FUKASE mode is ON, the depth alarm will not sound even if it is set.

Functional setting [13. Timer]

Timer

The display shows precisely the time having elapsed every since the rig was dropped. It is very helpful to determine the pace for checking and changing of baits and sinkers.

- The elapsed time from the start of throwing terminal rig is displayed. This is used as a reference to determine the timing for retrieving the terminal rig.
- When the **MEMO BUTTON** is not pressed, the timer automatically starts when the depth counter determined the depth 7.0 m.

*The time is indicated in seconds if the remaining time is less than 60 seconds It is indicated in minutes if the remaining time is not less than 1 minute.

*The timer function may not be reset.

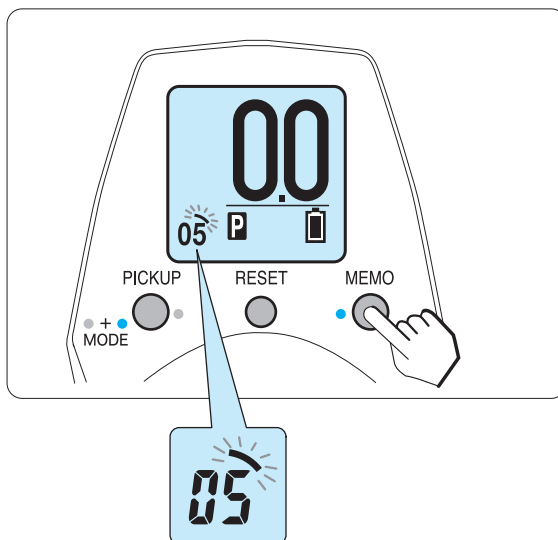

Attention

If you press the **MEMO BUTTON** while chumming is in process, the timer indication will start from **0.0** .

Functional setting [14. Timer winding]

Timer Winding

Professional fishing techniques of checking and changing of baits and sinkers for all levels including beginners! Once you have set the waiting time simply, the reel automatically starts winding up. You can enjoy fishing more effectively and easily.

-If you have set the waiting time for a single chumming to 5 minutes, the reel will automatically start winding up at a high speed to allow you to check and change baits and sinkers after preset 5 minutes have passed.

1. Press and hold both **MEMO BUTTON** and **PICKUP BUTTON** simultaneously for 2 seconds to go to the Menu screen.
2. Select the "**CHUM TIMER**" with the JOG Power Lever and press **OK** (**MEMO BUTTON**) .

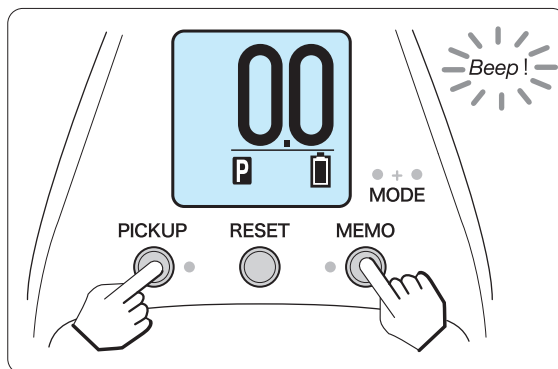
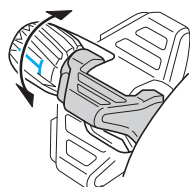

3. Select the waiting time (in minute) for checking and changing of baits and sinkers with the JOG Power Lever.

Turn the Power Lever upward to increase the value. Or, turn it downward to decrease the value. (In the figure, the waiting time is set to 5 minutes)

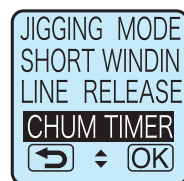

(Menu screen)

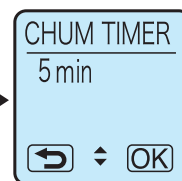

(Example of display)

4. Press **OK** (**MEMO BUTTON**) . If the screen returns to the "**Water Depth screen**", then the setting is completed.

When timer winding is started, **T** (timer) lights up on the screen.

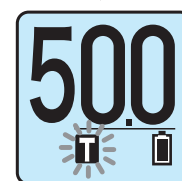

5. The reel will automatically starts winding up the rig at its maximum speed when the preset time has elapsed while the clutch is powered on after lowering the terminal rig.

-An audible alarm will sound before the reel starts winding.

-If the clutch is powered OFF, the reel will not start automatic winding up.

-The chumming timer automatically starts when the depth counter determined the depth 7 m. But, you can reset the timer once and restart it by pressing **MEMO BUTTON** .

*The winding speed cannot be adjusted.

-When you make Timer-winding ON at FUKASE mode ON, this mode is automatically turned OFF.

Functional setting [15. Constant Speed Winding mode]

Constant Speed Winding mode

Normally, the line winding up speed may slow down as load is applied to the reel, however, when the constant speed winding mode is selected, the reel will automatically control the motor rotation when winding at the set speed regardless of the load applied to the reel.

*Operation may become unstable depending on the condition of the sea or the movement of fish. In such case, cancel this mode.

1. Press and hold both **MEMO BUTTON** and **PICKUP BUTTON** simultaneously for 2 seconds to display the MENU screen.

2. Select "**FIXED SPEED WINDING**" with the JOG Power Lever and press **OK** (**PICKUP BUTTON**).

Then, select "**ON**" with the JOG Power Lever and press **OK** (**PICKUP BUTTON**).

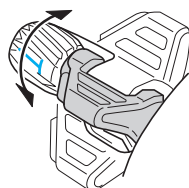
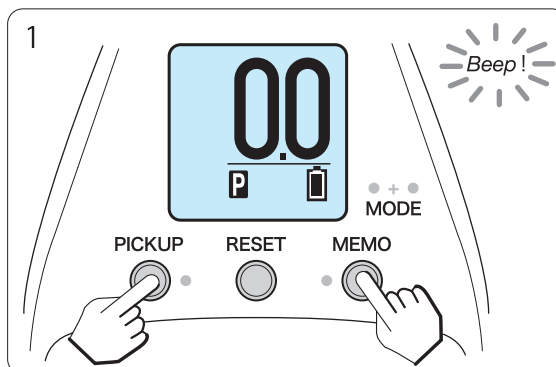

■ will appear at the lower left of the screen.

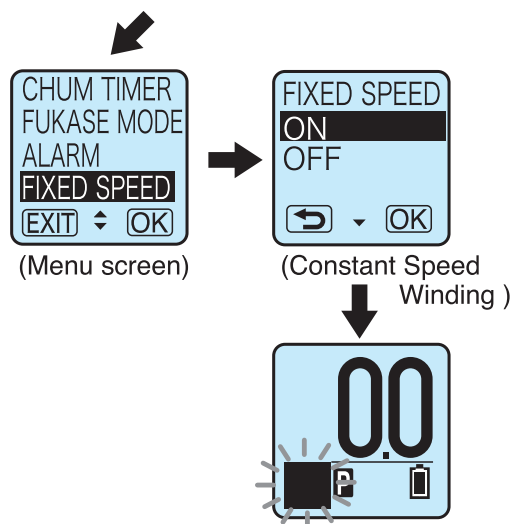

3. Operate the JOG power lever to adjust the winding up speed of the reel to the speed you desire to keep, and release your finger from the JOG power lever. Then, after a while, automatic control will start to maintain the adjusted speed.

*The operating range is 1 to 30 on the scale of the JOG Power Lever.

*While the JOG Power Lever is set to **(H)**, Constant Speed Winding is disabled.

*If the load fluctuation is very large or if drag is set to relatively loose, operating the JOG Power Lever may cause the output to suddenly become larger or smaller. It is not abnormal.

3

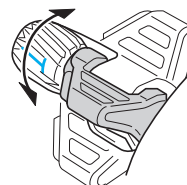

Functional setting [16. FUKASE mode]

How to use FUKASE MODE

1. Press and hold both **MEMO** **BUTTON** and **PICKUP** **BUTTON** simultaneously for 2 seconds to go to the Menu screen.

2. Select "FUKASE MODE" mode with the Jog Power Lever and press **OK** (**MEMO** **BUTTON**).

Then, select "ON" with the Jog Power Lever and press **OK** (**MEMO** **BUTTON**).

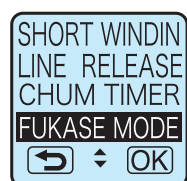
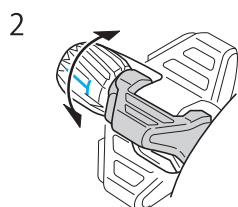
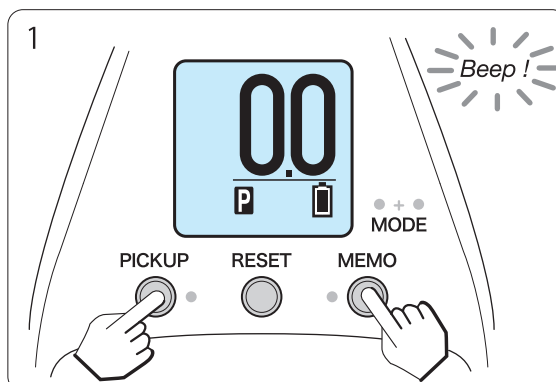

(Menu screen)

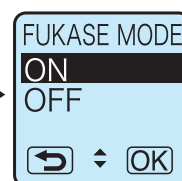

(Drift mode)

3. Select the Bite Alarm ON or OFF with the Jog Power Lever and press **OK** (**MEMO** **BUTTON**).

When the reel detects a move quicker than the preset sensitivity, the hit alarm goes off and informs you with the sound that there was a hit, allowing you to know that a fish hit it while you were not looking at it.

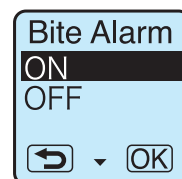

(Bite Alarm)

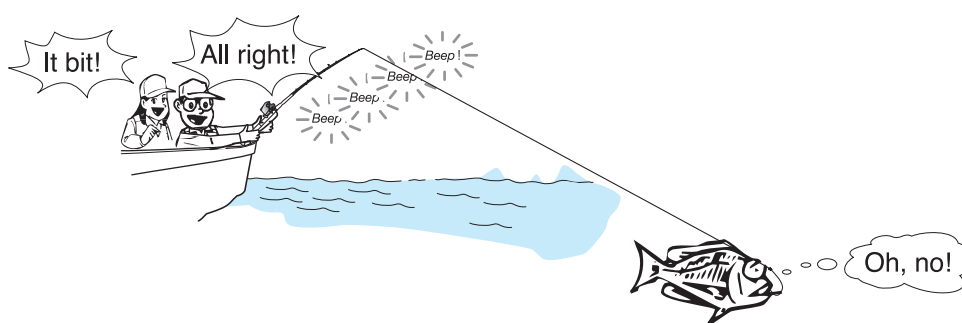

*The alarm does not go off when it is turned off.

Functional setting [16. FUKASE mode]

4. Select Bite Sensitivity with the Jog Power lever and press

OK (**MEMO** **BUTTON**).

4

Less Sensitive

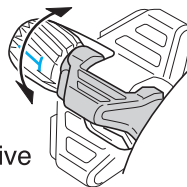

More Sensitive

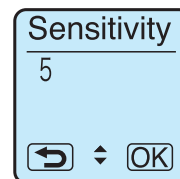

(Example of display)

- You can set the sensitivity level to detect a bite.
- Adjust the sensitivity level according to the sea condition such as tide speed and wave size.

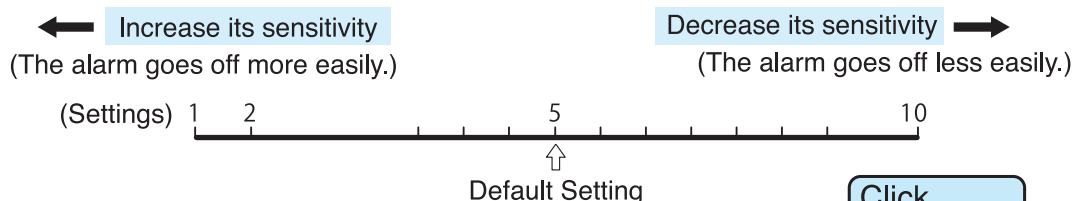

- The setting range is 1 to 10.

5. Select Drift Click ON or OFF with Jog Power Lever and press **OK** (**MEMO** **BUTTON**) to complete the setting.

5

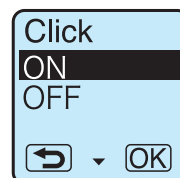
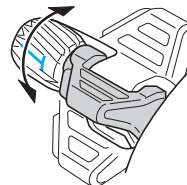

(Example of display)

- If Drift Click is set to ON, the alarm sounds every time when 1 m of the line goes out so that you can recognize the water flow (line feeding speed) by the sound.
- It starts from the water depth of 7 m.
- When the Drift mode has been set, the water depth will be automatically displayed in two vertical layers.

*When it is in the status of Drift mode ON, any setting changes of the sub-counter is not reflected to the screen, even if you change it from the menu screen.



Fishing Zone memory

- This function automatically memorize the fishing zone where the Bite Alarm sounded. Even if you make haste to operate the rod, you can confirm a fishing zone because the Inverse Counter blinks and indicates the fishing zone where the Bite Alarm sounded.

*When you press the **MEMO** **BUTTON**, the depth of the fishing zone memorized in the Fishing Zone memory is converted and displayed as **0.0**.

*When the zone is located shallower than the memorized zone, the data is not updated until the reel stops at the boat side.

*When you make FUKASE mode ON in the status of Line feed/Timer winding/Depth alarm ON, each mode is automatically turned OFF.

Blinking indication

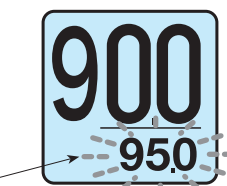

<Example of Fishing Zone memory>

(This shows that the line is temporarily wound up by 5.0 m from the depth of 95.0 m where the alarm sounds.)

Functional setting [17. Correction of designated depth]

Correction of designated depth

You can recalibrate the counter if it does not match the depth identified by the color markings on your line.

There are two types of depth correction; one is "Correction of designated depth" and the other is "10m REVISION". Here, the explanation is made on "Correction of designated depth".

Use You can recalibrate the counter while you are fishing!

(Example) To recalibrate the counter to 100 m to comply with the depth identified as just 100 m by the color of the line, though the counter shows 103 m.

1. When the water depth to be corrected is displayed, press and hold both **MEMO BUTTON** and **PICKUP BUTTON** simultaneously for 2 seconds to go to the Menu screen.
2. Select the "DEPTH REVISION" with the JOG Power Lever and press **OK** (**MEMO BUTTON**).

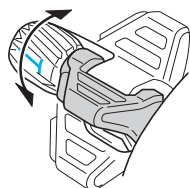

*The text «Start» is displayed. If you confirm the choice, press **OK** (**MEMO BUTTON**) again.

*Any correction cannot be made if the water depth is less than 10.0 m.

3. Select the "Correction of designated depth" with the JOG Power Lever and press **OK** (**MEMO BUTTON**).
4. Select your desired water depth with the JOG Power Lever and press **OK** (**MEMO BUTTON**) to return to the Water Depth screen.
5. Now, the water depth has been corrected.

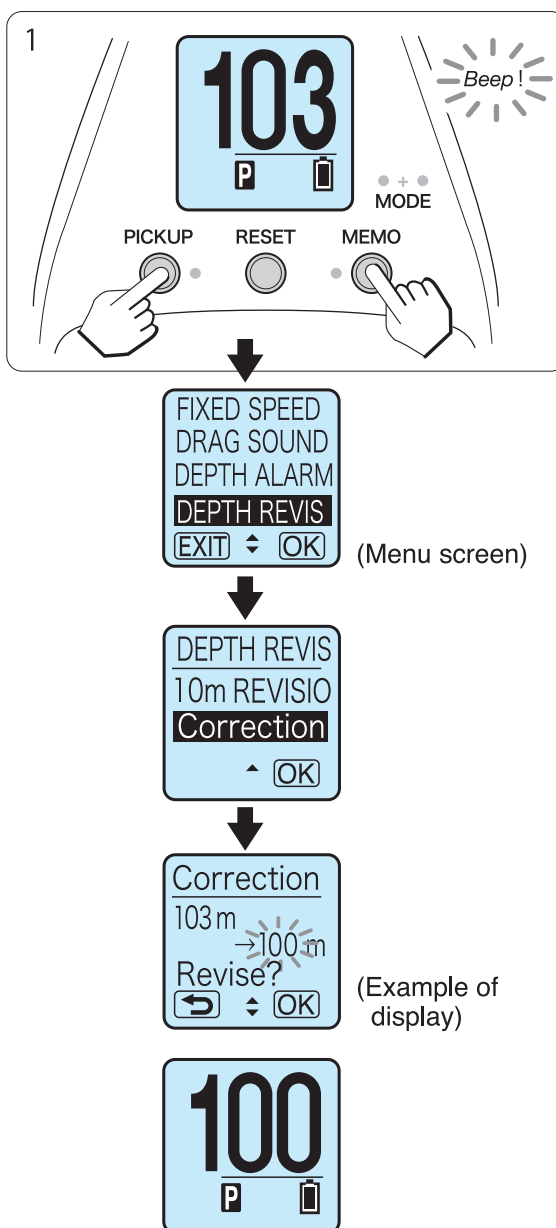

Functional setting [18.10m REVISION]

10m REVISION

You can recalibrate the counter if it does not match the depth identified by the color markings on your line. Here, explanation is made on "10m REVISION".

Use

You can recalibrate the counter while you are fishing!

- *Please ensure to execute this after winding up the reel to the boat side.
- Compensation is possible only after input is made by either way from P1 to P4.
- Compensation is not possible if the line is added after inputting.
- Compensation is not possible if the spool on the reel become extremely few after input.
- When you desire to mount the new line on the reel, use the function "main line mounting" instead of this function.

1. In the status of 0.0, press MEMO BUTTON and PICKUP BUTTON simultaneously for 2 seconds to display the menu screen.

2. Select the "DEPTH REVISION" with the JOG Power Lever and press OK (MEMO BUTTON).

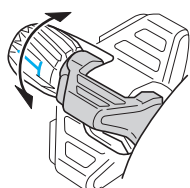

*The text «Start» is displayed. If you confirm the choice, press OK (MEMO BUTTON) again.

3. Select the "10m REVISION" with the JOG Power Lever and press OK (MEMO BUTTON).

4. Follow the instructions shown on the screen, wind the main line to the end and press OK (MEMO BUTTON).

*If the main line is already wound to the end, simply press OK.

*Compensation is not possible if the line is added after inputting

*Initial default value or the value entered by the above method only can be compensated.

5. Follow the instructions shown on the screen, pull out the line in 10 m and press OK (MEMO BUTTON).

6. The water depth has been corrected, so please wind up the line you pulled out.

*If an error occurs, start over from the beginning.

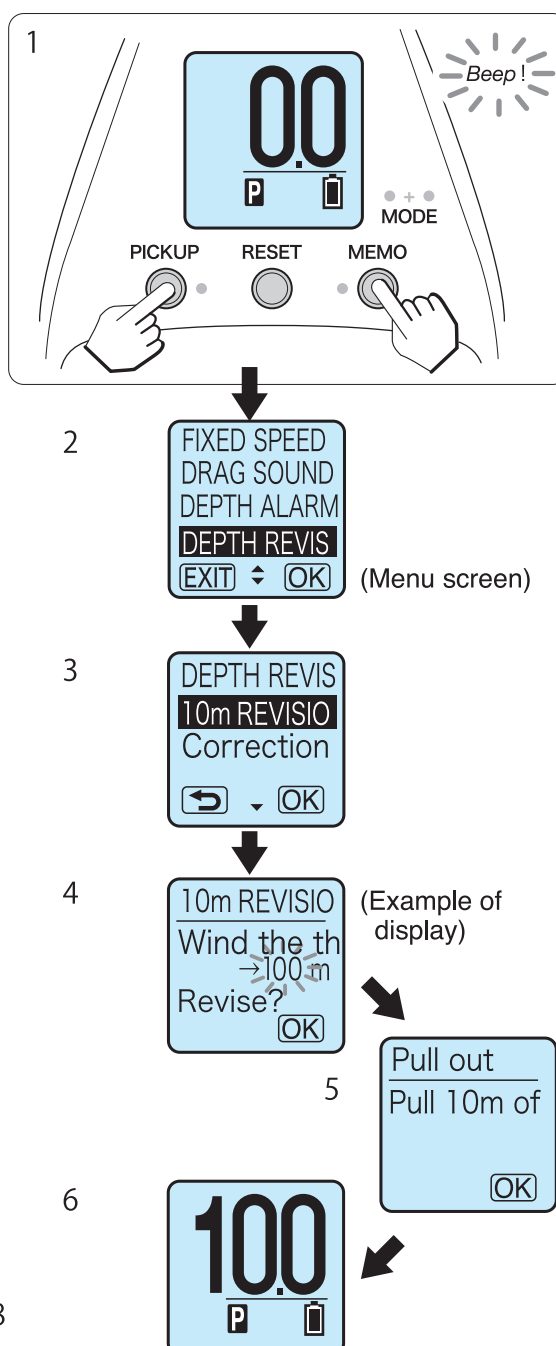

Functional setting [19. Actual fishing history]

Actual fishing history

You can check the total winding distance and the total hours of fishing using the electric reel.

1. Press and hold both **MEMO** **BUTTON** and **PICKUP** **BUTTON** simultaneously for 2 seconds to go to the Menu screen.
2. Select the “**HISTORY**” with the JOG Power Lever and press **OK** (**MEMO** **BUTTON**).

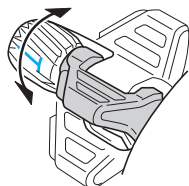

3. You can check the total winding distance and the total hours of fishing using the electric reel. Press **OK** (**MEMO** **BUTTON**) to return to the Water Depth screen.

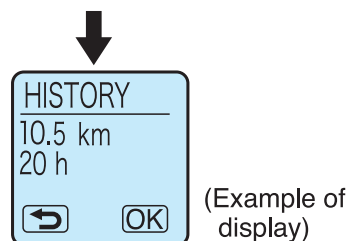
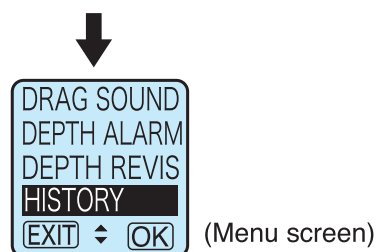
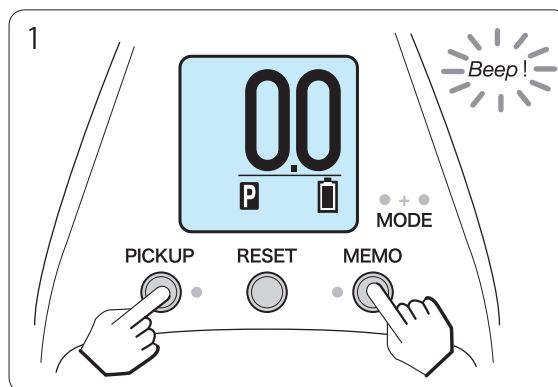

Functional setting [20. How to remove the handle knob]

1. Holding the handle knob with your hand, loosen the handle knob cap by turning it counter-clockwise to loosen using a coin and remove it.

*Be sure to fit a coin properly onto the groove on the handle knob cap before turning it. Otherwise, the handle knob cap will be damaged while turning it.

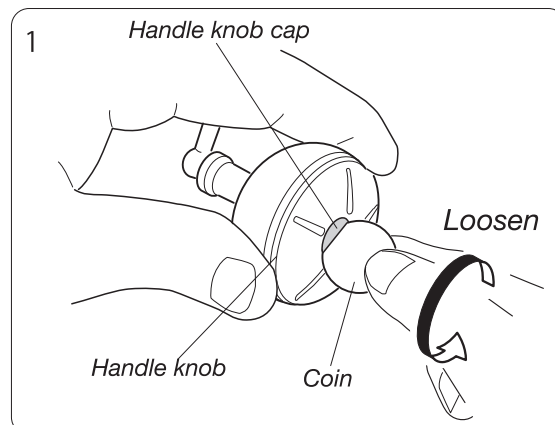

2. Loosen and remove the screw fixed inside of the knob using a screw driver.

*Note that the screw is coated with a slack preventing agent and it is hardly loosened. Be careful not to damage the screw head.

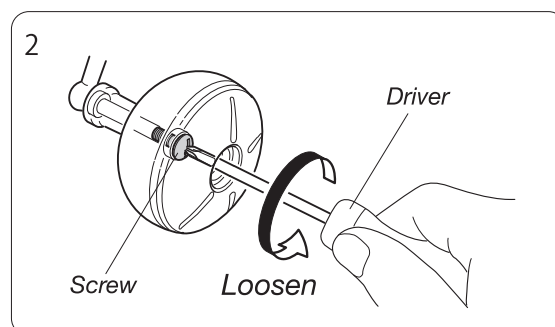

3. The handle knob is composed of as shown in the figure.

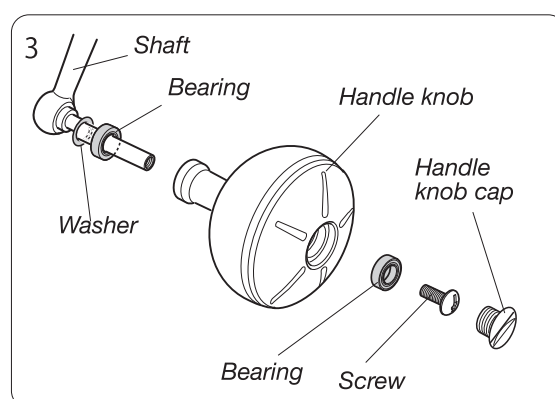

Functional setting [21. How to change the Handle Arm length]

1. Holding the handle arm with your hand, loosen (turn counter-clockwise) the two screws on the handle lock plate with a flat head screwdriver and remove them.

*The handle arm is fixed to 75 mm length by factory default

*Be sure to engage the head of the screwdriver securely into the groove on the handle lock plate screw before turning it. Otherwise, the handle lock plate screw will be damaged while turning it.

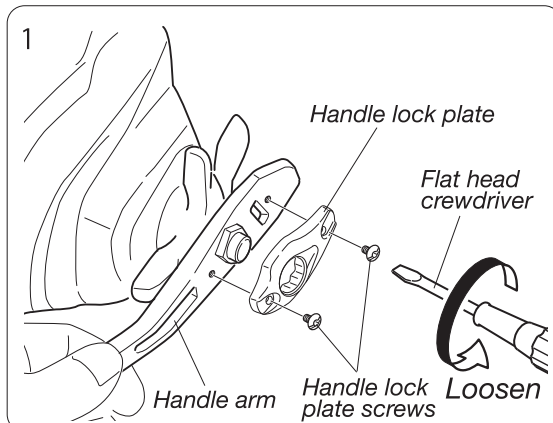

2. Loosen the handle nut with a wrench (12mm) and remove it.

*Turn the handle nut clockwise (right) to loosen.

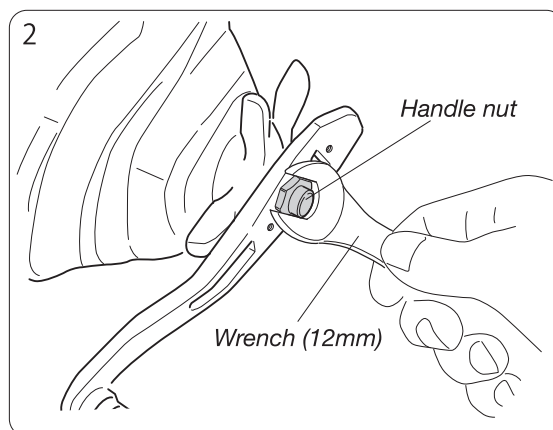

3. Pull the handle arm out from the gear shaft and insert it to the hole for your desired handle arm length.

*Shorter: 75 mm (default when product is shipped)

*Longer: 85 mm

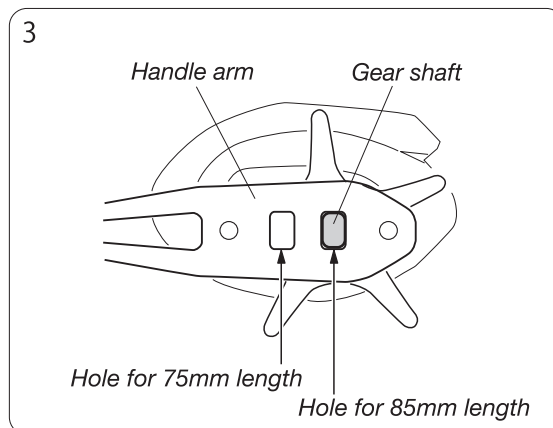

4. Tighten the handle nut with the wrench (12mm) to fix it.

*Turn the handle nut counter-clockwise (left) to tighten.

5. Holding the handle arm with your hand, tighten the two handle lock plate screws with the flat head screwdriver to fix the handle lock plate.

*Be sure to engage the head of the screwdriver securely into the groove on the handle lock plate screw before turning it. Otherwise, the handle lock plate screw will be damaged while turning it.

Functional setting [22. How to fix the rod with clamp] [Sold separately]

For mounting a rod onto a metallic bat or for your fishing with a heavy load on the rod charge, always fix the rod with clamp.

*A rod bat 16 to 28 mm in diameter is allowed to be fixed with the rod clamp.

1. Insert the bolt (S) or bolt (L), according to the bat diameter, into the mounting hole of the frame, secure the bolt with the nut.

*Use bolts (S) for a bat with a diameter of 16 to 22 mm or bolts (L) for a bat with a diameter of 22 to 28 mm.

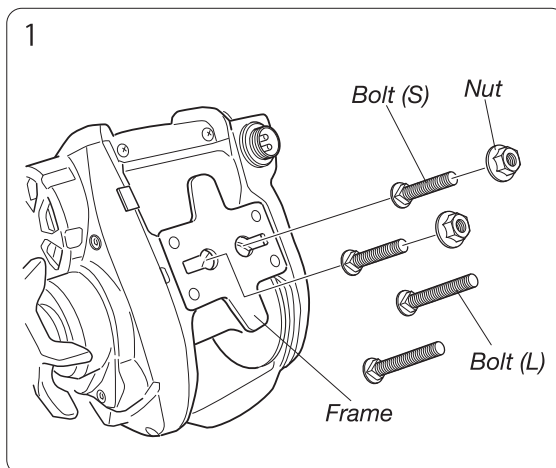

2. Set the reel on your rod. Put the clamp plate on the rod so as to clamp the rod. Secure them with the clamp plate washers and the clamp plate nuts.

*If you mount the reel on your rod with a small diameter (a diameter of 16 to 18 mm), put the clamp plate nut W between the clamp plate and the clamp plate nut.

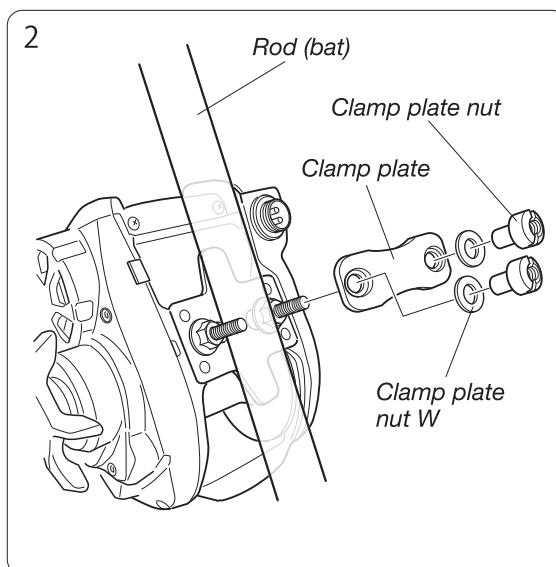

Attention

-If the nuts are tightened too tightly, there is a risk of deformation in the reel seat portion on the rod if the reel seat material is resin.

-Do not use the reel with bolts only fixed without any other parts fixed. It may cause a risk of injury on your fingers cut by the threading of the bolts.

Functional setting [23. Other useful functions]

Various alarms

Many kinds of information are indicated by audible alarms such as auto stop alarm and range memory alarm.



JOG Power Lever alarm

-When you place the JOG Power Lever at MAX or OFF position, an alarm beeps to tell you its position.

Auto stop alarm

-While winding up, an alarm shortly beeps starting 6 m below the auto stop point, at two meter intervals, to tell you that the rig is coming closer to the auto stop point. When it reached the auto stop point, an alarm sounds for longer.

Range memory alarm

-While lowering your rig back into the strike zone, an alarm shortly beeps starting 6 m above the memorized depth range of the strike zone, at 2 m intervals, to tell you that the rig is reaching closer to the strike zone. When the rig reached the strike zone, an alarm sounds for longer.

*This zone memory alarm is designed not to sound unless the line has been wound more than 6 m above the memorized depth and the line is fed again for the purpose of preventing the alarm from frequently sounding while seeking the strike zone.

Switch alarm

-Each time a button is pressed, a beep is sounded to allow you to confirm that you have surely pressed a button (You can set this alarm to OFF in the setting of functions from the Menu screen).

Excessive voltage alarm

-If you connected a power source with a voltage higher than the acceptable range, a continuous alarm will sound to warn you to stop operation. DO NOT operate the reel with such battery.

Timer winding alarm

-This alarm sounds to tell you before starting a timer winding.

Alarm sound ON/OFF setting

You can set the alarm sound to OFF.

-It is set to ON by default.

-Once the alarm sound has been set to OFF, the alarm will no longer sound even if you have pressed buttons or have used the JOG power lever for operation.

1. Select "Alarm sound" in the Menu screen.
2. Select OFF with the JOG Power Lever.
3. Press **OK** (**MEMO** **BUTTON**). If the screen returns to the "Water Depth screen", then the setting is completed.

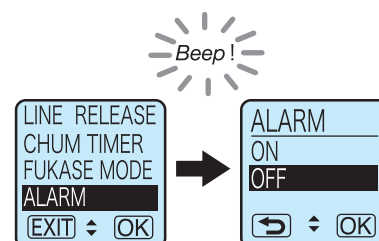

Functional setting [23. Other useful functions]

Drag sound ON/OFF setting

You can set the drag sound to OFF.

- It is set to Drag Alarm1 by default.
 - Once the drag sound has been set to OFF, the electronic beep will no longer sound even if the drag is pulled out.
1. Select "DRAG SOUND" in the Menu screen.
 2. Set the drag sound to OFF with the JOG Power Lever.
 3. Press **OK** (**MEMO** **BUTTON**). If the screen returns to the "Water Depth screen", the setting is completed.

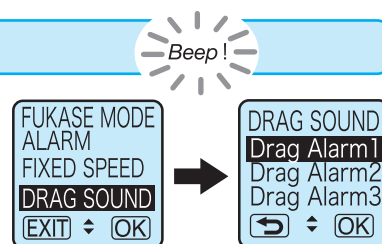

Language setting

The language displayed on the LCD screen can be selected.

1. Select "LANGUAGE" in the Menu screen.
2. Select your desired language with the JOG Power Lever.
3. Press **OK** (**MEMO** **BUTTON**). If the screen returns to the "Water Depth screen", then the setting is completed.

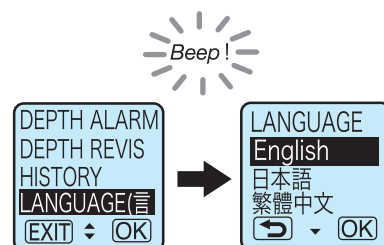

Unit setting

You can select "m" (meter) or "ft" (feet) for a unit to be used for the length.

*Note that the unit is represented in "m" (in meters) only when entering a value in "Main line input" even if "ft" (in feet) has been set for the unit.

1. Select "UNIT" in the Menu screen.
2. Select your desired language with the JOG Power Lever.
3. Press **OK** (**MEMO** **BUTTON**). If the screen returns to the "Water Depth screen", then the setting is completed.

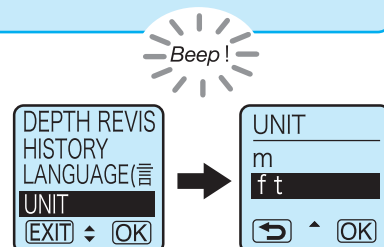

Counter lamp

The lamp built in the counter always lights up.

- While the reel is powered ON, backlighting of the display always provides easier reading for fishing in the dark.

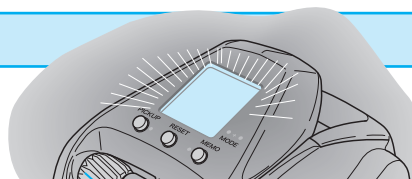

Circuit breaker display

The lamp built in the counter always lights up.

- For safety fishing, the circuit breaker is tripped by an overload onto the reel to stop electrical winding for 15 seconds. While the circuit breaker is tripped, it is displayed as shown in the figure.
- The reel may stop for more than 15 seconds depending on the load applied to the reel.



(Indicator is blinking)

Functional setting [23. Other useful functions]

Certification

1. When **0.0** is displayed, press and hold the switches **MEMO BUTTON** and **PICKUP BUTTON** simultaneously for 2 seconds to display the menu screen.
2. Select “**CERTIFICATION**” with the JOG Power Lever and press **OK** (**MEMO BUTTON**).
3. Select “**Japan**” and press **OK** (**MEMO BUTTON**).
4. Then, “Technical standards compliance” mark is indicated.

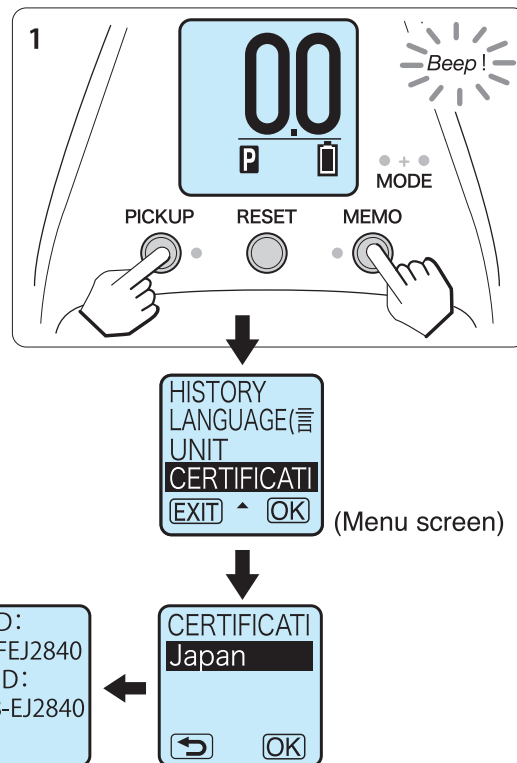

Reel Specifications

Reel Specification list

26SEABORG 500J(AS)

Product code		00096044	
GEAR RATIO		3.8:1	
REEL WEIGHT(g)		750 (26.5 oz)	
DRAG MAX(kg)		23 (50 lb.)	
LINE CAPACITY	PE / BRAID	EU / ASIA	USA / Australia
		#4 (0.28 mm) - 500 m (550 yds.)	40 lb. (0.32 mm) - 500 m (550 yds.)
		#5 (0.31 mm) - 400 m (440 yds.)	50 lb. (0.36 mm) - 400 m (440 yds.)
		#6 (0.35 mm) - 300 m (330 yds.)	65 lb. (0.41 mm) - 300 m (330 yds.)
	FLUORO / NYLON	25 lb. (0.40 mm) - 350 m (380 yds.)	
		30 lb. (0.43 mm) - 322 m (330 yds.)	
		35 lb. (0.47 mm) - 250 m (270 yds.)	
BALL BEARINGS		16	
POWER SUPPLY VOLTAGE ※1		DC16.8V	
Momentary winding power (Kgf)		75.7 (167 lb.)	
No-load winding speed (m/min)		215	
CURRENT VALUE (A)	NO-LOAD	4	
	RATED	6	
	MAX	35	
Optimum battery		Daiwa Super Lithium Series Daiwa tough battery Series	

※1 : Usable voltage is DC12 to 16.8V. Connecting other power sources (AC100V, 200V, or other DC power supply voltage that is not available) may cause product damage or accidents.

*Capacity may vary due to line tension.

*Digital readout shows measurements in meters.

*Measurement is based on 13V power supply voltage.

*The line winding amount is just a guideline and may vary depending on the manufacturer, item, and tension of the line.

Counter display

Depth display range	Upper counter: 0 to 9,842 ft (3,000 m) Lower counter: - 9,842 ft (- 3,000 m) to 9,842 ft (3,000 m)
Usable temp. range	-50°F (-10°C) to +140°F (60°C)

*The specifications are subject to change without prior notice for product improvement.

FCC ID:
ISED ID:28568-EJ2840

Parts List

SEABORG 500J

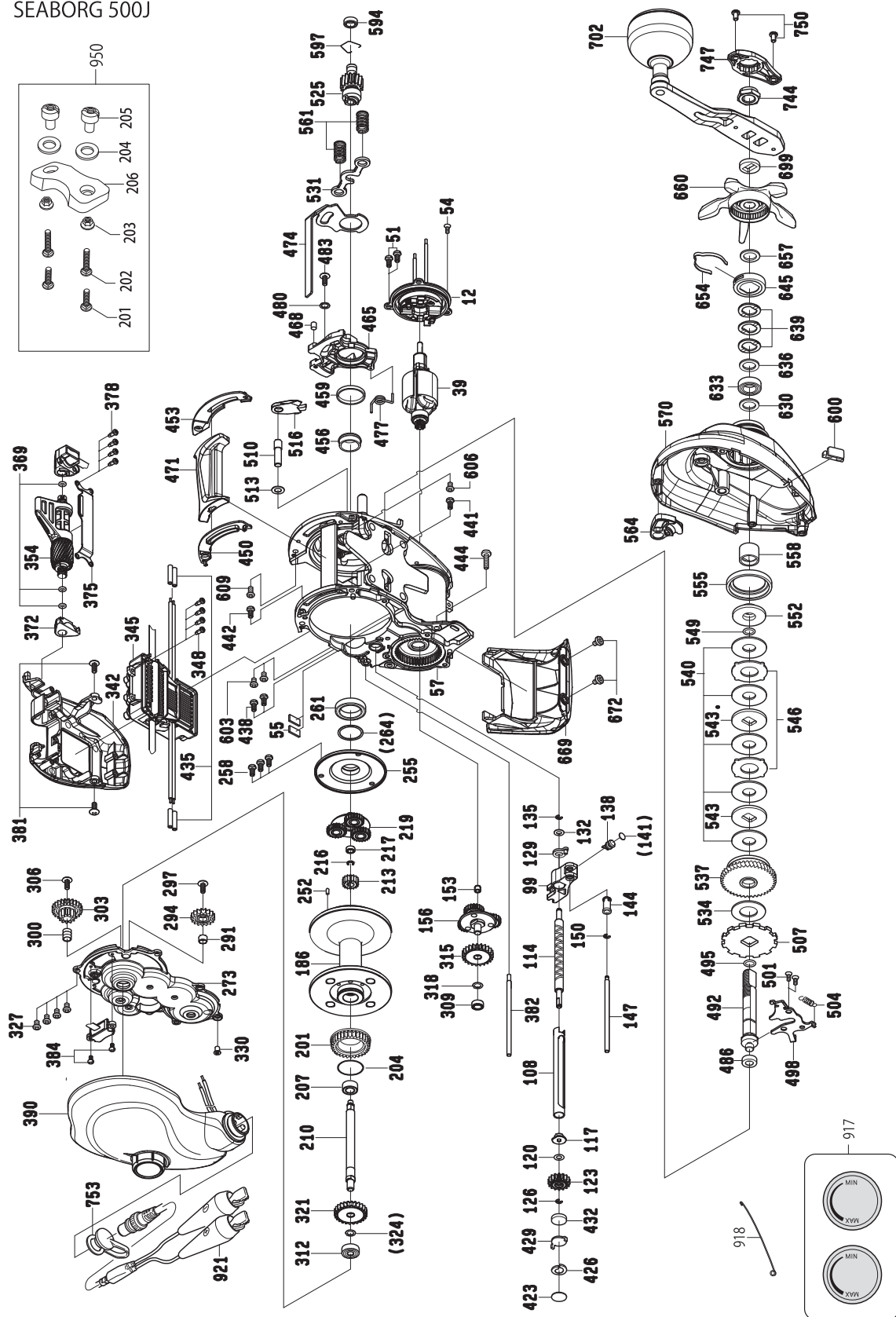

Parts List

SEABORG 500J

No.	Parts Name	No.	Parts Name	No.	Parts Name
12	MOTOR HOLDER	321	SPOOL SHAFT GEAR(B)	531	CLUTCH PLATE
39	MOTOR	324	SPOOL SHAFT GEAR(B) WASHER	534	DRIVE GEAR WASHER
51	MOTOR HOLDER SCREW(A)	327	SET PLATE SCREW(A)	537	DRIVE GEAR
54	MOTOR HOLDER SCREW(B)	330	SET PLATE SCREW(B)	540	DRAG WASHER
55	BUFFER SHEET	342	IC MODULE COVER	543	DRAG DISC WASHER
57	FRAME	345	IC MODULE	546	DRAG LIP WASHER
99	LEVELWIND	348	IC MODULE COVER SCREW(A)	549	GEAR SHAFT O RING
108	WORM SHIELD	354	JOG POWER LEVER	552	DRAG DISC COLLAR
114	WORM SHAFT	369	JOG POWER LEVER O RING	555	DRAG PACKING
117	WORM SHAFT COLLAR	372	JOG POWER LEVER HOLDER(L)	558	DRAG COLLAR
120	WORM SHAFT WASHER(A)	375	JOG POWER LEVER PLATE	561	CLUTCH SPRING
123	WORM SHAFT GEAR	378	JOG POWER LEVER PLATE SCREW	564	CLUTCH CAM LEVER
126	WORM SHAFT RETAINER	381	IC MODULE COVER SCREW(B)	570	RS PLATE
129	LEVELWIND COLLAR	382	LEVELWIND POST(B)	594	PINION BALL BEARING
132	LEVELWIND WASHER	384	SET PLATE SCREW(C)	597	PINION BEARING RING
135	LEVELWIND RETAINER	390	LS PLATE	600	LINE STOPPER
138	PAWL	423	FALL BRAKE DIAL WASHER(A)	603	RS PLATE SCREW(A)
141	PAWL WASHER	426	FALL BRAKE DIAL SPRING WASHER	606	RS PLATE SCREW(B)
144	LEVELWIND POST COLLAR	429	FALL BRAKE DIAL WASHER(B)	609	RS PLATE SCREW(C)
147	LEVELWIND POST(A)	432	FALL BRAKE DIAL WASHER(C)	630	HANDLE BALL BEARING WASHER(A)
150	LEVELWIND POST RETAINER	435	CORD COVER	633	HANDLE BALL BEARING
153	MOTOR GEAR COLLAR	438	LS PLATE SCREW(A)	636	HANDLE BALL BEARING WASHER(B)
156	MOTOR GEAR(A)	441	LS PLATE SCREW(B)	639	DRAG SPRING WASHER
186	SPOOL	442	LS PLATE SCREW(C)	645	DRAG HOLDER
201	LS SPOOL GEAR	444	FRAME SCREW	654	DRAG LEAF SPRING
204	LS SPOOL GEAR RING	450	CLUTCH LEVER PLATE(R)	657	STAR DRAG WASHER
207	SPOOL SHAFT BALL BEARING(A)	453	CLUTCH LEVER PLATE(L)	660	STAR DRAG
210	SPOOL SHAFT	456	CLUTCH CAM BEARING	669	FINGER COVER
213	SPOOL SHAFT GEAR(A)	459	CLUTCH CAM BEARING COLLAR	672	FINGER COVER SCREW
216	SPOOL SHAFT GEAR(A) RETAINER	465	CLUTCH CAM	699	HANDLE COLLAR
219	SPOOL GEAR	468	CLUTCH CAM MAGNET	702	HANDLE
252	SPOOL PIN	471	CLUTCH LEVER	744	HANDLE NUT
255	SPOOL PLATE	474	CLUTCH CAM PLATE	747	HANDLE LOCK PLATE
258	SPOOL PLATE SCREW	477	CLUTCH CAM SPRING	750	HANDLE LOCK PLATE SCREW
261	SPOOL PLATE BALL BEARING	480	CLUTCH CAM WASHER	753	CONNECTOR CAP
264	SPOOL PLATE WASHER	483	CLUTCH CAM SCREW		
273	SET PLATE	486	GEAR SHAFT BEARING		
291	IDLE GEAR(A) COLLAR	492	GEAR SHAFT		
294	IDLE GEAR(A)	495	GEAR SHAFT O RING		
297	IDLE GEAR(A) SCREW	498	GEAR SHAFT PLATE		
300	IDLE GEAR(B) COLLAR	501	GEAR SHAFT PLATE SCREW		
303	IDLE GEAR(B)	504	KICK LEVER SPRING		
306	IDLE GEAR(B) SCREW	507	RATCHET		
309	MOTOR GEAR(B) BALL BEARING	510	CLUTCH CAM LEVER PIN		
312	SPOOL SHAFT BALL BEARING(B)	513	CLUTCH CAM LEVER WASHER		
315	MOTOR GEAR(B)	516	CLUTCH CAM LEVER		
318	MOTOR GEAR(B) WASHER	525	PINION		

There may sometimes be a difference between the purchased reel and the Dismantled Parts Chart or the parts list above due to the adjustment process etc. We appreciate your understanding.

Trouble shooting

Symptom	Possible causes	To do	Ref. page
Motor does not respond to the JOG power lever.	The counter displays 2.0 m.	It is a normal function to avoid over winding.	P39
	Did not pull the lever to OFF position.	Pull the lever to OFF and then move forward again to start winding.	P16
	Unstable power source.	Use another power source, such as electric reel specific batteries.	P11
Counter display does not appear.	Battery charge is low.	Recharge the battery.	P10-12
	Cord worn or corroded.	Replace the cord.	P14
	Incorrect battery connection.	Connect clips correctly without + / - reverse connection.	P10
Auto stop function does not work.	Did not press RESET BUTTON at surface.	Set the surface depth to zero after setting rig.	P39
	Error for sinker weight or rocking of the boat.	Adjust settings of auto stop function.	P40
	Line is elongated.	Reset the depth counter at the surface.	P39
There are counter errors.	Line length has increased due to stretching.	Re-enter line data.	P21-33
		Recalibrate the water depth.	P57,58
	Line was wound while powered off during fishing.	Re-enter line data.	P21-33
	RESET BUTTON was pressed and held while feeding the line.	Re-enter line data.	
Pickup does not respond.	Speed setting is at zero.	Go to the Menu screen to set the Jigging again.	P43
	Distance is already below +3 m from auto stop.	Designed not to wind in this range for safety.	P43
The Jigging mode (PICKUP) button is pressed but Jigging does not start.	The clutch has been turned OFF.	Turn On the clutch to operate in the Jigging mode.	P44~48
	Distance is already below +3 m from auto stop.	Designed not to wind in this range for safety.	
	Pickup mode is selected.	Select Jigging mode in the MENU screen.	
The reel does not move even though I operate the remote jog.	<ul style="list-style-type: none"> -Is the distance between the remote control and the reel too far apart? -Are the batteries loaded correctly? -Is the battery level low? -Is the reel to be used correctly paired with the remote jog? 	Replace the batteries with new ones and try to reconnect the reel again.	P34,35

*Contact your dealer if the reel does not function properly despite the above details being confirmed, in the event of other problems arising, and to order parts.

Daiwa Corporation 20155 Ellipse Foothill Ranch, CA 92610, U.S.A. Phone: +1 562 375 6800 www.daiwa.us	Daiwa (Australia) Pty,Ltd. 33 Cross Street Brookvale NSW 2100 Australia Phone: +61 2 8644 8644 www.daiwafishing.com.au
Daiwa Sports Ltd. Netherton Industial Estate, Wishaw, ML2 0EY, Lanarkshire, Scotland,U.K. Phone: +44 1698 355723 www.daiwasports.co.uk	Daiwa France S.A.S. 77, route de Neufchâtel 76000 ROUEN Tel: +33.2.32.91.96.50 www.daiwa.fr
Daiwa Germany GmbH Georg Brauchle Ring 23-25 80992 München Germany Phone: +49 89 309 0650 www.daiwa.de	Daiwa Italy S.r.l. Via Polesine 13 20139 Milano, Italy Phone: +39 02 8725 0585 www.daiwaitaly.it
Daiwa Rus LLC Krasnoproletarskaya str. 16/2, office III, room 12, Moscow, 127473, Russian Federation Phone: +7 495 223 71 68 www.daiwarus.com	Daiwa FT Enterprise (Taiwan) Co.,Ltd. No.70-2 Yueh Hu Road, Tun Pei Village, Hou Li District, Taichung city, Taiwan Phone: 04-2556-5099 www.daiwaseiko.com.tw
Daiwa Sports (Guangzhou) Co.,Ltd. 1202 No.1 Longxidong Road, Liwan District,Guangzhou, China. 510375	Daiwa Sports (M) SDN.BHD. No.1929, Jalan Industri Permatang Batu, Permatang Batu,14000 Bukit Mertajam, Pulau Pinang, Malaysia Phone: 04-540-4457 www.daiwa.my
Singapore Daiwa PTE. Ltd. 6 Raffles Boulevard, Marina Square #03-308, Singapore 039594 Phone: 65-6932-2688 www.sg.daiwacm.com	