



LEOBRITZ S 500JP

Instruction Manual

Index

Caution-----1-7(1,2,3)	17. Other useful functions -----47,48
Power source-----8,9(1,2)	Various alarms-----47
How to connect the power source-----8	Alarm sound ON/OFF setting -----47
About the power source-----9(1)	Language setting -----48
Battery level indicator-----9(2)	Unit setting-----48
Maintenance -----10,11	Counter lamp-----48
About maintenance -----10	Circuit breaker display-----48
Maintenance procedures -----10	Reel Specifications-----49
Handling and maintenance of the power cord --11	Reel Specification list -----49
Maintenance of the power cord-----11	Counter display-----49
Other maintenance points -----11	Parts List-----50
Names and functions of each part -----12,13	Trouble shooting -----51
Names of the buttons and the display -----14	
Introduction -----14	
Functional setting -----15-48	
1. How to operate the Menu screen -----15,16	
Setting of useful functions-----15,16	
2. Main line input -----17-26	
P1 Line Input -----17-19	
P2 Backing line input -----20-23	
P3 Line re-input -----24-26	
3. Sub counter-----27-29	
Inverse counter-----27	
Winding speed -----28	
Time to wind up -----29	
4. Before start fishing -----30	
Water surface zero setting -----30	
If the main line is broken -----30	
5. Auto stop -----31,32	
Adjustable auto stop setting -----31,32	
6.Line feeding function -----33	
7. Pickup / Pause-----34	
8. Jigging -----35-37	
9. Chumming Timer -----38	
10. Chumming Timer Winding -----39	
11.Drift mode-----40,41	
12.Constant Speed Winding -----42	
13.Water depth recalibration-----43	
14. Actual fishing history -----44	
15. How to fix the rod with clamp -----45	
16. How to remove the handle knob -----46	

List of options for line data input

This reel can be configured and set-up using the following options.

P1 Line Input 17-19

This option allows you to set useful functions when you know the length of the fishing line to be wound on the reel.

P2 Backing line input 20-23

This option allows you to set functions to insert a backing line. Note that it is necessary that you know the line length and that it is greater than 100 m.

P3 Line re-input 24-26

This option allows you to re-enter the line data, pulling out the line after it has been completely wound up onto the reel. Note that it is necessary that you know the line length and that it is greater than 100 m.

Thank you for purchasing a LEOBRITZ S500JP. Please read this operation manual carefully and use the product safely and correctly to take full advantage of this electric reel with many convenient features for your on-board fishing. Please keep this operation manual carefully together with your reel for your future reference.

Caution

This document contains important instructions for using your electric reel. Please be sure to read them thoroughly before use. Note that we will not warrant for any use of the product without reading the Instruction Manual and the "Warning List" supplied with the product before use.

About the signs



This sign means "prohibited actions." Within the area or near this sign, specific prohibited actions are described.



This sign means "actions that require caution." Within the area or near this sign, specific actions that require caution are described.



This sign means "mandatory actions." Within the area of this sign, specific mandatory actions are described.



WARNING

The following pertains to matters that could cause problems or serious, even life-threatening injuries should the instructions be ignored or incorrectly followed.

-Be careful not to catch your fingers between the reel and the level wind, which is used to wind line into the spool evenly. It may cause injury.



Hands off!

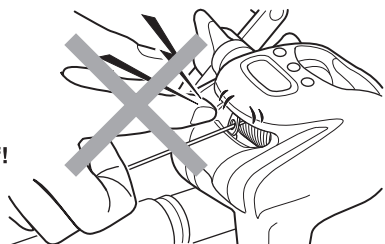

-When you turn on the clutch while feeding line (operated by the motor), it winds up the line. Be careful not to catch your fingers. It may cause injury.



Hands off!

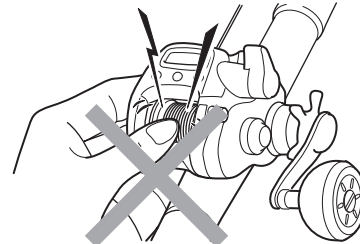

-Keep your eyes on your reel during use. Failure to do so may result in an unexpected accident or injury.

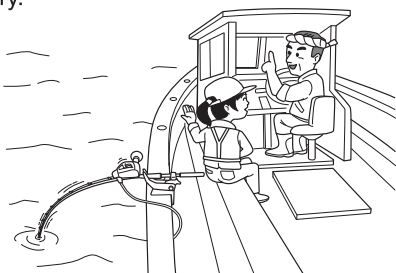

-For a big game fishing using large sized electric reel, make sure to fix the reel properly and firmly to the rod clamp or the holder. Failing to fix it firmly may result in an unexpected accident or injury.

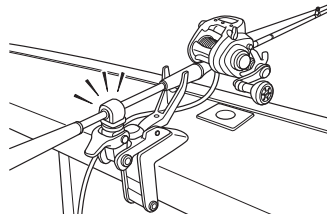

-Do not use the reel in an unbalanced and unnatural stance. Stand with your feet planted firmly on the ground to give you a balanced stance.

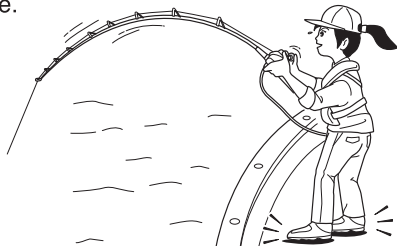

-Adults or parent's must supervise closely any use of this product by children. Use extreme caution to keep their fingers and hands away from moving parts or openings in the reel.



Cautious handling!

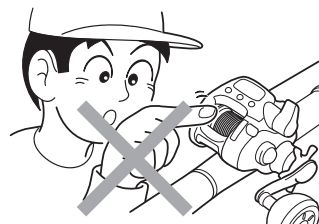

Caution

WARNING

The following pertains to matters that could cause problems or serious, even life-threatening injuries, should the instructions be ignored or incorrectly followed.

-Wear appropriate clothes and equipment during use. When you are not careful, you may be caught in the rotating parts or injured due to flying debris, resulting in serious injury or disability.

1. Keep your hair, clothing, and or gloves away from the rotating parts.
2. Wear non-slip footwear.
3. Cover long hair with a cap or hair cover.
4. Do not wear necklaces, neckties, or other jewelry and accessories that may be caught unexpectedly.
5. Be sure to wear equipment that protects your eyes, such as polarized glasses or eyeglasses.

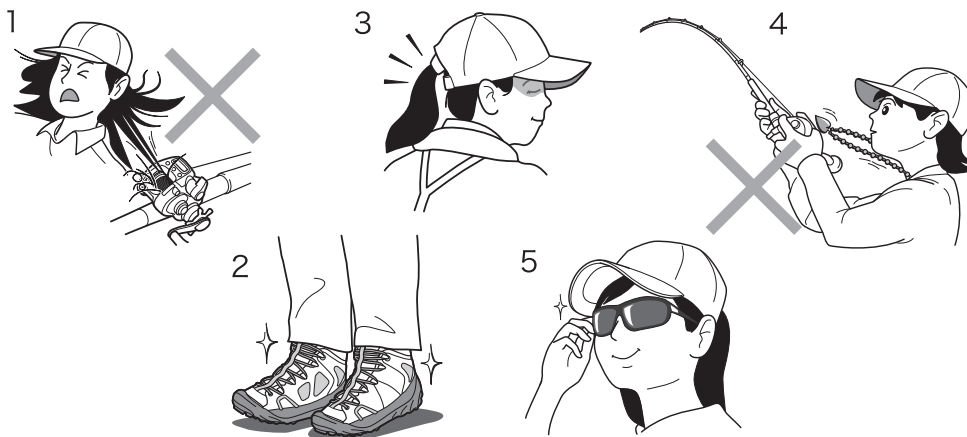

-Do not use and keep this product within the reach of children. Keep out of reach of children for storing or use of the product, as well as the reel itself, the packaged items and accessories.



Secure storage!

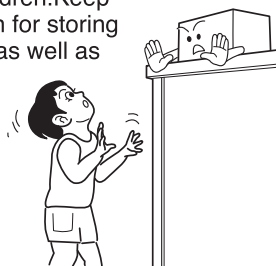

-When using batteries or the power supply of a boat, only apply the designated voltage. Other voltage may cause an abnormally high temperature in the electric reel, that could burn your hand or damage the microchip. Do not connect to house current or any AC (alternating current) power supply. The circuit may be short-circuited and result in smoke and fire.

-While using an electric reel, weak radio waves will be generated, which may affect medical equipment, such as malfunction of hearing aids and pacemakers. In particular for a person implanted with a heart pacemaker, use of electric reel may cause palpitations or dizziness; Do Not use this product.



Do not use!



Do not use!

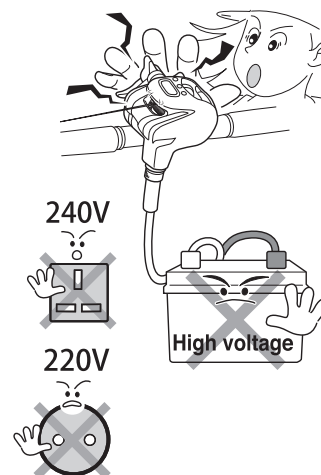

Caution

! WARNING

The following pertains to matters that could cause problems or serious, even life-threatening injuries, should the instructions be ignored or incorrectly followed.

-Do not immerse the battery in a conductive material such as water. Doing so may cause the battery to be shorted out, resulting in damage, fire or getting burned.



-Do not fasten an electric reel with a harness onto your body. You may risk your life if pulled into the seawater by a big fish or in other situations.



Do not use!



-Keep the reel, cords, and batteries away from combustible materials and flammable substances (liquids, gases, and powder dust) to prevent ignition or explosion.

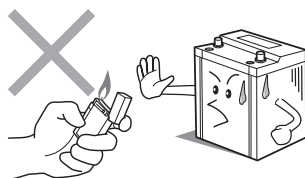

-Should the motor fail to stop for some reason while fishing, use caution to prevent your fingers being caught in the reel. Disconnect the power supply immediately.

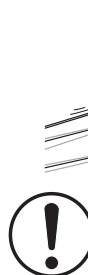

Remove power supply!

Remove!



-Ensure to fix the electric reel securely to the reel seat before use. Do not use the reel if it is seated unsteadily and rattled or if it cannot be fixed firmly. If the reel comes off during fishing, you may be injured.

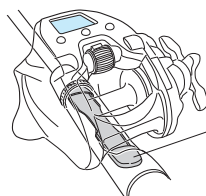

Reel seat

-Do Not connect the reel with the battery and or the cord when your hands are wet. Failure to do so may result in electric shock. If you connect it during rain, wipe your hands with a dry towel or the like and connect it quickly.

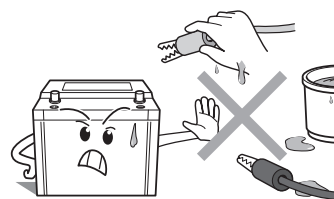

-Be careful not to get the power cord wrapped around your body. Failure to do so may result in getting dragged into the sea.



Cautious handling!

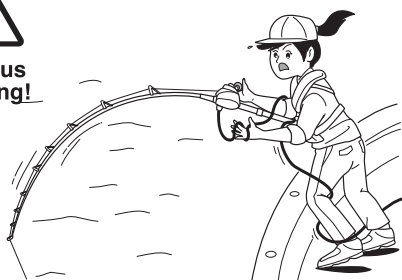

-Do not touch moving parts while in operation. It may cause injuries.



Hands off!

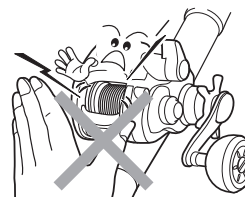

Caution

! WARNING

The following pertains to matters that could cause problems or serious, even life-threatening injuries, should the instructions be ignored or incorrectly followed.

-Follow the national and local regulations to dispose of the product and battery.

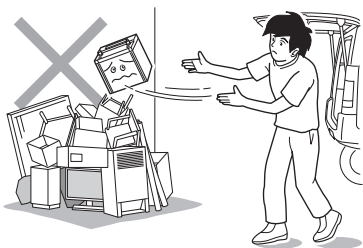

-Be sure to turn OFF the auto-wind lever before setting the dragging power. Failure to do so may result in your hand getting cut by the line while you are pulling it manually for setting the dragging power.



Stop winding

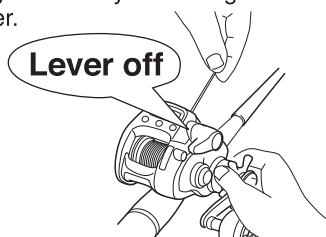

-Do not touch or grab the line when it is being released or wound rapidly. The line may cut your fingers.



Hands off!

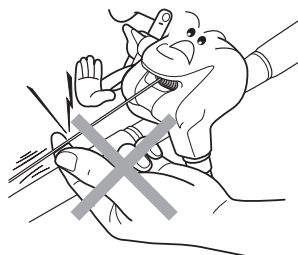

-Before reconnecting the power cable on the boat, thoroughly wipe away any moisture such as saltwater from the connecting parts with a dry cloth. If you connect it wet, it may short-circuit causing electric shock, smoke, or even fire.



Cautious handling!



-When you do not use the product for fishing, turn off the winding lever and power supply. Failure to do so may result in unintended operation of the product, resulting in injury or other problems.

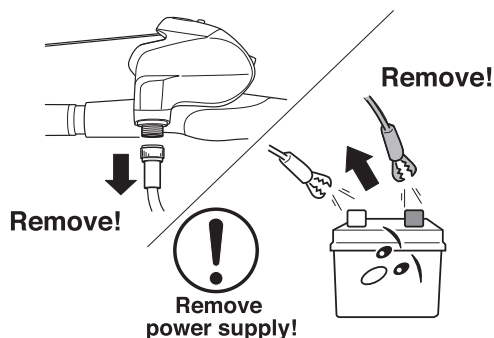

-Depending on the conditions of use or storage of the product, the cord may break or be shorted out, resulting in smoke or fire. Be sure to follow the "Precautions for Handling Cord", "Instructions for Maintenance of Cord" and "Other Precautions for Maintenance". Be sure to disconnect the power supply before maintenance of the cord. An old cord may cause breakage, short-circuit, or trouble. We recommend to replace the cord every two years or every 60 times of use, in order to maintain the performance of the reel.

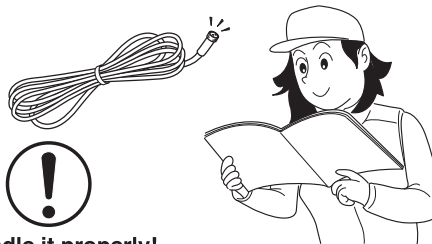

-Do Not touch the heat radiation area of the motor. It may become hot, resulting in getting burned.



Hands off!

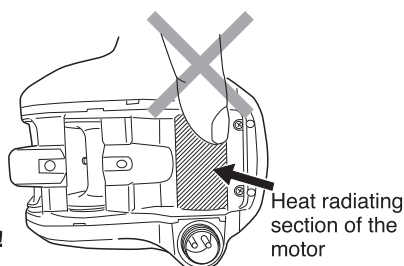

Caution

! WARNING

The following pertains to matters that could cause problems or serious, even life-threatening injuries, should the instructions be ignored or incorrectly followed.

-Do Not attempt to disassemble or modify the reel. Failure to do so may cause problems with the performance of the reel or lead to malfunction. Also, this is not covered by the product warranty.



Do not modify!



-Do not modify the cable. It may cause a short-circuit or other problems and could result in smoke or fire.



Do not modify!



-Stop the operation before disconnecting the power supply. Failure to do so may result in malfunction. Shutting off the power while the reel is rotating may cause sparks, fire or explosion.

Remove!

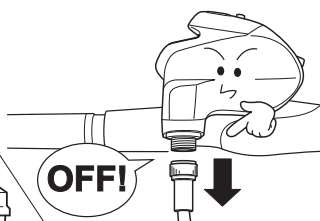
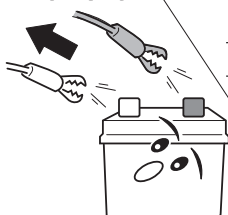

-In the event of abnormalities such as smelling burnt or leakage of electricity, immediately stop the operation and disconnect the power supply. Failure to do so may result in abnormal heat generation, fire, or electric shock.

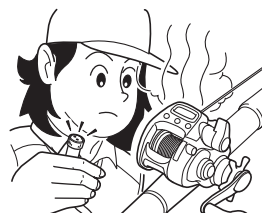

Remove power supply!

Remove!

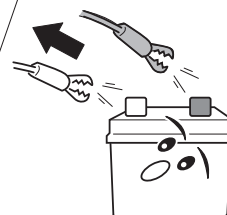

-Shocks, such as dropping the product, may cause breakage or damage to the internal electronic parts, cracks resulting in water intrusion, or short-circuit of the circuit board resulting in functional failure. Be careful not to apply strong shocks or heavy pressure to the product. (Even if there is no abnormality on its appearance, the product may be malfunctioned). Dropping the product also may cause you to be injured.



Cautious handling!

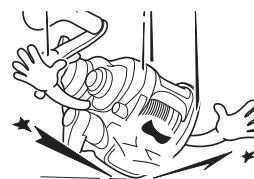

-Before going fishing, please check the reel for proper operation to ensure an enjoyable fishing trip.

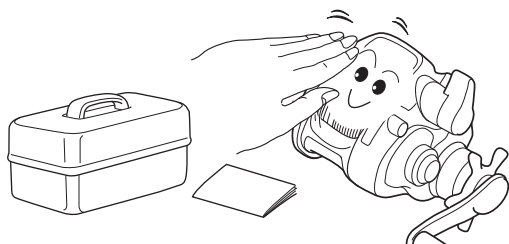

-Be careful not to get a piece of cloth, clothes, hair caught in the reel while winding up the line. Be careful not to wind the loosen line due to backlash, etc.

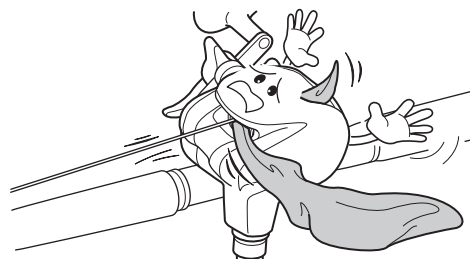

Caution

⚠ CAUTION

The following pertains to matters that could cause problems or serious, even life-threatening injuries, should the instructions be ignored or incorrectly followed.

-If the reel is dropped or shocked, the counter or the main body of the reel may crack resulting in water intrusion. Use of the reel in such a condition may cause the motor to be out of control, resulting in injury. Stop using the product and bring it to your nearest DAIWA dealer for repair.



Do not use!

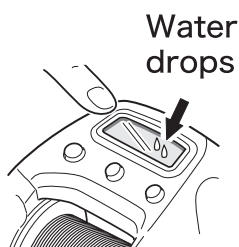

-When winding up line indoors, do so at high speed. If wound up at low speed and high tension, the motor may heat up abnormally and emit smoke. Power to wind up electronically may deteriorate.



Cautious handling!



-Do not wind up with excessive force when line is tangled with other angler's lines or snagged on the bottom. It may cause damage to your rod and other components.



Handle with care!

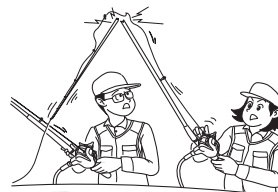

-Do not put a magnetic item such as magnet closer to the product. Otherwise, it malfunctions or causes failure.

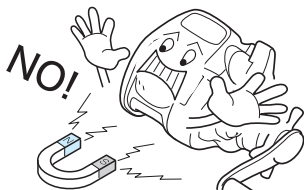

Cautious handling!



-Handle it cautiously as to not to stain your clothes with grease or oil from moving parts.



Risk of injury!



-When your hook is caught in the bottom, do not jerk the rod to free it. Pull the line with your hand and cut it if it fails to pull free. (Be sure to protect your hands with gloves or a towel.) If you use thick leader and cannot cut it with hands, talk to the captain for a safe treatment.

-Before connecting it to the power supply, be sure to loosen the drag well. If the IC breaks, and the motor does not stop, the terminal rig may be wound into the reel and the rod may break.



Required handling!

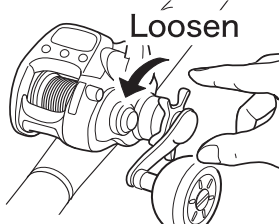

-Do not use wire line with your reel. It may cause corrosion or damage to the spool.



Do not use!

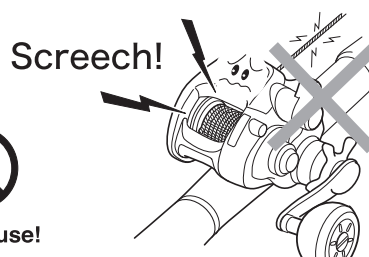

Caution

⚠ CAUTION

The following pertains to matters that could cause problems or serious, even life-threatening injuries, should the instructions be ignored or incorrectly followed.

-Use the reel only for the purpose of fishing.



Never use it for other purpose!

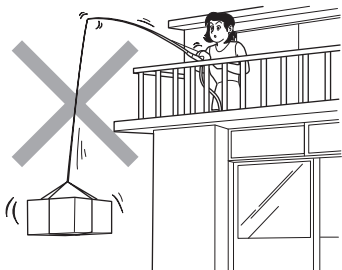

-Reset the counter whenever it displays the wrong number, you have cut off line, disconnected the power supply or changed Line thickness. If you use the reel without resetting the counter, your terminal rig may be pulled into the reel and break the rod or other components. Forgetting to reset it with your terminal rig at the water surface may cause the same problem.



Required operation!

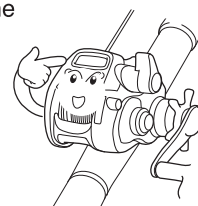

-Do not touch parts where the surface or top coatings (such as paint) are peeled off. It may cause injuries.



Hands off!



-Do not step on or place objects upon the reel. It may cause problems with the reel.

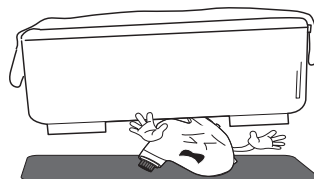

-Do not insert a stick or metallic object into the opening between the spool and the frame or other parts of the reel. It may cause problems with the reel.

NG!

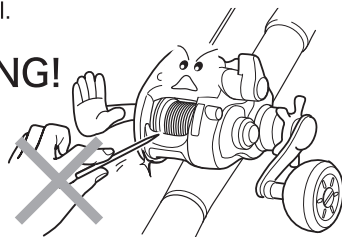

-Do not leave the reel near heating appliances. Resin may melt and deform or deteriorate causing problems.

Hoo

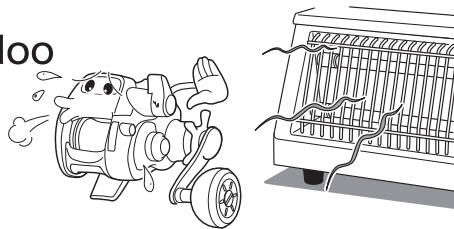

-Do not store a wet reel in a plastic bag or a fishing bag because it may cause rust or malfunction.

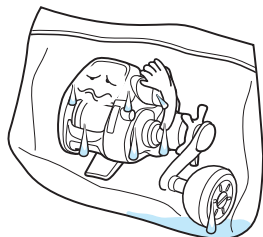

-When storing the reel for a long time, wipe down the moisture completely and preserve it in as well a ventilated place as possible without direct sunlight. Loosen the drag when storing it.

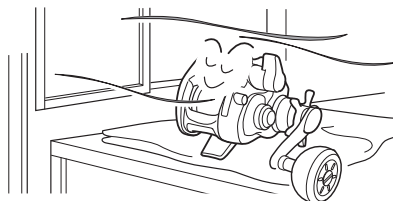

Caution

⚠ CAUTION

The following pertains to matters that could cause problems or serious, even life-threatening injuries, should the instructions be ignored or incorrectly followed.

-Use neutral detergent (dish washing detergent) when washing the electric reel. Do not use chlorine, acidic, or alcohol type cleaners. It may deteriorate resin and cause problems with the reel.

Please do not use any chemical liquid and organic solvent such as thinner, benzene, alcohol, insect repellent, sunscreen or insecticide to the product using of such may cause surface deterioration or peeling off of surface paint. Never handle the product with your hands stained with such substance.

Neutral
detergent

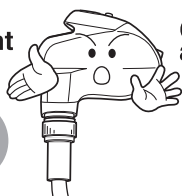

Chlorine, acidic,
alcohol



-When the reel is stored with the wet line with salt seawater, the spool may rust. Wash only the spool part with tap water to rinse off seawater sufficiently, and then dry it in a well ventilated place without direct sunlight before storing it.



-Unplug the power supply and the reel not in use.

Remove!

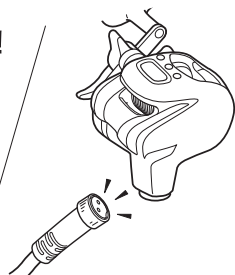
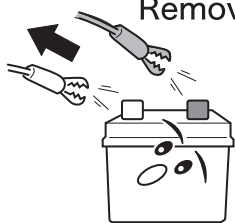

-Do not store the reel with tightly-wound, damp line. During storage, the line may dry up and shrink, resulting in damage to the spool. Do not wind nylon or fluorocarbon line onto a model designated exclusively for PE line (braided line).

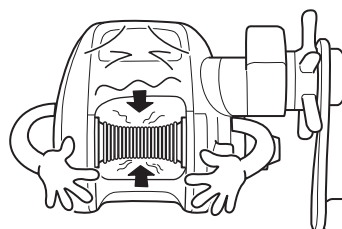

-The position of the pre-set auto-stop point varies depending on the tension of the line being wound. If you change the pre-set auto-stop point, reset the counter to zero at the water surface.

* Allow enough margin for setting the auto stop point. If you set it without enough margin, your fishing rod may be broken.



Cautious
handling!

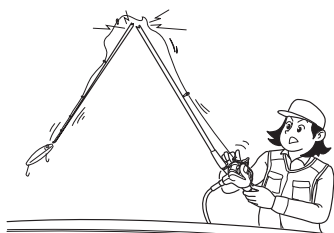

-If the breaker triggers repeatedly, the size of the reel does not match your fishing method or your target fish. Use a reel with the specifications and size that is best for your fishing.

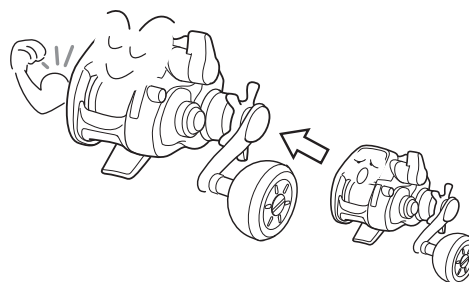

Caution

CAUTION

The following pertains to matters that could cause problems or serious, even life-threatening injuries, should the instructions be ignored or incorrectly followed.

-When shrinking a telescopic rod, do not tap rod butt on the ground with the reel attached. The reel may be damaged.

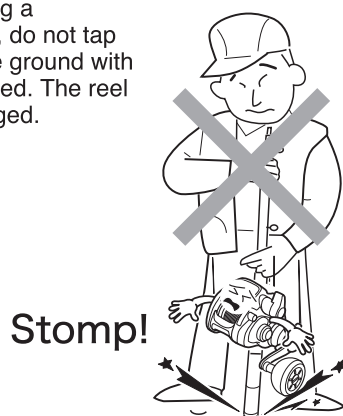

-When fixing the rod into a hole on the boat edge with the reel attached, verify that the reel does not touch the edge. When it touches, do not place it into the hole. The reel may be damaged.

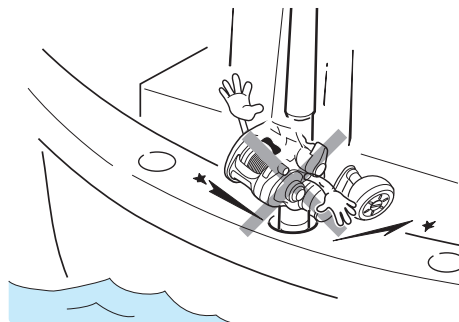

* Troubles caused by applying any parts other than our genuine parts will not be covered under our warranty. Please note in advance that we may refuse to repair the products equipped with any parts other than our genuine parts, when appropriate.

* Specifications and design are subject to change without notice for product improvement. Please note that we reserve the right to make changes without prior notice.

◆About the counter display

1. Excessively cold or hot weather, mid-winter (display's surface temperature is below -10 degrees centigrade) and mid-summer (display's surface temperature is above 60 degrees centigrade).
*In the above cases, the characters may be difficult to see due to the characteristics of the liquid crystal. Please note.
2. When light strikes the display from certain angles, the display's digits may have shadows. This does not affect its function.

Registered trademark: This is a product for which DAIWA has obtained a registered trademark. Please be careful of counterfeit and similar products. The manufacture and sale of counterfeit products is punishable by the laws of each country.

Power source

How to connect the power source

1. Attach the cord clips to the battery.
Red covered clip is the plus (+), and the black covered clip is the minus (-).
2. Insert the connector into the reel. After this, the display appears as below.
By taking the appropriate steps, the indication will change as shown below and the data will be set.

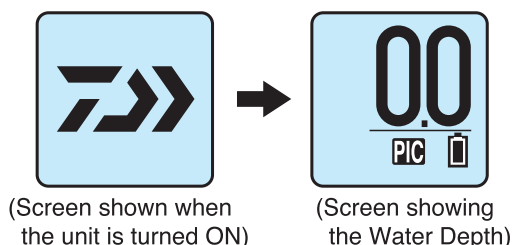
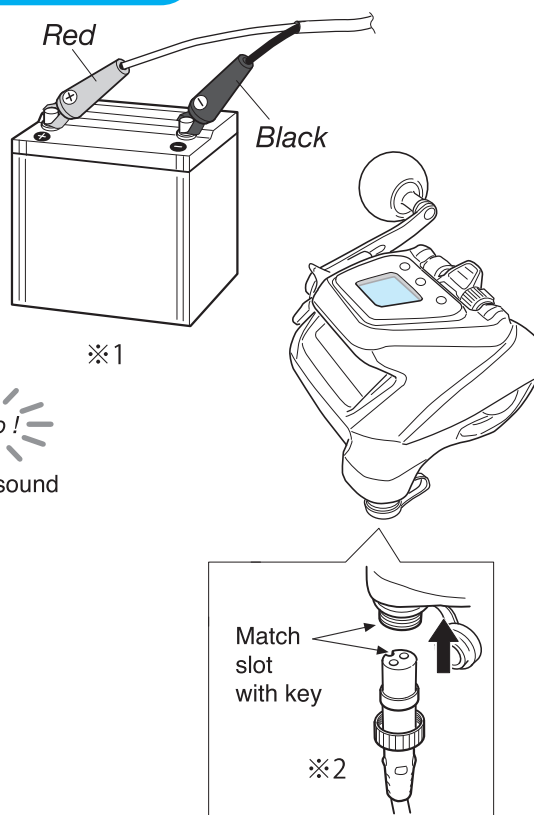

⚠ WARNING

* 1: Pay attention to the correct polarity. If the power cord is connected in reverse polarity (+/-), it will not conduct electricity and may also cause damage to the battery, the main unit, and the cord.

* Do not connect the power supply while your hands are wet with freshwater or seawater. Attempting to do so may result in electric shock. If you connect it during rain, wear rubber gloves before connecting it.

* 2: If it is connected incorrectly, it will not conduct electricity. Incorrect connection may cause short circuit, resulting in the power cord being broken. * Do not place combustibles or inflammables near the power supply, the reel, or this product. It may cause fire.

⚠ Attention

When changing batteries, the display's back up memory stays active for about 15 minutes after the old battery is disconnected. Thus the above display startup sequence does not need to replay when the new battery is connected within the 15 minute time frame.

Power source

About the power source

This reel is designed to be compatible with direct current DC 12 to 16.8 V. You may not use any power sources other than those specified to this reel (for example, AC100V from a household power supply and DC24V equipped on a boat).

The power source voltage on a boat tends to lose stability as it is largely influenced by a generator on board and wiring which may trigger the protective circuit causing sudden stop or intermittent operation of the reel. To maximize the reel performance, be sure to use the electric reel specific batteries.

240V



24V (Except specific models)



WARNING

1. We cannot compensate for any malfunction or damage caused by the battery. There are some batteries made by other manufacturers that claim to be compatible with our electric reels, however, we are not responsible for the standards, safety, or any other aspects of these products, and thus, we do not recommend you to use these products. We are not responsible for any accidents, damages, or other incidents that may result from the use of these products. If you desire to use these products in any case, you are requested to do so at your own risk. In addition, please be careful when using lithium batteries in particular, as they have a high possibility of causing serious accidents.

2. Please note that damage may be caused to your boat, when you use the power supply source on your boat.

**When you use the power supply on your boat, never use up all the capacity of the battery with the engine turned off.*

**Your engine may not start up and there may be the risk to cause drifting accidents*

3. This reel is driven by DC 12V to 16.8V.

** Only the model "Marine Power 3000" is driven by 24V. Connecting it to a power supply with a voltage higher than 24 V or connecting to household power supply will damage the electronic circuit of the electric reel, resulting in the motor getting out of control. Incorrect connection may result in smoke or fire. Be sure to check the power supply environment and the specifications.*



Attention

1. Do not use any power supply other than the specified ones.

As for the power source, we recommend the use of DEEPCYCLE battery which is waterproof secured for marine use.

Only the specified lithium power supply (in the country where it is sold) can be used for the reel.

** Please contact your nearest DAIWA dealer.*

2. Connecting the unit directly to a household or marine power source may cause damage.

3. Recharge the battery before your fishing trip. Over time, a battery can naturally discharge.

4. Confirm the boat can provide the proper power source (i.e. voltage, connector shape etc).

-Corroded connections can prevent the flow of electric current. Remove any corrosion or dirt from the connectors.

5. Use a battery of the correct voltage output. Winding up with a high load while the voltage is low may damage electronic components.

Power source

Battery level indicator

When the battery voltage is lowered while powered ON, the battery level indicator becomes as shown below.

When the voltage goes down to 10V or less, the winding power of the reel is restricted and the maximum performance cannot be gained.

If this indicator is blinking while the motor is not running, battery voltage may be low due to decreasing of the residual capacity of the battery. If it is blinking, replace the battery with a recharged one (If you use the on-board power supply, check the voltage and the terminal of your boat).

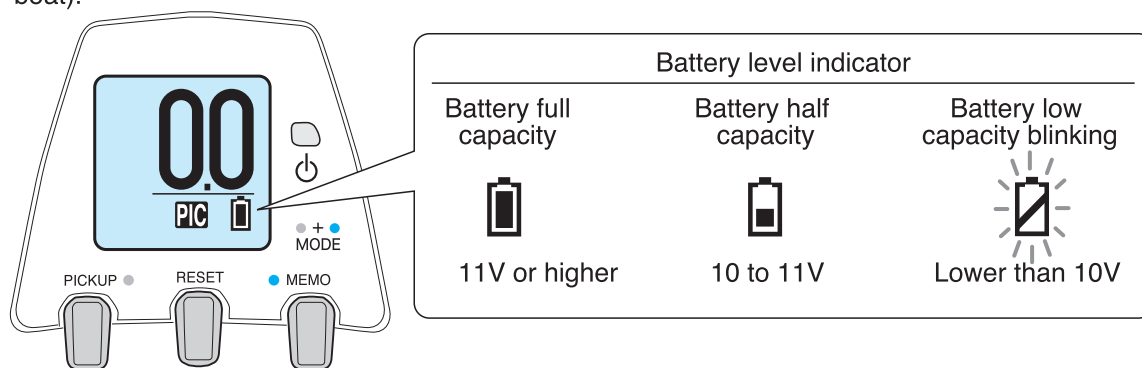

*There may be a slight difference between the reel detection voltage and the actual voltage of the power supply.

*When the battery runs out and the counter display goes out, be sure not to operate your electric reel manually to wind the line and be sure to replace the battery with a recharged one before doing any operations (relating to fishing). Any manual operation in such condition may cause the water depth counter to go out of order, resulting in the tip of fishing rod being broken due to accidentally winding up all the line when you restart an electrical winding later with a replaced battery.

*The indicator LED lights up green while the source voltage is 10 V or more. When the voltage gets below 10 V, it will blink red.

Attention

-When a low battery indication appears, replace the battery with a fully charged one, as operation with low battery may cause problems with electric winding and or IC functions, etc.

Maintenance

About maintenance

This is a washable reel. Wash away salt residue and grit after fishing.

Maintenance procedure

1. Wash the reel with a dish washing detergent and a soft sponge. Do not use solvents.

*Do not use soap or other detergents. Other soaps or solutions may damage the reel both externally and internally.

*Recommended quantity: 1.5 ml per liter of water. The solution may damage the outside coating of the reel and may breakdown the grease inside of the reel creating an overflow of grease.

2. Rinse detergent and dirt away with running water, rinsing the spool very well to get rid of salt. Use warm water, under 30 degrees centigrade.

3. Dry the reel well.

*Loosen the drag when stored.

*Be sure to remove water from inside the handle knob, because water could stay there.

4. Feed oil.

Spray oil on the worm shaft.

*Recommended grease: Genuine reel guard grease

(product code: 2 380027)

Get the specific spray from a fishing-tackle store.

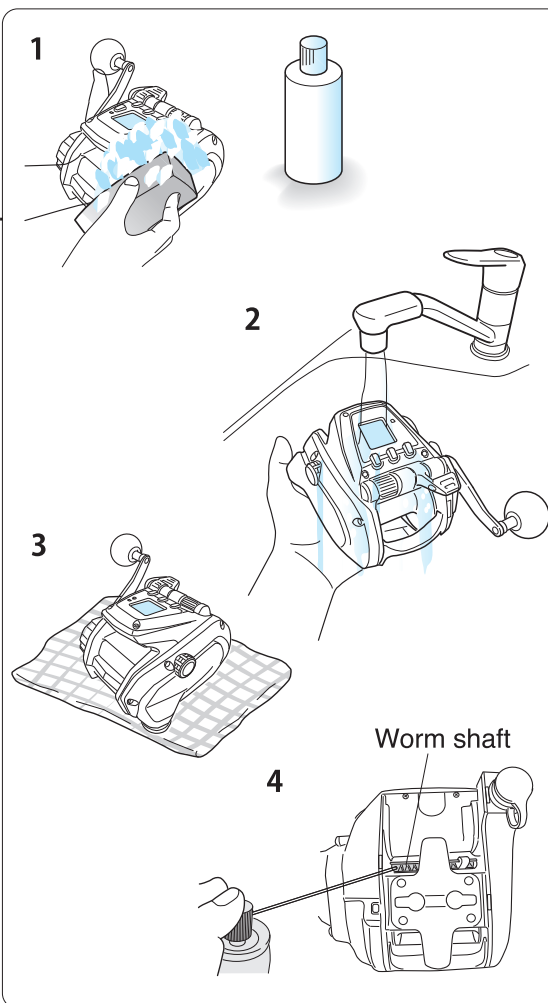

Attention

1. Do not wash with seawater or soak in water.
2. Do not use organic solvents such as benzene and thinner.
3. Do not use a steel brush or abrasive cleanser.
4. The fed oil may spring back and squirt. Do not peer down the worm shaft part.
5. Do not feed oil to water discharge hole.
6. Do not put magnetic force closer to the product main body.

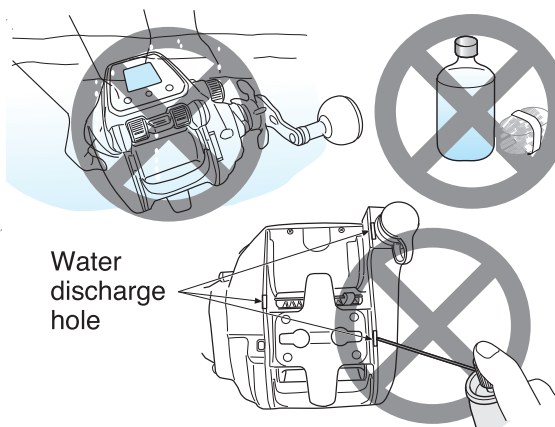

Maintenance

Handling and maintenance of the power cord

Follow the restrictions below to avoid troubles caused by disconnection of power cord and the like. Be sure to use the specific power cord supplied with the reel unit.

*Note that the unit is not compatible with any other power cord.

*Do not modify the power cord. It may cause an unintended failure. Be sure to keep the power cord intact.

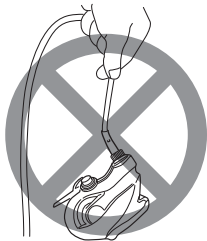

-Do not hang the reel by the power cord.

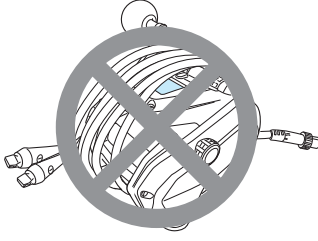

-Do not wind the power cord around the reel body with the connector inserted into the reel.



-Do not wash the power cord.

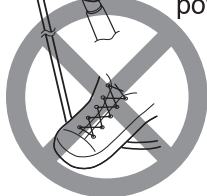

-Note that the inner electric cable may be disconnected or broken despite of no visible damage on the appearance, if you step on the power cord, or if you pull the power cord strongly when it is trapped with cargoes, during use.

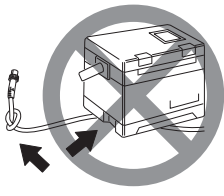

-Do not set heavy items on the power cord, or tie knots in the power cord.



-If any abnormal events occur, including smoke and abnormal odor, stop the use of the power cord and remove it immediately from the battery.

Maintenance of the power cord

-Wipe the power cord with a wet cloth and dry it well.

-Pay special attention to drying the tips, with cover removed.

-Grease the connector after it is dried.

*Recommended grease: SLPW connector grease 501 (Product code: 4 386502) The dedicated grease is available at fishing tackle shops.

-Disconnect the power cord from the reel before storing.

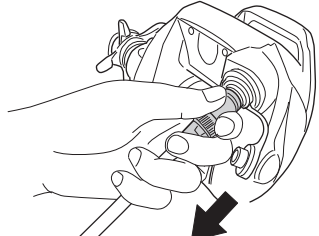

Hold the connector, not the power cord, to pull the power-cord from the reel.

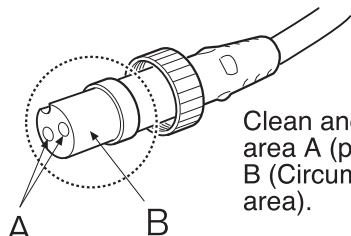

Clean and grease area A (pins) and area B (Circumferential area).

Other maintenance points

-This reel is a precision instrument that employs electric circuitry and motor. Do not disassemble the reel by yourself.

-Cover the power connector on the reel with its protection cap.

-An old cord may cause breakage, short-circuit, or trouble. We recommend to replace the cord every two years or every 60 times of use, in order to maintain the performance of the reel.

Names and functions of each part

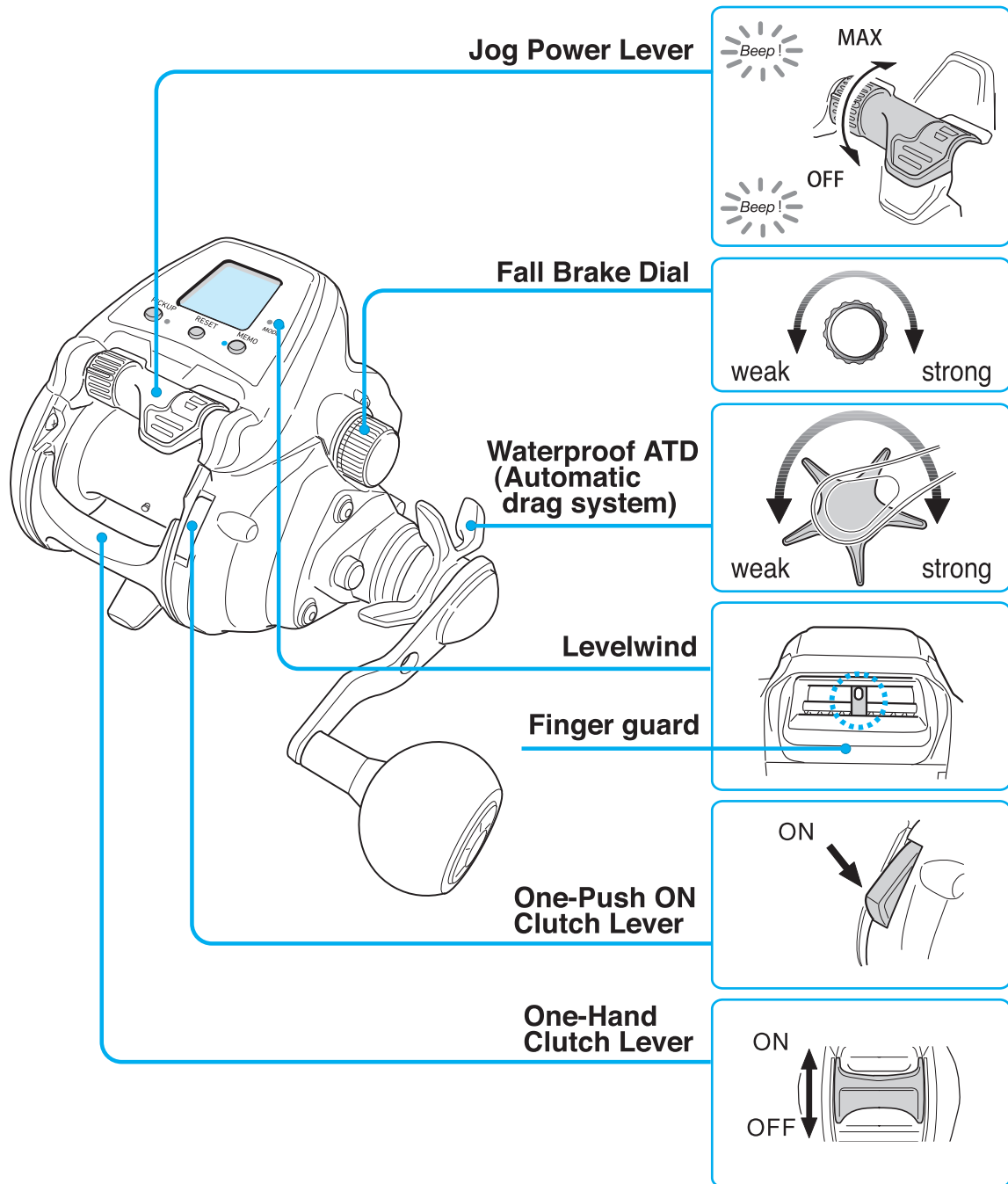

Accessories

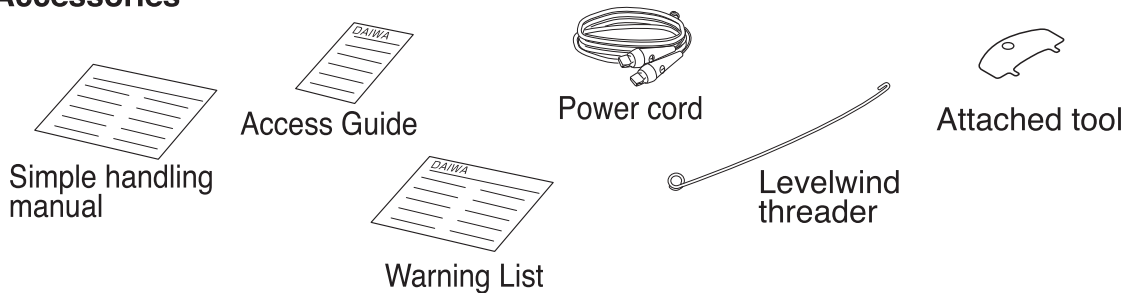

Names and functions of each part

Jog Power Lever

- You can move the right lever by pinching it with your thumb and forefinger.
- Left side rotary lever can be rotated with your thumb.

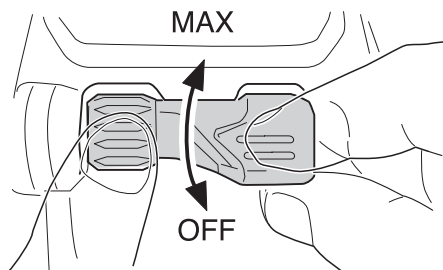

- You can freely adjust the winding power or the winding speed from OFF to MAX by using the lever.
 - Turning the lever forward (toward MAX) will increase the winding power. Turning the lever back (toward OFF) will decrease the power.
 - Check the position of the lever before you start winding. If it is not at OFF position, turn it back to OFF position (an audible alarm will sound to tell you that the lever has backed to the OFF position). Then, push the lever forward to start winding.
 - Note that the lever does not accept your lever manipulation near the pre-set auto stop point for safety reasons.
 - The displayed value for setting by the lever may fluctuate due to winding load fluctuation but it is not abnormal event.
- Lever operation is disabled to prevent the line from being accidentally wound up while the counter indicates 0.0.
- The displayed value for setting by the lever may fluctuate due to winding load fluctuation but it is not abnormal event.

Waterproof ATD (Automatic Drag System) * With a drag click system

- This is designed to provide a mechanism whereby adjusting the star drag allows the spool to slip against a strong pull to avoid line breakage.
1. Set the reel on the rod and put the line through the rod guide before adjusting the drag.
 2. Adjust the tightness of the drag, with the clutch ON, manually pulling the line out from the reel. Normally, adjust the drag allowing the spool to slip before the line breakage (trace line).

One-Hand Clutch Lever

- You can disengage the clutch by slightly pressing down with your thumb.
- ◆While it is turned ON: Turn the handle to wind up the line.
- ◆While it is turned OFF: Spool is free. Turn the handle clockwise to turn ON the clutch.

One-Push ON Clutch Lever

- The clutch turns to ON by pressing the lever when the clutch is OFF.
- You can turn the clutch to ON quickly with your hand holding the rod.

Fall Brake Dial

- This brake system allows you to set instantly the falling speed of the rig by operating the dial. It also prevents backlash (twists caused by a slack line). Adjust the degree of tightening depending on the conditions such as rolling of your boat and the weight of your rig.

Levelwind

- The levelwind allows to ensure an even winding of the line on the spool that is passed through the guide.
- *The line may be wound unevenly on the spool depending on the winding condition in some cases.

Accessories

- Power cord
 - Attached tool
 - Simple handling manual
 - Warranty card (Japan model only)
 - Access Guide
 - Warning List
 - Levelwind threader
- It is used to put the line through the level wind.

Names of the buttons and the display

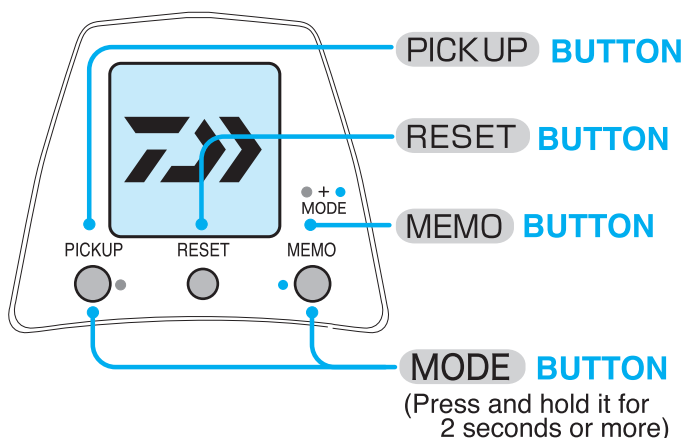

● RESET

- Press the **RESET BUTTON** once always before you start fishing. The auto stop position is set based on the point where you pressed the **RESET BUTTON**.
- Pressing and holding this button for 2 seconds or more allows you to correct the data when the line has broken.

● MEMO

- This button is used to reset the inverse counter or resume the chumming timer.
- Pressing and holding this button allows you to set the auto stop point.
- This button acts as **OK BUTTON** in the Menu screen.

● PICKUP

- The button is used to execute Pickup, Pause and Jigging.
- This button acts as a **RETURN BUTTON** in the Menu screen.

● MODE (Menu)

- Simultaneously pressing and holding both **MEMO BUTTON** and **PICKUP BUTTON** for 2 seconds or more will open the screen where you can set various convenient functions.

Introduction

Note that a 100 m or longer line of which length is known is necessary.

1. Turn ON your reel.

*As for connecting method, see P8 "How to connect the power source".

2. Select your desired language with the Jog Power Lever.

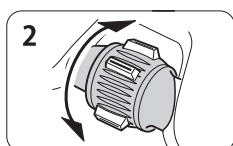

3. Confirm if the language selected is OK and press **OK** (**MEMO BUTTON**).

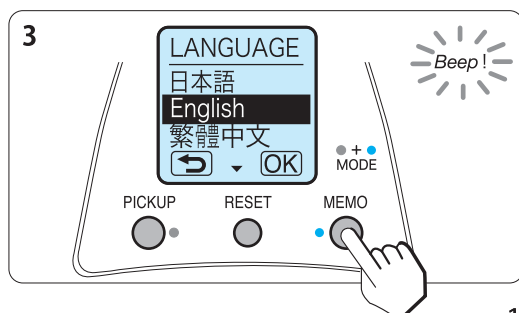

4. Select unit with the Jog Power Lever only when you select "English" and press **OK** (**MEMO BUTTON**).

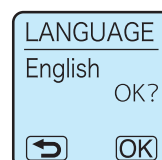

5. If the screen returns to the "Water Depth screen", then the setting is completed.

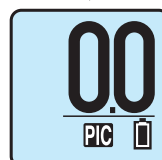
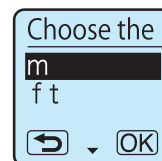

Attention:

The language and unit initially set can be changed afterward from the MENU screen.

*Please refer to the page P47 "Language selection", P48 "Unit setting" for the details.

Functional setting [1. How to operate the Menu screen]

Setting of useful functions

-The Menu provides various useful functions for your fishing.

*Once you have set up a parameter, it is saved in the memory for your next fishing.

(Settings may not be saved in the memory if you turn off the power immediately after setting)

1. When the display shows **0.0** press and hold both **MEMO** **BUTTON** and **PICKUP** **BUTTON** simultaneously for 2 seconds to show the Menu screen.

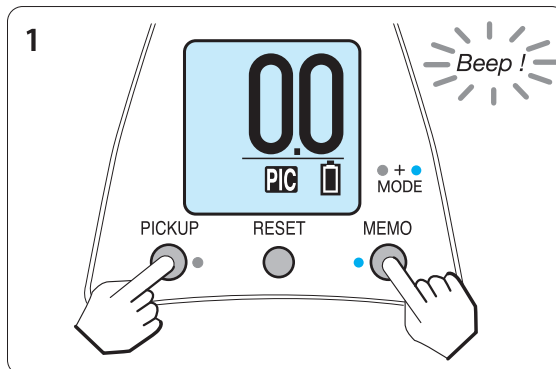

(Water Depth screen)

MEMO **BUTTON** +
PICKUP **BUTTON** (Press and hold)

2. Select a parameter using the Jog Power Lever and press **OK** (**MEMO** **BUTTON**) to go the screen for setting.

*For details on setting of each parameter, please refer to the following pages.

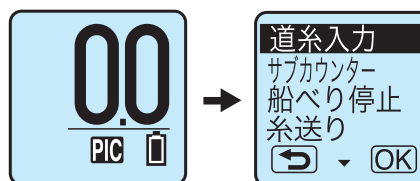

(Water Depth screen)

(Menu screen)



You can select your desired parameter using the Jog Power Lever.

道系入力	→	See P17 - 26
サバカウンター	→	See P27 - 29
船べり停止	→	See P31 and 32
糸送り	→	See P33
チョイ巻/シャクリ	→	See P34 - 37
タイマー巻上	→	See P39
フカセモード	→	See P40 and 41
アラーム音	→	See P47
一定速巻上	→	See P42
水深補正	→	See P43
実釣来歴	→	See P44
Language(言	→	See P47
単位	→	See P48

Functional setting [1. How to operate the Menu screen]

■ Operation in the Menu screen

Here, the Menu screen is used as an example to how to operate the screen.

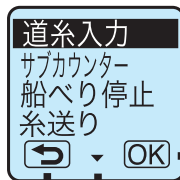

OK BUTTON

This shows that you can confirm the choice here. If you confirm it OK, press the **MEMO BUTTON** to go to the next screen.

If ▲ or ▼ is displayed, you can select any parameter by scrolling the screen with the Jog Power Lever.

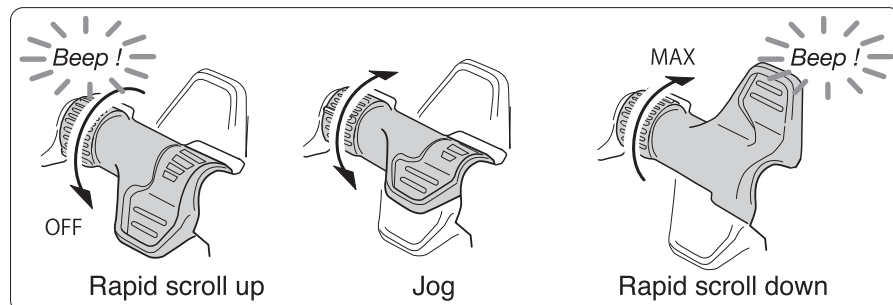

(RETURN) BUTTON

This shows you can return to the previous screen. If you desire to return to the previous screen, press **PICKUP BUTTON**.

3. Once the settings have been completed, return to the Water Depth screen to start fishing.

Functional setting [2. Main line input]

P1 Line Input

This function is convenient when you know the length of the fishing line to be wound on the reel.
(The following example explains how to insert a PE 40lb-500m fishing line.)



Watch out for Burns!

An overly heated motor may cause the frame to become very hot, so do not touch it directly when inserting the main line. Insert the line while holding the frame with a wet towel, etc.

1. Pass the main line through the Level Wind and tie it to the spool.

- *The enclosed threading pin (See P12) facilitates the process.
- *Make sure to tie the line to the line stopper to prevent the line from slipping on the spool.
- *Tighten the drag.

2. Return the Jog Power Lever to OFF.

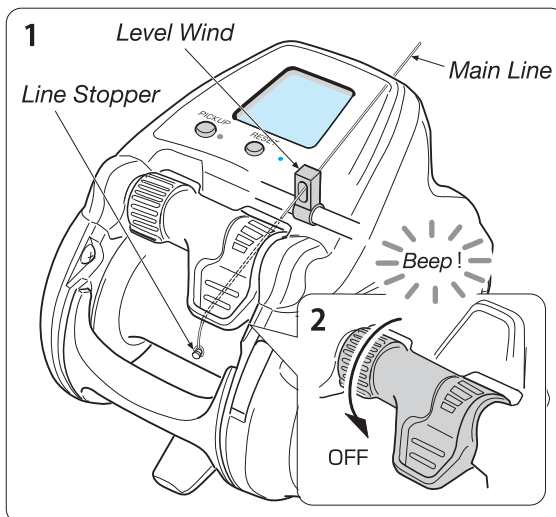

3. Turn on the reel.

- *Please refer to the page 8 “How to connect Power Supply” for the details of the connection method.

3



(The screen when the reel is switched on)

4. When **0.0** is displayed, press and hold the switches **MEMO** **BUTTON** and **PICKUP** **BUTTON** simultaneously for 2 seconds.

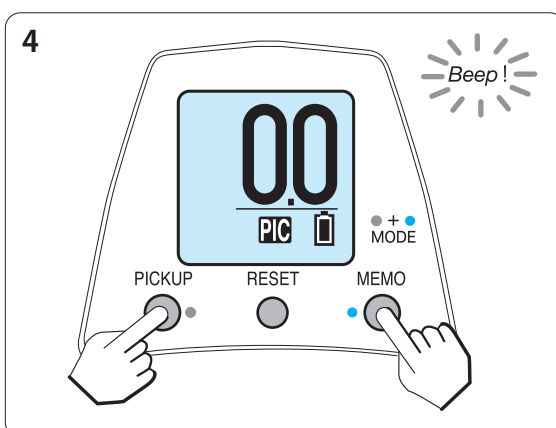

(Water Depth Screen)

Functional setting [2. Main line input]

P1 Line Input

5. Select “Line Input” with the Jog Power Lever and press **OK** (**MEMO BUTTON**).



*By moving the Jog Power Lever, the selected item is highlighted on the screen.

*When the scrolling text 《Do you wish to continue?》 is displayed, press **OK** (**MEMO BUTTON**) one more time.

6. Select “Line Input P1” and then press **OK** (**MEMO BUTTON**).

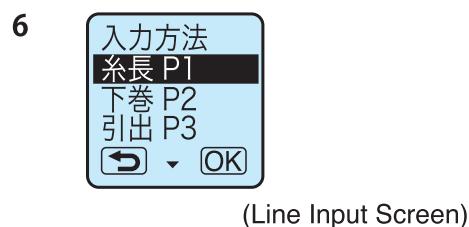
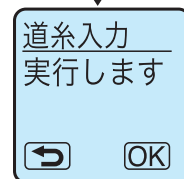
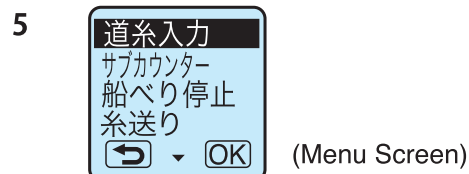

7. After adjusting the tension, turn the Jog Power Lever to the MAX position and then wind the main line **MAX**.

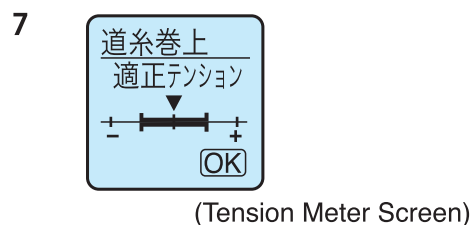
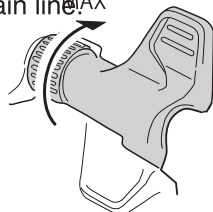

*While winding up the line, try to adjust the tension so that the mark ▼ stays around the screen center.

Attention

- The reel may be damaged if the line touches the finger-guard or the frame. Keep the line from touching these components.
- If you wind up your line at low speed under high tension for a long time indoors, the motor may overheat anomaly. This may cause a failure of the reel. Before setting up, shift the Jog Power Lever to the MAX position. While actual fishing outdoors, there is no need to worry about overheat problem because the motor is cooled down by seawater, etc.

Functional setting [2. Main line input]

P1 Line Input

8. When winding is complete, turn the Jog Power Lever back to the OFF position and then press **OK** (**MEMO** **BUTTON**) .

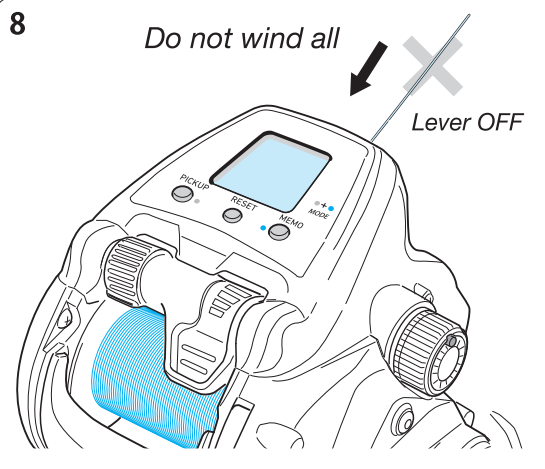
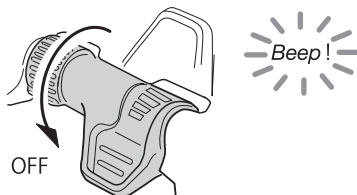

Attention

- Do not wind all the line. Before winding up all of the line, turn the Jog Power Level to the OFF position and then wind up the remaining line manually with the handle. Winding up all may cause an error with the counter.
- This winding method cannot be applied to lines thinner than PE 20lb.
- When winding a PE 20lb line, the line may enter the gap between the spool and the frame if wound close to the spool's outer diameter; so it is advisable to wind the line up to about 1mm inside the outer edge of the spool.

9. Select the line length with the Jog Power Lever and then press **OK** (**MEMO** **BUTTON**) .

*The illustration shows a case of inserting 500m.

*The default value is set at 300m.

*The value can be set for every 10m.

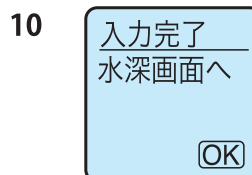
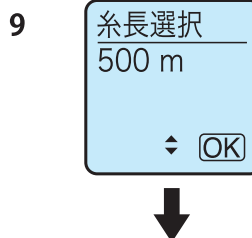
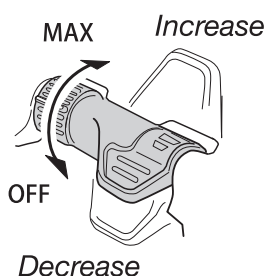

10. When "Complete" is displayed on the screen, press **OK** (**MEMO** **BUTTON**) and the display will return to the water depth screen to complete inserting the line.

*When "Error" is displayed while inserting the line, press **OK** (**MEMO** **BUTTON**) to return to the water depth screen and re-start the process from the beginning.

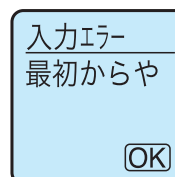

Functional setting [2. Main line input]

P2 Backing line input

Note that a 100 m or longer line of which length is known is necessary.



Watch out for Burns!

An overly heated motor may cause the frame to become very hot, so do not touch it directly when inserting the main line. Insert the line while holding the frame with a wet towel, etc.

1. Pass the main line through the Level Wind and tie it to the spool.

*The enclosed threading pin (See P12) facilitates the process.

*Make sure to tie the line to the line stopper to prevent the line from slipping on the spool.

*Tighten the drag.

*If you have already completed winding of the backing line, skip this step and go to the next step.

2. Return the Jog Power Lever to OFF.

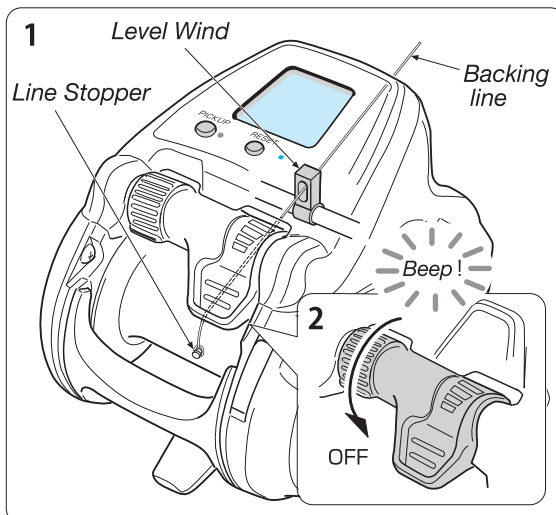

3. Turn on the reel.

*Please refer to the page 8 “How to connect Power Supply” for the details of the connection method.

3



(The screen when the reel is switched on)

4. When **0.0** is displayed, press and hold the switches **MEMO** **BUTTON** and **PICKUP** **BUTTON** simultaneously for 2 seconds.

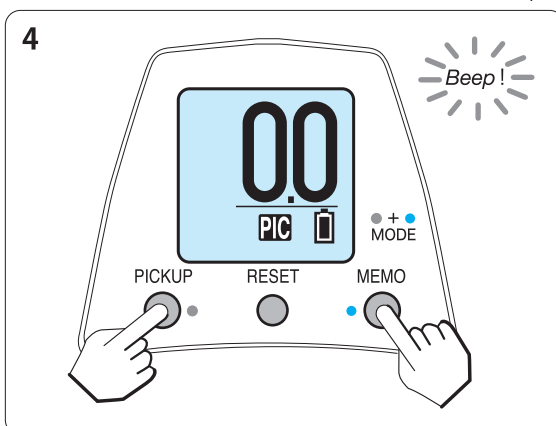

(Water Depth Screen)

Functional setting [2. Main line input]

P2 Backing line input

5. Select "Line Input" with the Jog Power Lever and press **OK** (**MEMO** **BUTTON**).



*By moving the Jog Power Lever, the selected item is highlighted on the screen.

*When the scrolling text «Do you wish to continue?» is displayed, press **OK** (**MEMO** **BUTTON**) one more time.

6. Select "Backing line P2" and then press **OK** (**MEMO** **BUTTON**).

7. Wind up the backing line. If winding of the backing line is completed, press **OK** (**MEMO** **BUTTON**).

* If you have already completed winding of the backing line, skip this step and go to the next step by pressing **OK** (**MEMO** **BUTTON**).

8. Firmly tie the main line to the backing line.

9. After adjusting the tension, turn the Jog Power Lever to the MAX position. and wind the main line up until the remaining line is 100 m, as checking the line color.

*While winding up the line, try to adjust the tension so that the mark ▼ stays around the screen center.

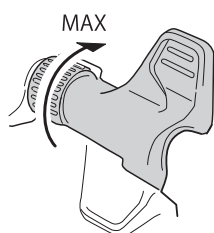

5

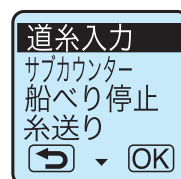

(Menu Screen)

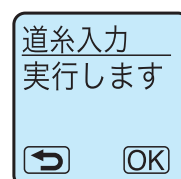

6

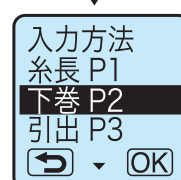

(Screen to select Backing Line Input)



7

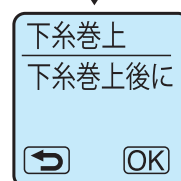

(Screen shown backing line winding)



8

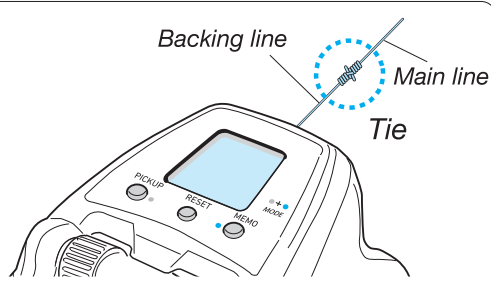

9

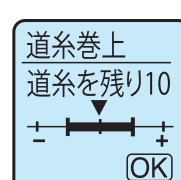

(Screen shown main line winding)



Functional setting [2. Main line input]

P2 Backing line input

Attention

-The reel may be damaged if the line touches the finger-guard or the frame. Keep the line from touching these components.
-Winding the line indoors for a prolonged period at a low speed with an elevated tension may cause the motor to overheat and thus fail. When setting-up, turn the Power Lever to the MAX position. While actual fishing in outdoors, there is no need to worry about overheat problem because motor is cooled down by seawater, etc.

10. When winding is completed, turn the Jog Power Lever back to the OFF position and then press **OK** (**MEMO** **BUTTON**).

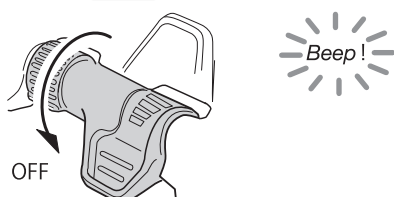

11. After adjusting the tension, turn the Jog Power Lever to the MAX position. Wind on another 50 m of line as checking the line color.

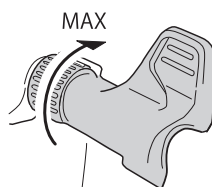

11

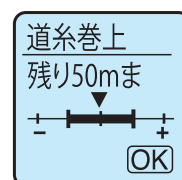

(Screen shown main line winding)



*While winding up the line, try to adjust the tension so that the mark ▼ stays around the screen center.

12. When winding is completed, turn the Jog Power Lever back to the OFF position and then press **OK** (**MEMO** **BUTTON**).

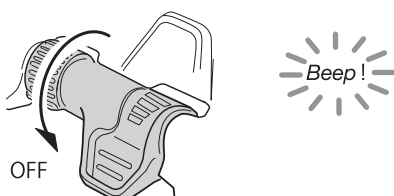

13

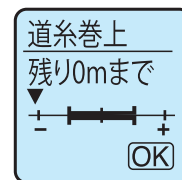

(Screen shown main line winding)



13. After adjusting the tension, turn the Jog Power Lever to the MAX position and wind the main line up to its end as checking the line color.

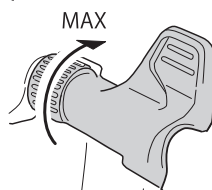

*While winding up the line, try to adjust the tension so that the mark ▼ stays around the screen center.

Functional setting [2. Main line input]

P2 Backing line input

Attention

- Do not wind all the line. Before winding up all of the line, turn the Jog Power Level to the OFF position and then wind up the remaining line manually with the handle. Winding up all may cause an error with the counter.
- This winding method cannot be applied to lines thinner than PE 10lb.
- When winding a PE 10 to 20lb line, the line may enter the gap between the spool and the frame if wound close to the spool's outer diameter; so it is advisable to wind the line up to about 1mm inside the outer edge of the spool.

14. When winding is completed, turn the Jog Power Lever back to the OFF position and then press **OK** (**MEMO** **BUTTON**).

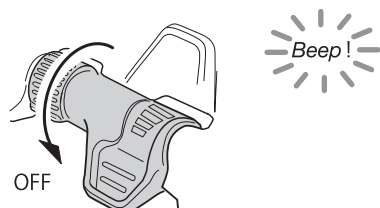

15. When "Complete" is displayed on the screen, press **OK** (**MEMO** **BUTTON**) to return to the Water Depth screen and complete the data input of the line.

* If "Error" appears on the screen while inputting the line data, press **OK** (**MEMO** **BUTTON**) to return to the Water Depth screen and re-start the process from the beginning.

15

入力完了
水深画面へ

OK

入力エラー
最初からや

OK

Functional setting [2. Main line input]

P3 Line re-input

This option allows you to re-enter the line data, pulling out the line after it has been completely wound up onto the reel.

Note that it is necessary that you know the line length and that it is greater than 100 m.

1. Pass the main line through the Level Wind and tie it to the spool.

- *The enclosed threading pin (See P12) facilitates the process.
- *Make sure to tie the line to the line stopper to prevent the line from slipping on the spool.
- *Tighten the drag.

2. Return the Jog Power Lever to OFF.

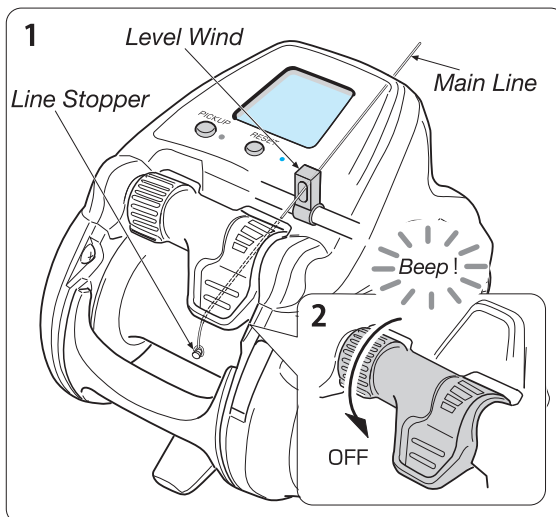

3. Turn on the reel.

- *Please refer to the page 8 “How to connect Power Supply” for the details of the connection method.



↓ (The screen when the reel is switched on)

4. When 0.0 is displayed, press and hold the switches MEMO BUTTON and PICKUP BUTTON simultaneously for 2 seconds.

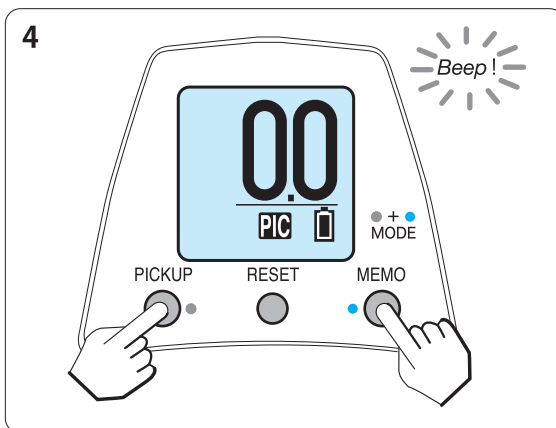

(Water Depth Screen)

Functional setting [2. Main line input]

P3 Line re-input

5. Select "Line Input" with the Jog Power Lever and press **OK** (**MEMO BUTTON**).



*By moving the Jog Power Lever, the selected item is highlighted on the screen.

*When the scrolling text «Do you wish to continue?» is displayed, press **OK** (**MEMO BUTTON**) one more time.

6. Select "Line re-input P3" and then press **OK** (**MEMO BUTTON**).

7. Adjust the tension and turn the Jog Power Lever to the MAX position to completely wind up your line.

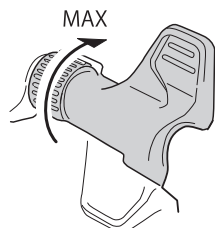

*While winding up the line, try to adjust the tension so that the mark ▼ stays around the screen center.

*When you have already completed winding the main line, simply press **OK** (**MEMO BUTTON**).

5

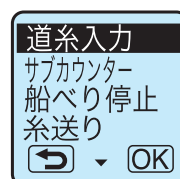

(Menu Screen)

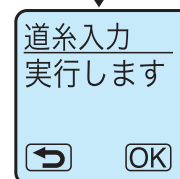

6

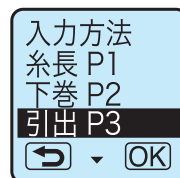

(Line Input Screen)

7

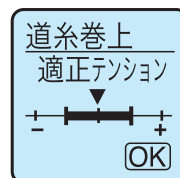

(Tension Meter Screen)

Attention

- The reel may be damaged if the line touches the finger-guard or the frame. Keep the line from touching these components.
- If you wind up your line at low speed under high tension for a long time indoors, the motor may overheat anomaly. This may cause a failure of the reel. Before setting up, shift the Jog Power Lever to the MAX position. While actual fishing outdoors, there is no need to worry about overheat problem because the motor is cooled down by seawater, etc.

Functional setting [2. Main line input]

P3 Line re-input

8. When winding is completed, turn the Jog Power Lever back to the OFF position and then press **OK** (**MEMO** **BUTTON**).

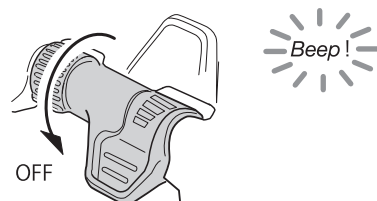

9. Pull 50 m of the line out of the reel as checking the line color and press **OK** (**MEMO** **BUTTON**).

10. Pull out another 50 m of the line out of the reel as checking the line color and press **OK** (**MEMO** **BUTTON**).

11. When "Complete" is displayed on the screen, press **OK** (**MEMO** **BUTTON**) to return to the Water Depth screen. Wind up the line that you pulled out from the reel. If you wound it up, the procedure is completed.

*If "Error" appears on the screen while inputting the line data, press **OK** (**MEMO** **BUTTON**) to return to the Water Depth screen and re-start the process from the beginning.

9

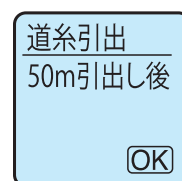

(Screen shown main line pulled out)

10

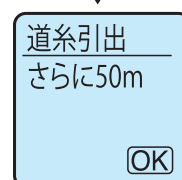

(Screen shown main line pulled out)

11

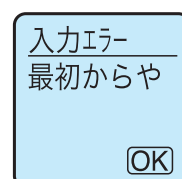
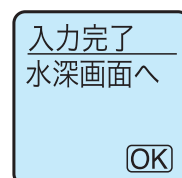

Attention

- Do not wind all the line. Before winding up all of the line, turn the Jog Power Level to the OFF position and then wind up the remaining line manually with the handle. Winding up all may cause an error with the counter.
- This winding method cannot be applied to lines thinner than PE 20lb.
- When winding a PE 20lb line, the line may enter the gap between the spool and the frame if wound close to the spool's outer diameter; so it is advisable to wind the line up to about 1mm inside the outer edge of the spool.

Functional setting [3. Sub counter]

Sub counter can be displayed below the Water Depth counter.

You can select one from 3 options; i.e. "Inverse counter", "Winding speed" and "Time to wind up"

*Sub counter is set to "No display" by default.

Inverse counter

You can easily identify a shelf in the strike zone for fishing with the distances from the boat and from the bottom by two counters.

1. Press and hold both **MEMO** **BUTTON** and **PICKUP** **BUTTON** simultaneously for 2 seconds to go to the Menu screen.
2. Select the option "Sub counter" with the Jog Power Lever and press **OK** (**MEMO** **BUTTON**). Then, select "Inverse counter" and press **OK** (**MEMO** **BUTTON**).

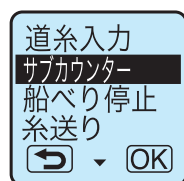
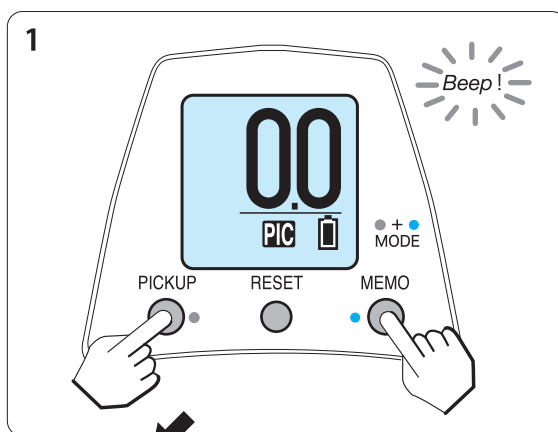
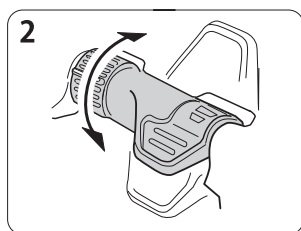

(Menu screen)

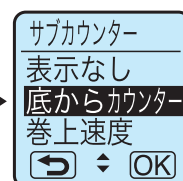

(Sub counter)

3. The Inverse counter will appear below the Water Depth counter.
4. When you press the **MEMO** **BUTTON** at the depth in the strike zone for fishing after lowering the terminal rig, including the bottom and your aiming shelf, the Inverse counter displays **0.0** as the reference point for showing the distance from such point.

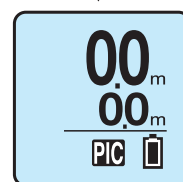

Functional setting [3. Sub counter]

Winding speed

This option displays the winding speed actually measured while the electrical winding up is in action.

1. Press and hold both **MEMO** **BUTTON** and **PICKUP** **BUTTON** simultaneously for 2 seconds to go to the Menu screen.
2. Select the option "Sub counter" with the Jog Power Lever and press **OK** (**MEMO** **BUTTON**). Then, select "Winding speed display" and press **OK** (**MEMO** **BUTTON**).

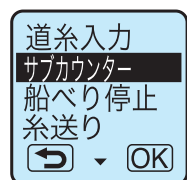
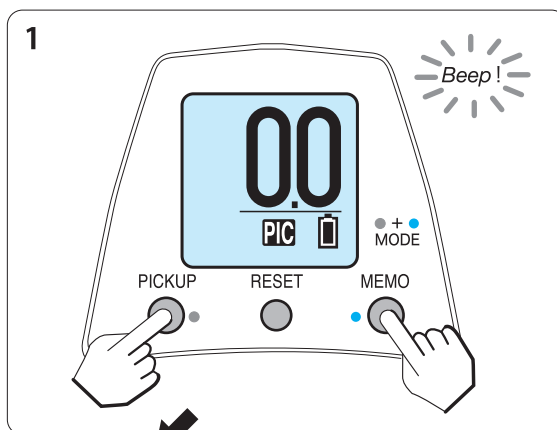
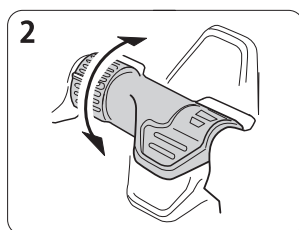

(Menu screen)

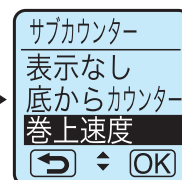

(Sub counter)

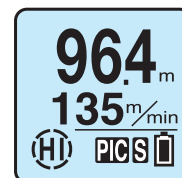

(Example of display)

3. The winding speed will be displayed below the Water Depth counter.

*This is displayed only while electrical winding up is in action.

*Display of winding speed is disabled while the Drift mode is set to ON.

Functional setting [3. Sub counter]

Time to wind up

This option displays the timer roughly indicating the remaining time to auto stop at the boat side.

*A gap in the time may be caused by the fluctuation of the actual winding speed.

1. Press and hold both **MEMO** **BUTTON** and **PICKUP** **BUTTON** simultaneously for 2 seconds to go to the Menu screen.
2. Select the option "Sub counter" with the Jog Power Lever and press **OK** (**MEMO** **BUTTON**). Then, select "Time to wind up" and press **OK** (**MEMO** **BUTTON**).

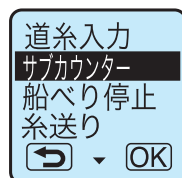
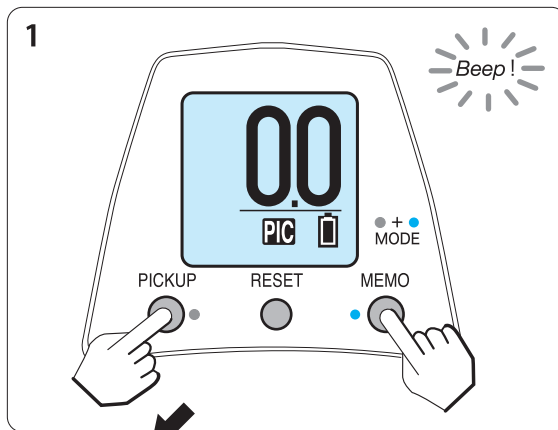
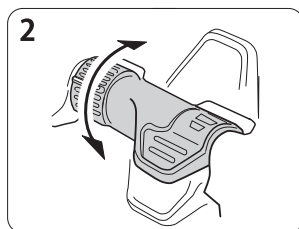

(Menu screen)

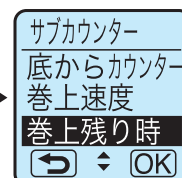

(Sub counter)

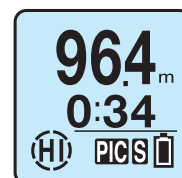

(Example of display)

3. The time to wind up will be displayed below the Water Depth counter.

*This is displayed only while electrical winding up is in action.

*Display of winding speed is disabled while the Drift mode is set to ON.

Functional setting [4. Before start fishing]

Water surface zero setting

Before you start fishing, always perform this zero setting to identify a more accurate depth of the strike zone for fishing.

1. Connect the reel to the battery. Pass the line through all the guides, and prepare your terminal rig.

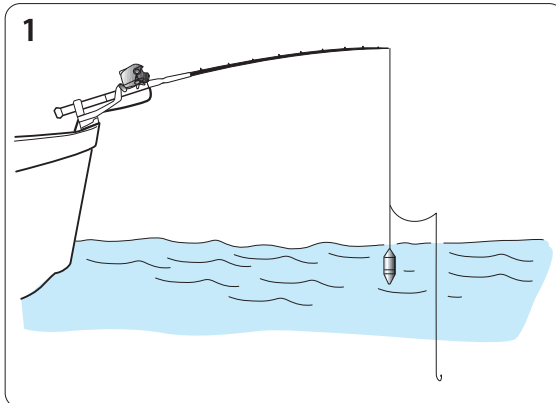

2. Lower the terminal rig to the water surface and press the **RESET** **BUTTON**.

-The display resets to **0.0** and the indicator lamp **S** (auto stop) will turn on. Then the setup has been completed.

While electrical winding up is in action, winding will automatically stop at 2 m before auto stop at the boat side.

*If this "Water surface zero setting" is not made, winding will automatically stop at 5 m before the auto stop point for safety.

*After auto stop at the boat side, the Jog Power Lever cannot be used to wind up the line in order to prevent the rig from being wound up accidentally.

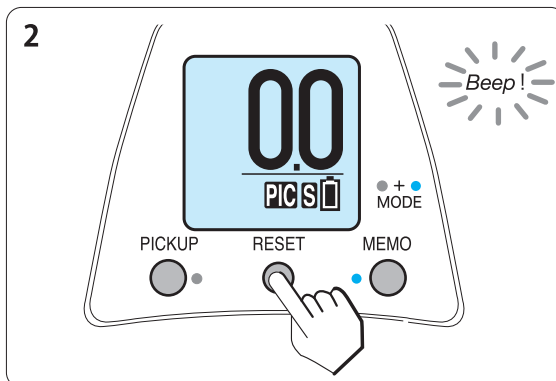

Attention

-When new line is wound up, or when line has been pulled under heavy tension, line stretch may cause a gap in the auto stop point at the boat side. Simply reset the surface setting to set it to zero.

-Depending upon the rolling of the boat or sinker weight, auto stop point can overrun slightly. Should this happen, increase the depth of the auto stop.

-Fishing at a depth over 100 m with a load largely fluctuating may cause a gap in the stop point. Thus, the terminal rig may be accidentally wound up and the rod may be broken. In such fishing, it is recommended to have sufficient margin in setting of auto stop point to avoid such events.

-As this model is set to high winding speed, water surface zero setting is designed to disable power winding at the depth of 2 m and the remaining line will not be automatically wound up to prevent accidental winding due to overrun.

If the main line is broken

-Should your line break, revise data as follows.

Revise the data of the broken line. Wind the line to the rod tip while the reel is powered on. Then, press the **RESET** **BUTTON** for 2 seconds or more. When the display shows **0.0**, then your re-adjustment is completed.

*The line data will be overwritten (revised) by the procedure described above.

*Do not press and hold the **RESET** **BUTTON**, except for data correction of a broken line; it may cause an error in the counter.

Functional setting [5. Auto stop]

Adjustable auto stop setting

The auto stop point can be set to meet your own specific needs and ease your preparatory works such as checking and changing of baits and sinkers.

-You can set the auto stop point by setting the adjustable depth within the range 1 to 5 m from the point where you press **RESET** **BUTTON** (in 10 cm increments).

Especially in case of chumming, it is recommended to set the adjustable auto stop point so that a chumming bait sinker comes to your hand side when you raise your rod tip, for more convenient checking and changing of baits and sinkers.

Note that it is designed not to allow you to set the auto stop point to any value below 1 m for safety reasons.

-In the case when you feel the auto stop point comes down due to line stretch, simply reset the counter to zero at the water surface.

-Note that the Jog Power Lever may not be allowed to manipulate around the auto stop point for safety reasons.

There are two different ways to set the adjustable auto stop; setting in the Menu screen and setting in the Water Depth screen.

● Setting in the Menu screen

1. Press and hold both **MEMO** **BUTTON** and **PICKUP** **BUTTON** simultaneously for 2 seconds to go to the Menu screen.

2. Select "Auto Stop" with the Jog Power Lever and press **OK** (**MEMO** **BUTTON**).

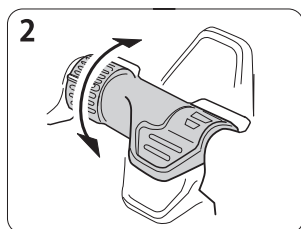

3. Then, select your desired auto stop point with the Jog Power Lever and press **OK** (**MEMO** **BUTTON**) to return to the Water Depth screen.

*You are not allowed to set the adjustable auto stop if you have not yet set the water surface zero setting. Be sure to carry out the water surface zero setting.

4. If you carry out electrical winding up after lowering the terminal rig, your terminal rig will automatically stop at the pre-set point.

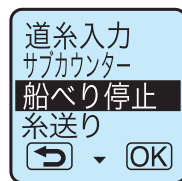
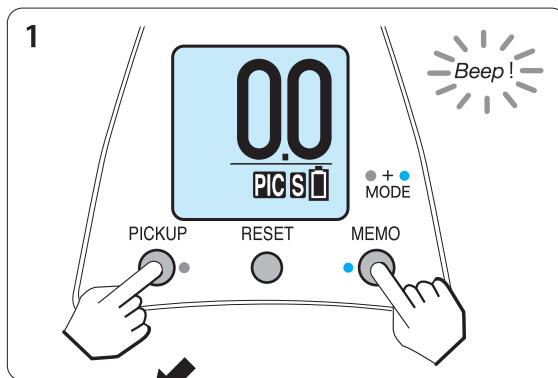

(Menu screen)

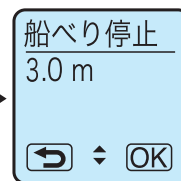

(Example of display)

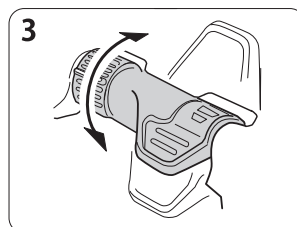

Functional setting [5. Auto stop]

● Setting in the Water Depth screen

1. While the reel is powered on and your terminal rig is on the water surface, press the **RESET** **BUTTON** (water surface zero setting).

The display will show **0.0** .

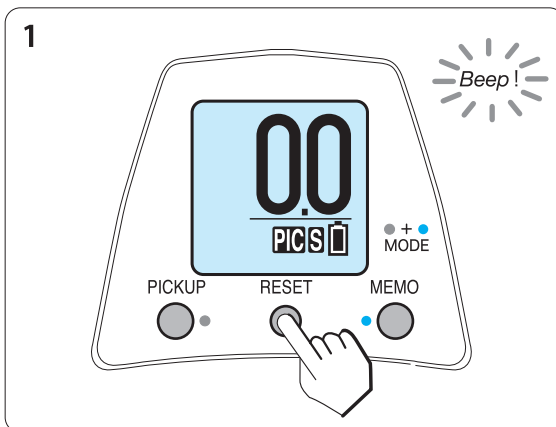

2. Raise your rod tip and pull the line out adjusting the line length from the rod tip so that you can reach the rig easily.

In the figure, its length is 1.5 m.

Use

Chumming

It is recommended to set the auto stop so that a chumming bait sinker comes to your hand side when you raise your rod tip, for more convenience for checking and changing of baits and sinkers.

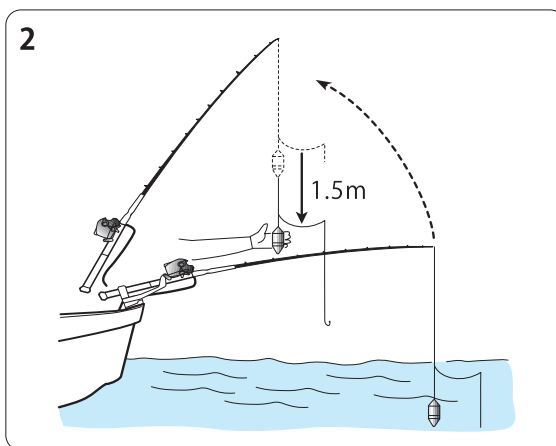

3. When the line length has been properly adjusted, press and hold the **MEMO** **BUTTON** for about 2 seconds.

When the indicator lamp **S** (auto stop at boat) blinks, the setting is completed.

*Auto stop is set to 2.0 m by default.

(If **RESET** **BUTTON** is not pressed, the reel stops at 5.0 m)

*If the setting is completed, the indicator lamp **S** (auto stop at boat) will blink.

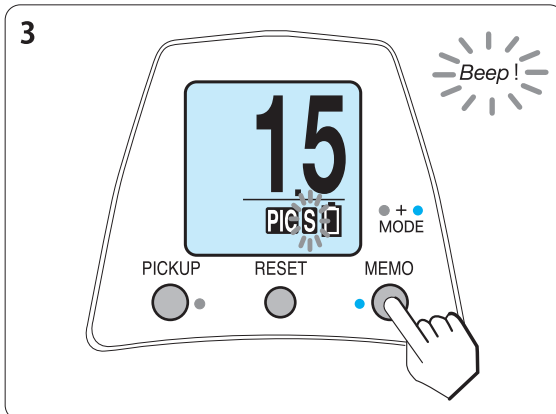

4. The electrical winding up automatically stops at the pre-set point. So, raise the rod tip to bring your terminal rig to your hand side.

Functional setting [6. Line feeding function]

Line feeding function

Motor gear reverses to allow the spool to rotate in the direction of the line going out that assists line feeding.

Line Feeding

1. Press and hold both **MEMO BUTTON** and **PICKUP BUTTON** simultaneously for 2 seconds to display the MENU screen.
2. Select "Line Feeding" with the Jog Power lever and press **OK** (**MEMO BUTTON**). Then, select "ON" with the Jog Power Lever and press **OK** (**MEMO BUTTON**) to complete the setting.

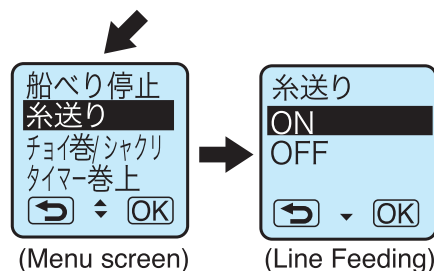
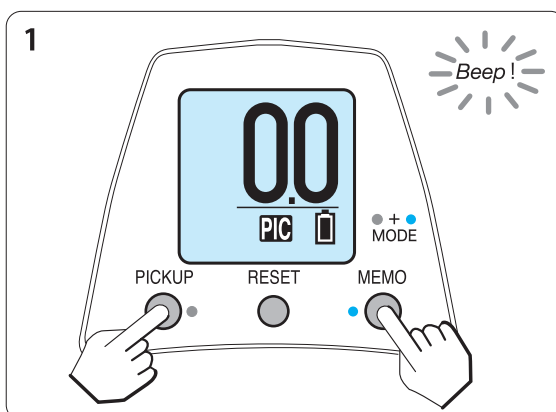
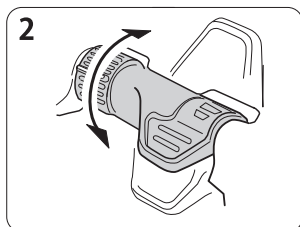

- When you turn the Clutch to OFF and throw your terminal rig into the water, the line feeding function will be activated from the preset auto stop depth plus 2.5 m.
- The line feeding output will be automatically adjusted according to the speed of the spool rotation with the terminal rig dropping.
- If the Jog Power Lever moved while feeding the line, the line feeding will be stopped.
- Once the line feeding is stopped for more than a certain time due to backlash etc., it will not restart.
- When Line Feeding is set to ON, **FRE** (line feeding) will be displayed.
- **FRE** blinks on the display during a line feeding operation.

Attention

- If you turn the Clutch to ON during the line feeding (motor in operation), the line may get wound.
- If you throw your terminal rig into the water with the Line Feeding set to ON in the condition where the boat intensely moves up and down or the wind is strong, backlash easily occurs, which may interfere the smooth dropping of your terminal rig.
- If you set the Line Feeding to ON while the Drift mode is set to ON, the Drift mode will be automatically turned to OFF.

Functional setting [7. Pickup / Pause]

Pickup

This is very useful. You can wind the line by the electric reel only while pressing the **PICKUP BUTTON**. The pickup speed is set to 15 by default. You can change it in the Menu screen.

Pause

This is very useful. You can pause the electrical winding up only while pressing the **PICKUP BUTTON**. When you release the button, the reel restarts winding up at the speed specified by using the Jog Power Lever.

Pickup / Pause setting

1. Press and hold both **MEMO BUTTON** and **PICKUP BUTTON** simultaneously for 2 seconds to go to the Menu screen.
2. Select "Pickup/Jigging" with the Jog Power Lever and press **OK** (**MEMO BUTTON**). Then, select "Pickup" from the Pickup/Jigging options and press **OK** (**MEMO BUTTON**).

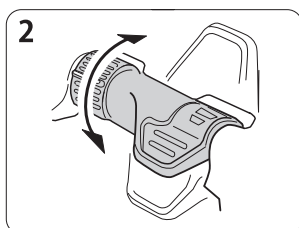

3. Set the speed with the Jog Power Lever.

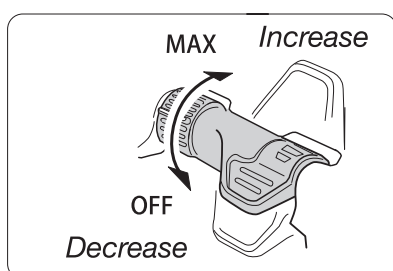

You can set the speed to any value in the range from 0 to Hi (in the figure, the speed is set to 20). Set it to 1 to Hi to make the reel in the Pickup mode or otherwise set it to 0 to make the reel in the Pause mode.

4. Press **OK** (**MEMO BUTTON**) to return to the Water Depth screen. Now, the setting is completed.

PIC will be displayed on the counter.

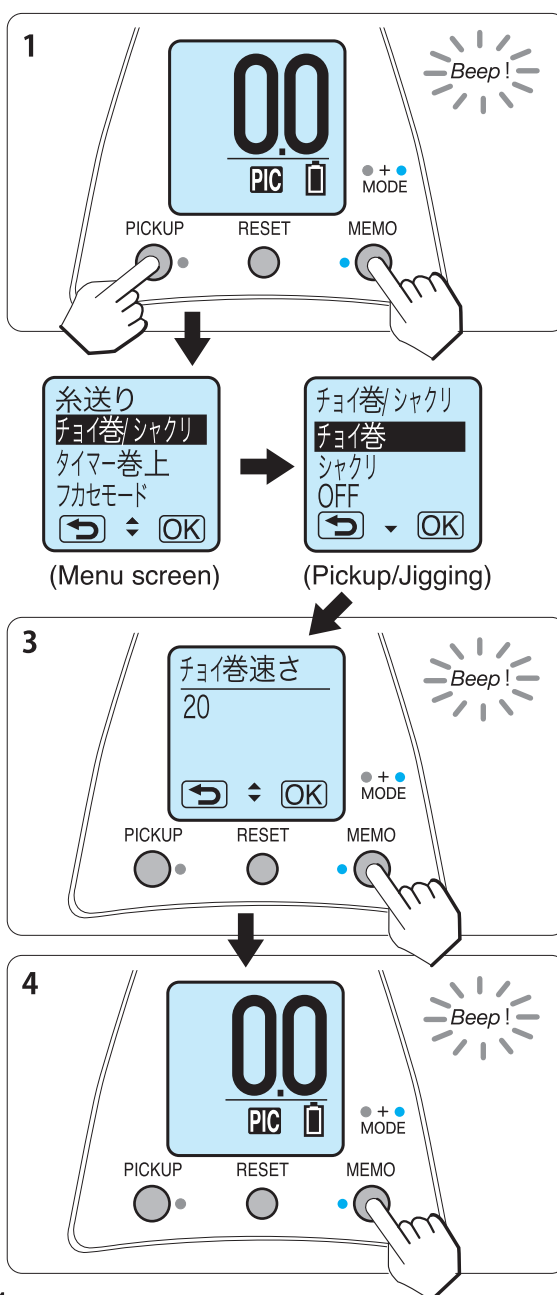

Functional setting [8. Jigging]

Jigging

This function is useful to let the reel control the line so as to slack and jig the line to attract fish. Once you have set up this function, the reel starts jigging when you press the **PICKUP BUTTON**.

1. Press and hold both **MEMO BUTTON** and **PICKUP BUTTON** simultaneously for 2 seconds to go to the Menu screen.

2. Select "Pickup/Jigging" with the Jog Power Lever and press **OK** (**MEMO BUTTON**). Then, select "Jigging" and press **OK** (**MEMO BUTTON**).

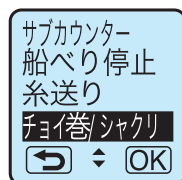
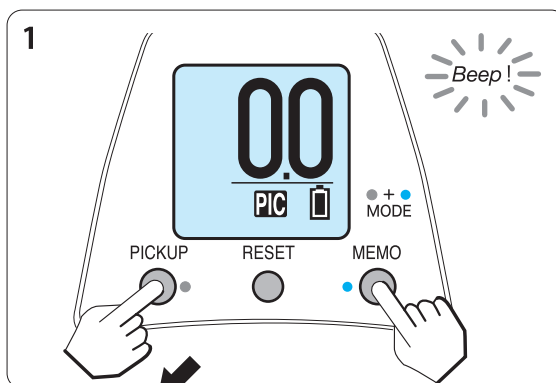
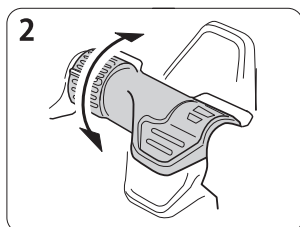

(Menu Screen)



(Pickup/Jigging)

3. Select any pattern from the Jigging Pattern options with the Jog Power Lever and press **OK** (**MEMO BUTTON**).

You can select the number of steps per a length of the line wound up in a single cycle of jigging.

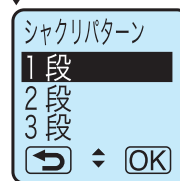
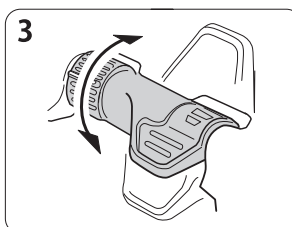

(Jigging Patterns)

One-step jigging	Two-step jigging	Three-step jigging	Random jigging
			<p>Random jigging is the method in which the number of jigging steps from 1 to 3 is randomly and automatically selected by the IC system to attract fish. It is a marvelous auto jigging mechanism.</p>

A : 4 seconds stop B : 0.4 seconds stop

*In the figure, a rod is used to represent the jigging but actually the line is jigged and wound up by the reel.

Functional setting [8. Jigging]

4. Set the Jigging length with the Jog Power Lever and press **OK** (**MEMO** **BUTTON**) .

You can select the length of the line wound up in a single cycle of jigging (the length may slightly overrun its preset length depending on the sinker or winding speed).

-The jigging length can be set to any value between 0.1 and 10.0 m.

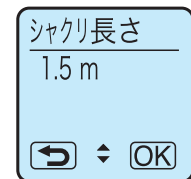
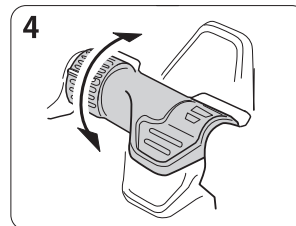

(Example of display)

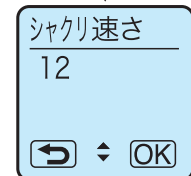
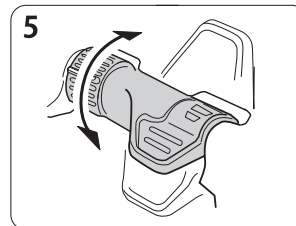

(Example of display)

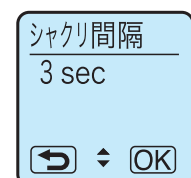
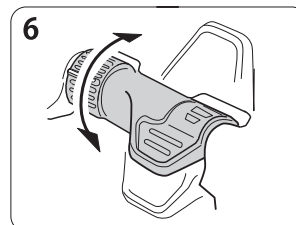

(Example of display)

6. Set the Jigging Interval with the Jog Power Lever and press **OK** (**MEMO** **BUTTON**) .

You can choose the "Interval Time (waiting time)" between jigs.

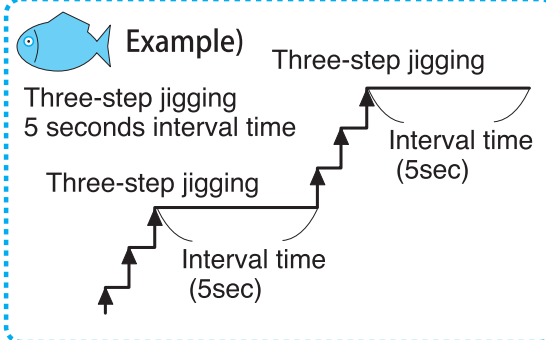

Attention

If the time preset to "chumming timer winding time" is shorter than the jigging time (in seconds), then the chumming timer setting takes priority to wind up the line.

7. Set the jigging range with the Jog Power Lever and press **OK** (**MEMO** **BUTTON**) to return to the Water Depth screen. Now, the setting is completed.

You can select the range of jigging.

*If you have set the range to OFF, jigging will be continuously performed to the auto stop point.

*If you have set the range to any value, jigging will be performed only for the specified range.

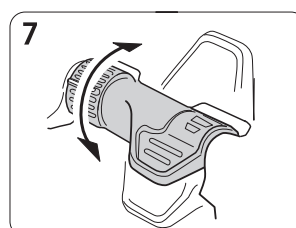

(Example of display)

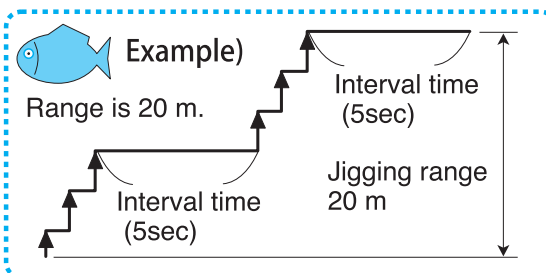

Functional setting [8. Jigging]

8. After throwing your terminal rig into the water, press **PICKUP** **BUTTON** to start jigging.

- **JIG** will be displayed on the counter, and the **JIG** (jigging) indication blinks during wind-up.
- If you have set the Jigging Speed to "0", adjust the Jigging Speed with the Jog Power Lever.
- If you press the **PICKUP** **BUTTON** during jigging, the jigging **PICKUP** **BUTTON**

Functional setting [9. Chumming Timer]

Chumming Timer

The display shows precisely the time having elapsed every since the rig was dropped. It is very helpful to determine the pace for checking and changing of baits and sinkers.

- The display shows the time having elapsed since lowering of the rig started. You can roughly estimate the timing to chum or collect the rig.
- The Chumming Timer automatically starts from 7.1 m displayed on the water surface counter after throwing your terminal rig into the water.
- *The time is indicated in seconds if the remaining time is less than 60 seconds It is indicated in minutes if the remaining time is not less than 1 minute.
- *The timer function may not be reset.
- *For proper use of the timer, your next terminal rig feeding shall be made only after winding it up to the auto stop position at the boat side.

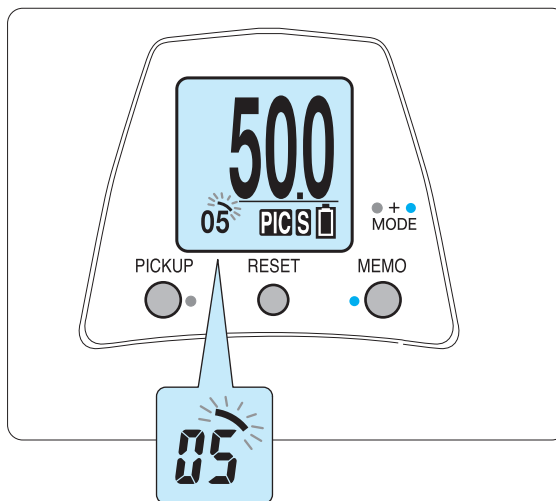

Attention

If you press the **MEMO** **BUTTON** while chumming is in process, the timer indication will start from **0** .

Functional setting [10. ChummingTimer winding]

Chumming Timer Winding

Professional fishing techniques of checking and changing of baits and sinkers for all levels including beginners! Once you have set the waiting time simply, the reel automatically starts winding up. You can enjoy fishing more effectively and easily.

-If you have set the waiting time for a single chumming to 5 minutes, the reel will automatically start winding up at a high speed to allow you to check and change baits and sinkers after preset 5 minutes have passed.

1. Press and hold both **MEMO BUTTON** and **PICKUP BUTTON** simultaneously for 2 seconds to go to the Menu screen.
2. Select the "Timer Winding" with the Jog Power Lever and press **OK** (**MEMO BUTTON**) .

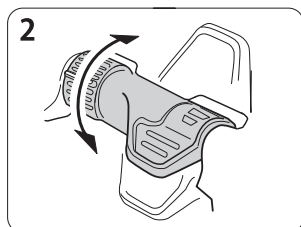

3. Select the waiting time (in minute) for checking and changing of baits and sinkers with the Jog Power Lever.

Turn the Jog Power Lever upward to increase the value. Or, turn it downward to decrease the value. (In the figure, the waiting time is set to 5 minutes)

4. Press **OK** (**MEMO BUTTON**) . If the screen returns to the "Water Depth screen", then the setting is completed.

The indicator **T** (Timer) will light up on the screen.

5. The reel will automatically starts winding up the rig at its maximum speed when the preset time has elapsed while the clutch is powered on after lowering the terminal rig.

-An audible alarm will sound before the reel starts winding.
 -If the clutch is powered OFF, the reel will not start automatic winding up.
 -The chumming timer automatically starts when the depth counter determined the depth 7.1 m. But, you can reset the timer and restart it by pressing **MEMO BUTTON** .

-For proper use of Timer winding function, press **MEMO BUTTON** when your terminal rig has reached the strike zone.

-Timer winding will be automatically turned OFF when the Drift mod is set to ON after the Timer Winding is set to ON.

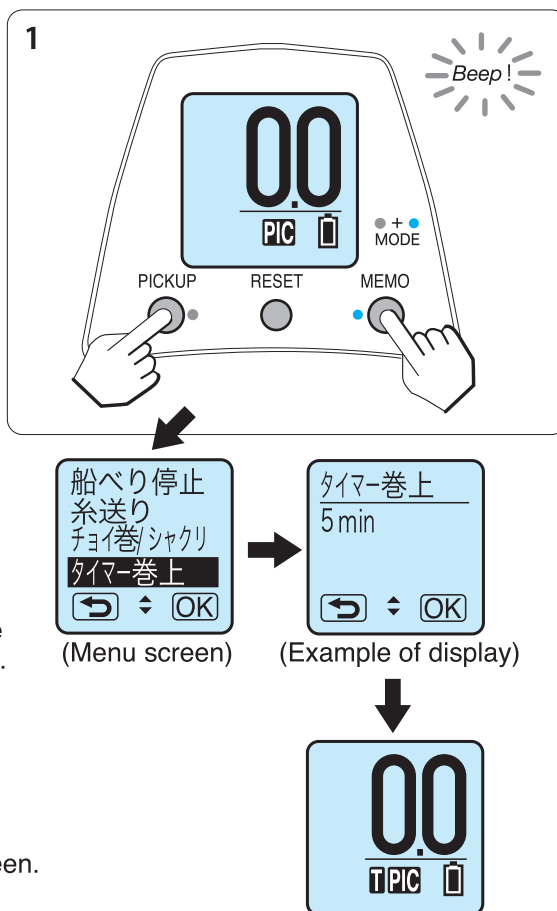

Functional setting [11. Drift mode]

How to use drift mode

1. Press and hold both **MEMO BUTTON** and **PICKUP BUTTON** simultaneously for 2 seconds to go to the Menu screen.
2. Select "Drift" mode with the Jog Power Lever and press **OK** (**MEMO BUTTON**). Then, select "ON" with the Jog Power Lever and press **OK** (**MEMO BUTTON**).

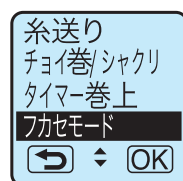
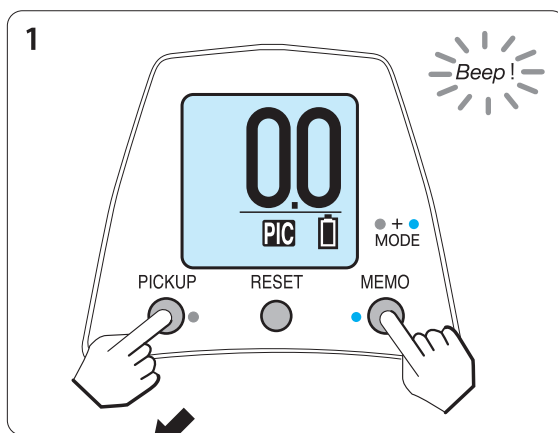
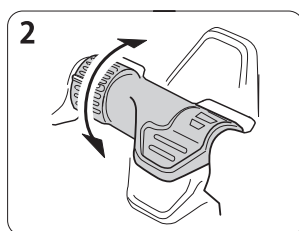

(Menu screen)



(Drift mode)

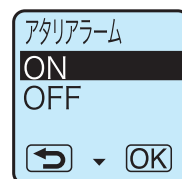

(Hit Alarm)

3. Select the Bite Alarm ON or OFF with the Jog Power Lever and press **OK** (**MEMO BUTTON**).

When the reel detects a move quicker than the preset sensitivity, the hit alarm goes off and informs you with the sound that there was a hit, allowing you to know that a fish hit it while you were not looking at it.

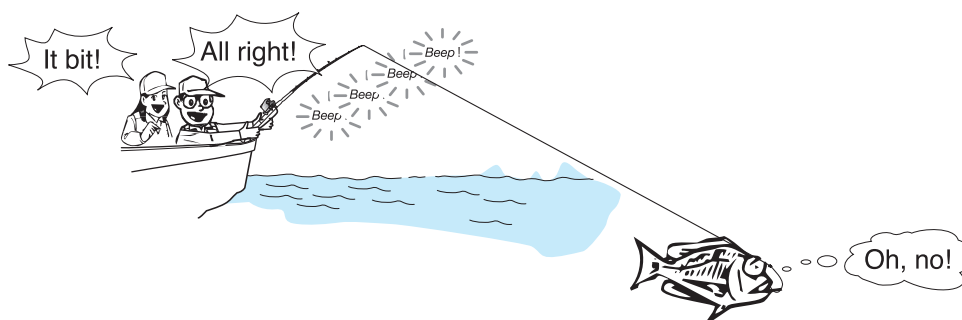

*The alarm does not go off when it is turned off.

Functional setting [11. Drift mode]

4. Select Bite Sensitivity with the Jog Power lever and press **OK** (**MEMO** **BUTTON**) .

-You can set the sensitivity level to detect a bite.
Adjust the sensitivity level according to the sea condition such as tide speed and wave size.

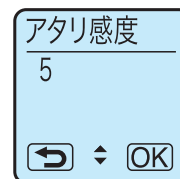
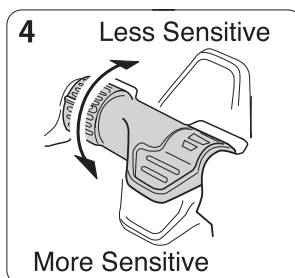

(Example of display)

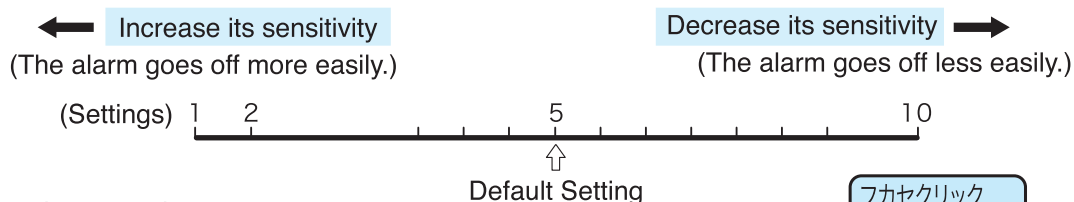

-The setting range is 1 to 10.

5. Select Drift Click ON or OFF with Jog Power Lever and press **OK** (**MEMO** **BUTTON**) to complete the setting.

-If Drift Click is set to ON, the alarm sounds every time when 1 m of the line goes out so that you can recognize the water flow (line feeding speed) by the sound.

-It starts from the water depth of 7.1 m.

-When the setting of the Drift mode is completed, **F** is displayed on the water depth screen.

-When the Drift mode has been set, the water depth will be automatically displayed in two vertical layers.

*When it is in the status of Drift mode ON, any setting changes of the sub-counter is not reflected to the screen, even if you change it from the menu screen.

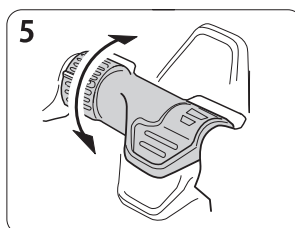

(Example of display)

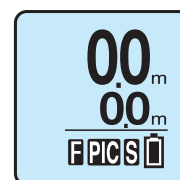

Fishing Zone memory

-This function automatically memorize the fishing zone where the Bite Alarm sounded. Even if you make haste to operate the rod, you can confirm a fishing zone because the Inverse Counter blinks and indicates the fishing zone where the Bite Alarm sounded.

*When you press the **MEMO** **BUTTON** , the depth of the fishing zone memorized in the Fishing Zone memory is converted and displayed as **0.0** .

*When the zone is located shallower than the memorized zone, the data is not updated until the reel stops at the boat side.

Blinking indication

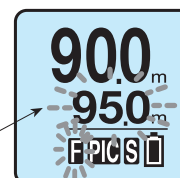

<Example of Fishing Zone memory>

(This shows that the line is temporarily wound up by 5.0 m from the depth of 95.0 m where the alarm sounds.)

Functional setting [12. Constant Speed Winding mode]

Constant Speed Winding mode

In this Constant Speed Winding mode, your line is wound up at the preset speed regardless of any load applied to the reel, while the winding speed normally slows down when a load is applied to the reel.

*Operation may become unstable depending on the condition of the sea or the movement of fish. In such case, cancel this mode.

1. Press and hold both **MEMO** **BUTTON** and **PICKUP** **BUTTON** simultaneously for 2 seconds to display the MENU screen.

2. Select "Constant Speed Winding" with the Jog Power Lever and press **OK** (**MEMO** **BUTTON**). Then, select "ON" with the Jog Power Lever and press **OK** (**MEMO** **BUTTON**).

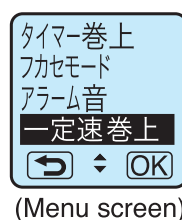
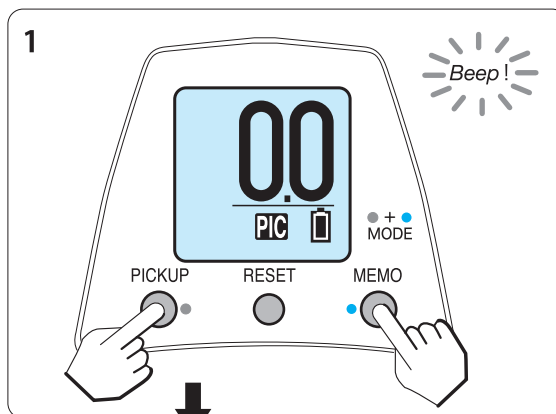
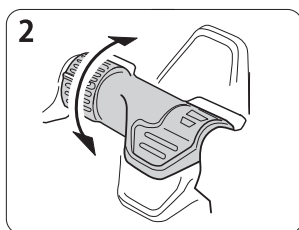

■ will appear at the lower left of the screen.

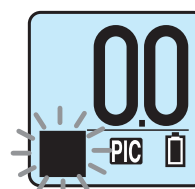

3. Adjust the Winding Speed you desire to keep with the Jog Power Lever and release your finger from the Jog Power Lever to complete the setting. After a while, automatic control starts to keep the preset speed.

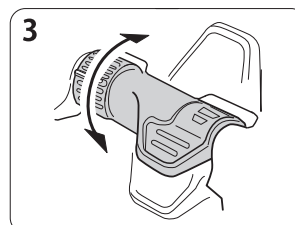

*The operating range is 1 to 30 on the scale of the Power Lever.

*While the Power Lever is set to **(H)**, Constant Speed Winding is disabled.

*If the load fluctuation is very large or if drag is set to relatively loose, operating the Jog Power Lever may cause the output to suddenly become larger or smaller. It is not abnormal.

Functional setting [13. Water depth recalibration]

Water depth recalibration

You can recalibrate the counter if it does not match the depth identified by the color markings on your line.

Use

You can recalibrate the counter while you are fishing!

(Example) To recalibrate the counter to 100 m to comply with the depth identified as just 100 m by the color of the line, though the counter shows 103 m.

1. When the water depth to be corrected is displayed, press and hold both **MEMO BUTTON** and **PICKUP BUTTON** simultaneously for 2 seconds to go to the Menu screen.
2. Select the "Water depth recalibration" with the Jog Power Lever and press **OK** (**MEMO BUTTON**).

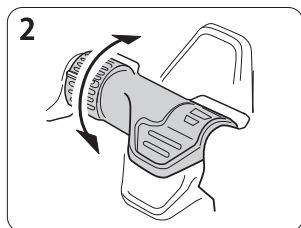

*The scrolling text 《Do you wish to continue?》 is displayed. If you confirm the choice, press **OK** (**MEMO BUTTON**) again.

*Any correction cannot be made if the water depth is less than 10.0 m.

3. Select your desired water depth with the Jog Power Lever and press **OK** (**MEMO BUTTON**) to return to the Water Depth screen.

*When the rate to be corrected is too large, it sometimes cannot be corrected.

4. Now, the water depth has been corrected.

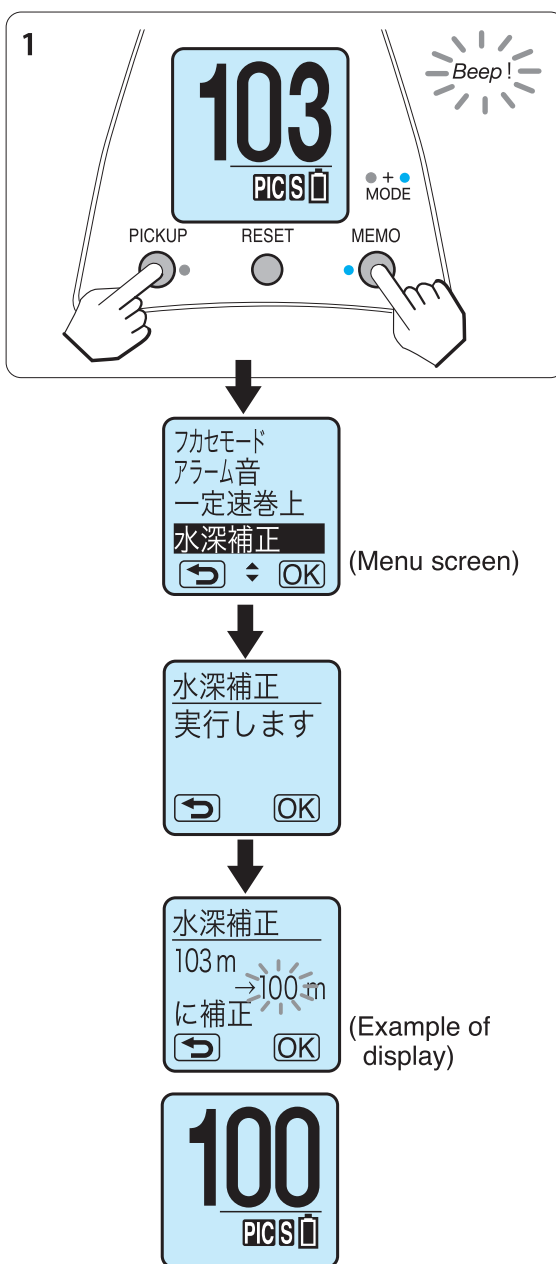

Functional setting [14. Actual fishing history]

Actual fishing history

You can check the total winding distance and the total hours of fishing using the electric reel.

1. Press and hold both **MEMO** **BUTTON** and **PICKUP** **BUTTON** simultaneously for 2 seconds to go to the Menu screen.

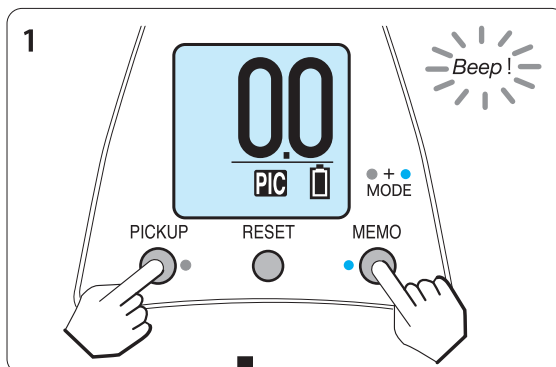

2. Select the "Actual fishing history" with the Jog Power Lever and press **OK** (**MEMO** **BUTTON**).

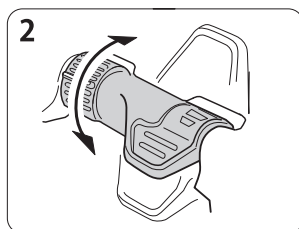

3. You can check the total winding distance and the total hours of fishing using the electric reel. Press **OK** (**MEMO** **BUTTON**) to return to the Water Depth screen.

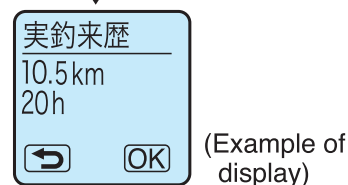

Functional setting (sold separately)

[15. How to fix the rod with clamp]

For mounting a rod onto a metallic bat or for your fishing with a heavy load on the rod charge, always fix the rod with clamp.

*A rod bat 16 to 28 mm in diameter is allowed to be fixed with the rod clamp.

1. Insert the bolt (S) or bolt (L), according to the bat diameter, into the mounting hole of the frame, secure the bolt with the nut.

*Use bolts (S) for a bat with a diameter of 16 to 22 mm or bolts (L) for a bat with a diameter of 22 to 28 mm.

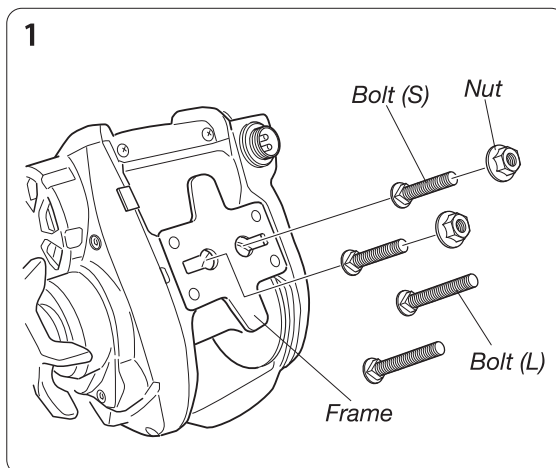

2. Set the reel on your rod. Put the clamp plate on the rod so as to clamp the rod. Secure them with the clamp plate washers and the clamp plate nuts.

*If you mount the reel on your rod with a small diameter (a diameter of 16 to 18 mm), put the clamp plate nut W between the clamp plate and the clamp plate nut.

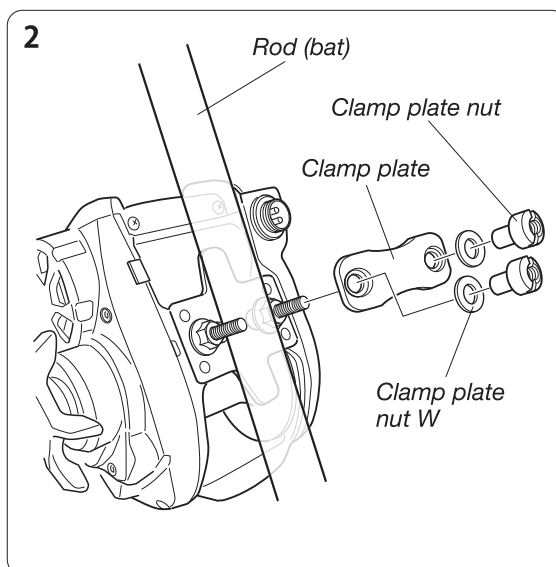

Attention

-If the nuts are tightened too tightly, there is a risk of deformation in the reel seat portion on the rod if the reel seat material is resin.
 -Do not use the reel with bolts only fixed without any other parts fixed. It may cause a risk of injury on your fingers cut by the threading of the bolts.

Functional setting [16. How to remove the handle knob]

1. Loosen and take out the handle knob cap with the attached tool, while pushing the handle knob by hand.

*Beware that the nail is a retort. And turn the attached tool with itself tightly fit into the handle knob cap, as otherwise the handle knob cap will be hurt.

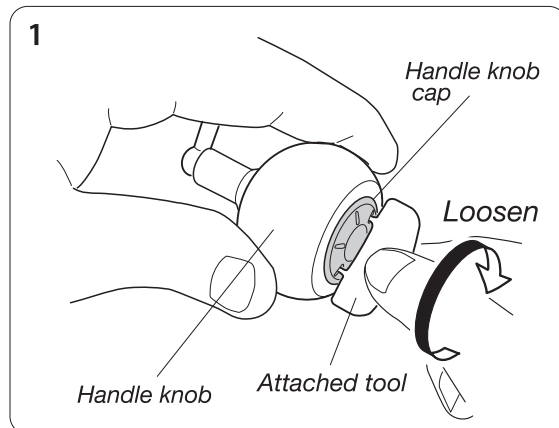

2. Loosen and remove the screw fixed inside of the knob using a screw driver.

*Note that the screw is coated with a slack preventing agent and it is hardly loosened. Be careful not to damage the screw head.

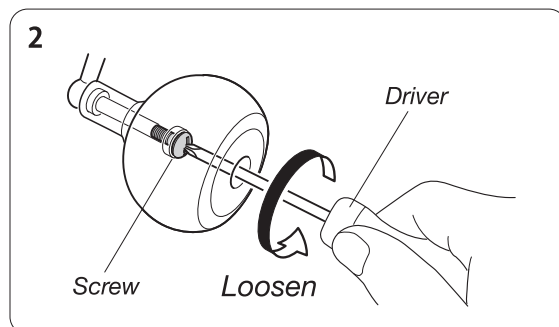

3. The handle knob is composed of as shown in the figure.

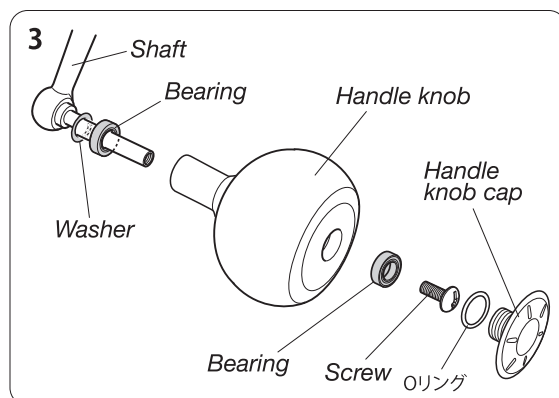

Functional setting [17. Other useful functions]

Various alarms

Many kinds of information are indicated by audible alarms such as auto stop alarm and range memory alarm.



Jog Power Lever alarm

-When you place the Jog Power Lever at MAX or OFF position, an alarm beeps to tell you its position.

Auto stop alarm

-While winding up, an alarm shortly beeps starting 6 m below the auto stop point, at two meter intervals, to tell you that the rig is coming closer to the auto stop point. When it reached the auto stop point, an alarm sounds for longer.

Range memory alarm

-While lowering your rig back into the strike zone, an alarm shortly beeps starting 10 m above the memorized depth range of the strike zone, at 2 m intervals, to tell you that the rig is reaching closer to the strike zone. When the rig reached the strike zone, an alarm sounds for longer. This feature can be used only when the Inverse counter is turned ON.

*This zone memory alarm is designed not to sound unless the line has been wound more than 6 m above the memorized depth and the line is fed again for the purpose of preventing the alarm from frequently sounding while seeking the strike zone.

Fishing Zone alarm is enabled by setting "Inverse counter" from the "Sub counter" menu to set it.

Switch alarm

-Each time a button is pressed, a beep is sounded to allow you to confirm that you have surely pressed a button (You can set this alarm to OFF in the setting of functions from the Menu screen).

Excessive voltage alarm

-If you connected a power source with a voltage higher than the acceptable range, a continuous alarm will sound to warn you to stop operation. DO NOT operate the reel with such battery.

Timer winding alarm

-This alarm sounds to tell you before starting a chumming timer winding.

Alarm sound ON/OFF setting

You can set the alarm sound to OFF.

-It is set to ON by default.

-Once the alarm sound has been set to OFF, the alarm will no longer sound even if you have pressed buttons or have used the power lever for operation.

-Bite Alarm, Drift click, and Drag sound will not be turned off in the Drift mode, even if alarm sound has been set to OFF.

1. Select "Alarm sound" in the Menu screen.

2. Select OFF with the Jog Power Lever.

3. Press **OK** (**MEMO BUTTON**). If the screen returns to the "Water Depth screen", then the setting is completed.

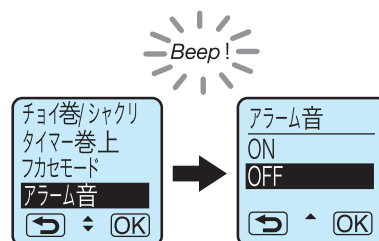

Functional setting [17. Other useful functions]

Language setting

You can select the language to be displayed on the LCD screen from Japanese, English, Traditional Chinese, Simplified Chinese or Korean.

1. Select "Language" in the Menu screen.
2. Select your desired language with the Jog Power Lever.
3. Press **OK** (**MEMO** **BUTTON**). If the screen returns to the "Water Depth screen", then the setting is completed.

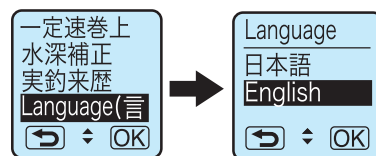

Unit setting

You can select "m" (meter) or "ft" (feet) for a unit to be used for the length.

*Note that the unit is represented in "m" (in meters) only when entering a value in "Main line input" even if "ft" (in feet) has been set for the unit.

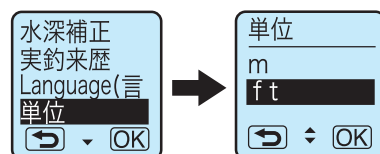

Counter lamp

The lamp built in the counter always lights up.

- While the reel is powered ON, backlighting of the display always provides easier reading for fishing in the dark.

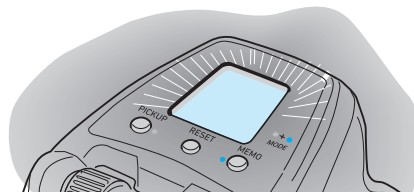

Circuit breaker display

The lamp built in the counter always lights up.

- When an excessive heavy load is applied on the reel or an excessive temperature rise is detected, the circuit breaker will be tripped and the winding operation will be stopped to prevent damage to the reel body. It stops for 5 seconds if an excessive load is applied, or for 15 seconds if an excessive temperature rise occurs.

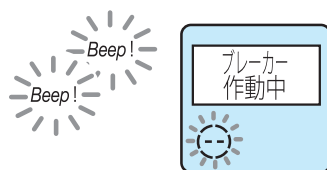

(Indicator is blinking)

Reel Specifications

Reel Specification list

LEOBRITZ S500JP

Product name			00810040
Gear ratio(manual winding)			3.6:1
Weight (g)			800
Max Drag power (kg)			16
Line Capacity (m)	PE (model-m)	4	500
		5	400
		6	300
		8	220
	Nylon (lb-m)	6	350
		7	300
		8	250
Number of bearings (Ball / Roller)			8/1
Power-supply voltage			DC12V~16.8V
Maximum winding power *1 (Kg)			75
Normal winding speed (with 1kg load) *2(m/min)			135
AFS standard winding power *3(Kg)			15
JAFS standard winding speed *3(m/min)			170
Current (A)	No load		3
	Stall		5
	Max		25
Speed shifting	No load		0 – 170 m / min (continuous shifting)
Compatible battery			DAIWA Super Lithium Series DAIWA Tough Battery Series

*1:Maximum winding power: Reference value of shaft torque at supply voltage 13V (Kg=Kgf·cm)

*2:Normal winding speed: Average winding speed of 100 m line with 1kg load at supply voltage 13V

*3:JAFS standard winding speed / winding speed = Regulation of JFTMA (Japan Fishing Tackle Manufacturer's Association), actual measurement value at supply voltage 13V

Counter display

Depth display range	Upper counter: 0.0 to 3,000 m Lower counter: - 3,000 m to 3,000 m
Usable temp. range	-10 to +60 (degrees centigrade)

*The specifications are subject to change without prior notice for product improvement.

Parts List

LEOBRITZ S500JP

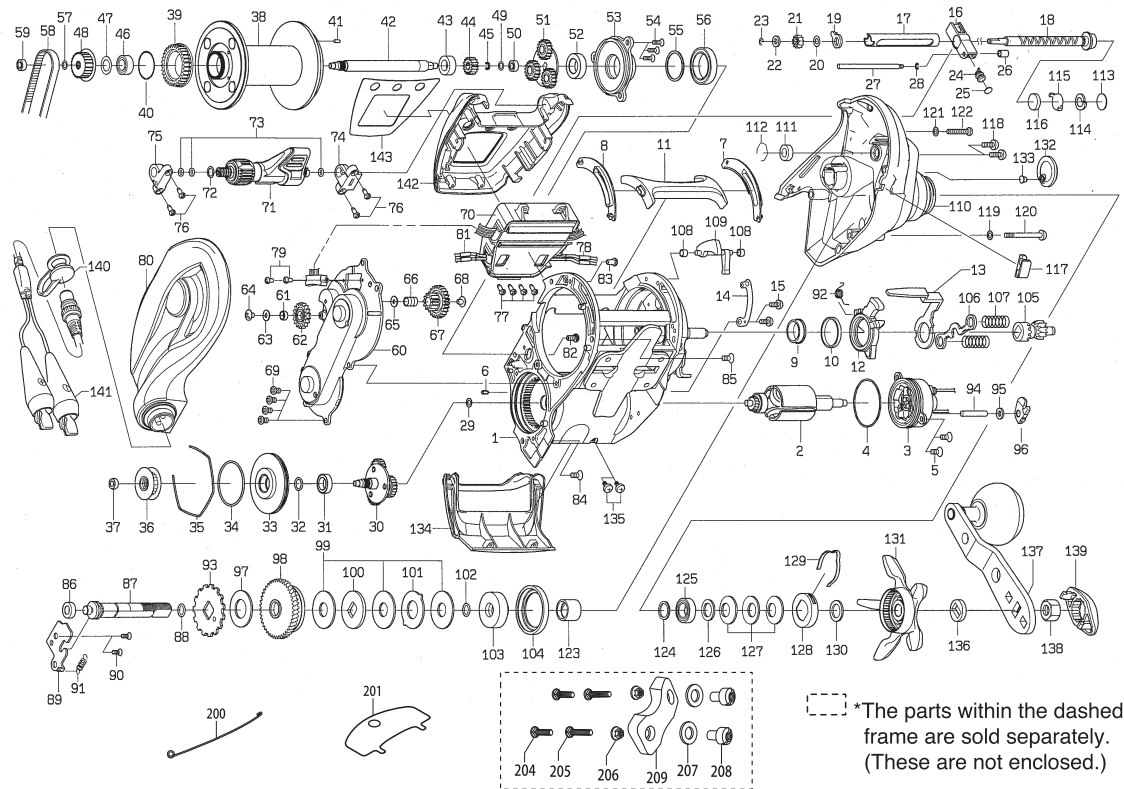

No.	Parts Name	No.	Parts Name	No.	Parts Name	No.	Parts Name
1	FRAME AS	40	RING	79	SCREW-PHM	118	SCREW-HSM
2	ROTOR UN	41	PIN	80	SIDE PLATE(L) AS	119	WASHER
3	MOTOR HOLDER UN	42	MAIN SHAFT	81	TUBE	120	SCREW-HSM
4	O-RING	43	BEARING	82	SCREW-PHM	121	WASHER
5	SCREW-PHM	44	GEAR	83	SCREW	122	SCREW-PHM
6	PIN	45	RETAINER	84	SCREW-FHM	123	COLLAR
7	PLATE(R)	46	BALL BEARING	85	SCREW-FHM	124	WASHER
8	PLATE(L)	47	WASHER	86	BEARING	125	BALL BEARING
9	BEARING	48	PULLEY AS	87	GEAR SHAFT	126	WASHER
10	COLLAR	49	WASHER	88	O-RING	127	SPRING WASHER
11	CLUTCH BAR	50	BALL BEARING	89	PLATE	128	CAP AS
12	CLUTCH CAM	51	METAL AS	90	SCREW-FHM	129	LEAF SPRING
13	CLUTCH CAM PLATE	52	BEARING	91	SPRING	130	WASHER
14	PLATE	53	PLATE	92	SPRING	131	STAR DRAG
15	SCREW-PHM	54	SCREW	93	RATCHET	132	CAP
16	LEVEL WIND AS	55	WASHER	94	PIN	134	FINGER COVER
17	PIPE	56	BALL BEARING	95	WASHER	135	SCREW-PHT
18	WORM SHAFT AS	57	WASHER	96	STOPPER AS	136	COLLAR
19	COLLAR	58	BELT	97	WASHER	137	HANDLE AS
20	WASHER	59	BALL BEARING	98	DRIVE GEAR	138	NUT
21	GEAR	60	SET PLATE	99	WASHER	139	CAP
22	WASHER	61	COLLAR	100	WASHER	140	CAP
23	RETAINER	62	GEAR	101	WASHER	141	CORD
24	LEVEL WIND PIN	63	WASHER	102	O-RING	142	COUNTER COVER
25	WASHER	64	SCREW-THM	103	COLLAR	143	NAME PLATE
26	COLLAR	65	WASHER	104	PACKING	200	LINE THROUGH
27	PILLAR	66	COLLAR	105	PINION	201	DRIVER
28	RETAINER	67	GEAR	106	CLUTCH PLATE	204	CLAMP SCREW (Short)
29	WASHER	68	SCREW-THM	107	SPRING	205	CLAMP SCREW (long)
30	METAL AS	69	SCREW-PHM	108	COLLAR	206	CLAMP SCREW NUT
31	BALL BEARING	70	COUNTER AS	109	LEVER AS	207	CLAMP PLATE NUT WASHER
32	O-RING	71	LEVER AS	110	SIDE PLATE(R) AS	208	CLAMP PLATE NUT
33	PLATE	72	WASHER	111	BEARING	209	CLAMP PLATE (sold separately)
34	O-RING	73	O-RING	112	RING		
35	RING	74	HOLDER	113	WASHER		
36	PULLEY AS	75	HOLDER	114	SPRING WASHER		
37	BEARING	76	SCREW-PHT	115	WASHER		
38	SPOOL AS	77	SCREW-PHT	116	WASHER		
39	GEAR	78	TUBE	117	LINE STOPPER		

There may sometimes be a difference between the purchased reel and the Dismantled Parts Chart or the parts list above due to the adjustment process etc. We appreciate your understanding.

Trouble shooting

Symptom	Possible causes	To do	Ref. page
Motor does not respond to the power lever.	The counter value is below 0.0 m due to winding-up even after auto stop.	It is a normal function to avoid over winding.	P30
	Did not pull the lever to OFF position.	Pull the lever to OFF and then move forward again to start winding.	P13
	Unstable power source.	Use another power source, such as electric reel specific batteries.	P9
Counter display does not appear.	Battery charge is low.	Recharge the battery.	P9
	Cord worn or corroded.	Replace the cord.	P11
	Incorrect battery connection.	Connect clips correctly without + / - reverse connection.	P8
Auto stop function does not work.	RESET BUTTON was not pressed when your terminal rig was set.	Set the surface depth to zero after setting rig.	P30
	Error for sinker weight or rocking of the boat.	Adjust settings of auto stop function.	P31
	Line is elongated.	Reset the depth counter at the surface.	P30
There are counter errors.	Line length has increased due to stretching.	Re-enter line data.	P17~26
		Recalibrate the water depth.	P43
	Line was wound while powered off during fishing.	Re-enter line data.	P17~26
	RESET BUTTON was pressed and held while feeding the line.	Re-enter line data.	
Pickup does not respond.	Speed setting is at zero.	Go to the Menu screen to set the Jigging again.	P34
	Distance is already below +3 m from auto stop.	Designed not to wind in this range for safety.	P34
Jigging function does not respond.	Power lever is at OFF.	Jigging Speed is set to "0". Set the Jigging Speed to your desired speed with the Jog Power Lever.	P35~37
	Distance is already below +3 m from auto stop.	Designed not to wind in this range for safety.	
	Pickup mode is selected.	Go to the Menu screen to set the Jigging.	

*Contact your dealer if the reel does not function properly despite the above details being confirmed, in the event of other problems arising, and to order parts.

アフターサービスについて

本製品は当社の厳重な検査を経て出荷されたものですが、万一、故障が生じ修理が必要な場合、あるいは部品御注文の際は買い求めの販売店、または下記のお客様センターまでお問い合わせください。なお、修理品は部品代のほか手数料をいただきますのでご了承ください。

お客様センター（無料） 携帯電話からでもご利用できます

TEL **0120-506-204**

受付時間：9:00～17:00 （土・日・祝祭日は除く）

ホームページ上からもご確認、お問い合わせできます

www.daiwa.com/jp/

グローブライド株式会社

〒203-8511 東京都東久留米市前沢3-14-16