

# SPINNING REEL REGAL RG-Z2505BL (NEW)

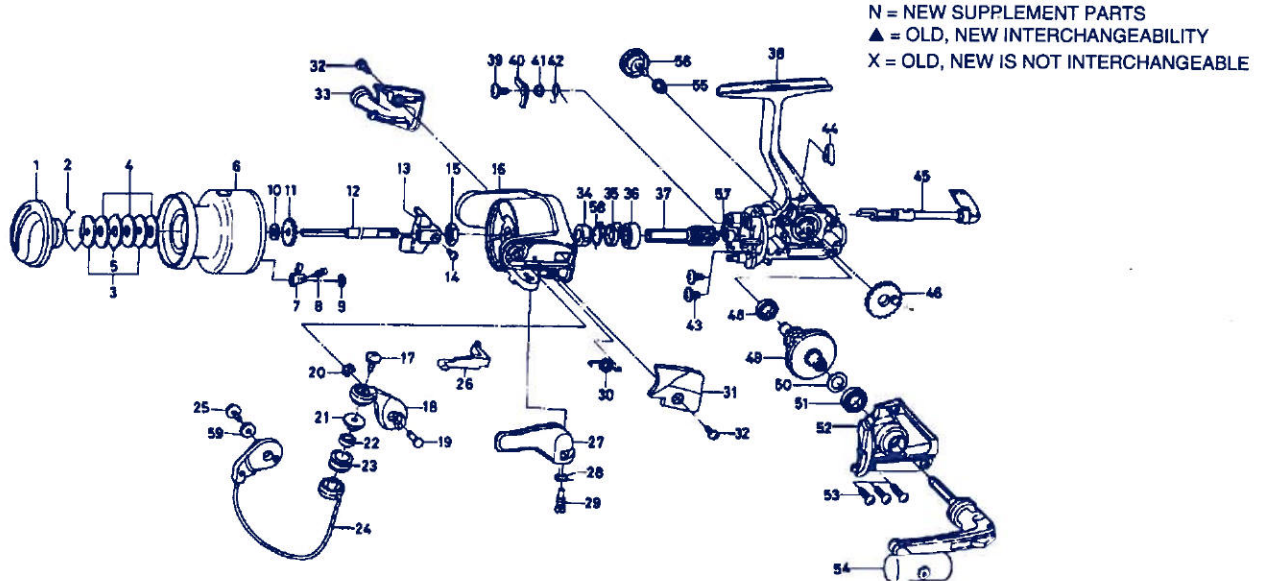

N = NEW SUPPLEMENT PARTS  
 ▲ = OLD, NEW INTERCHANGEABILITY  
 X = OLD, NEW IS NOT INTERCHANGEABLE

Key NO.	Parts No.	Parts Name
2-9	F32-5503	Spool assembly
1	F28-0904	Drag knob
2	171-7701	Drag washer retainer
3	E46-7201	Key washer
4	E13-6003	Drag washer
5	373-3603	Eared washer
6	F32-5603	Spool assembly
7	B07-5304	Click pawl
8	E40-3101	Click spring
9	320-5901	Click retainer
10	E46-7101	Spool washer
11	270-6501	Click gear
12	▲ F38-9601	Main shaft
13	E45-1401	Oscillating slider
14	351-0315	Oscillating slider screw
15	▲ F33-6102	Rotor nut
16	▲ F41-0701	Rotor
17	B67-9304	Line roller screw
18	F17-9803	Bail arm
19	E49-3501	Bail arm screw
20	320-5901	Bail arm screw retainer
21	X F40-1401	Line roller collar
22	F05-5601	Ball bearing A
23	F05-8901	Line roller
24	F32-7401	Bail assembly
25	B84-2102	Bail trip cam screw
26	E45-1601	Bail trip lever
27	F18-0003	Trigger lever
28	E36-9901	Trigger spring
29	E41-7801	Trigger screw
30	F12-8901	Bail spring
31	F31-0503	Bail spring cover
32	E24-8101	Bail spring cover screw
33	F31-0603	Bail trip cover
34	E49-2402	Anti-reverse ratchet
35	N F37-5101	Spring holder
36	L03-6601	Ball bearing B

Key NO.	Parts No.	Parts Name
37	X F37-7501	Pinion gear
38	X F37-8901	Body assembly
39	L00-1801	Anti-reverse pawl screw
40	▲ F37-5001	Anti-reverse pawl
41	L01-4302	Anti-reverse pawl collar
42	L00-1501	Anti-reverse pawl spring A
43	E03-7801	Bearing retainer screw
44	E32-7801	Anti-reverse cam spring
45	F08-5121	Anti-reverse lever
46	E45-1301	Oscillating gear
48	E30-6801	Ball bearing C
49	F17-0001	Drive gear
50	373-7800	Drive gear washer
51	631-6901	Ball bearing D
52	F37-9202	Side cover
53	B00-9701	Side cover screw
54	F32-7003	Handle assembly
55	▲ F40-4801	Handle collar
56	F03-5605	Handle lock screw
57	N E24-3301	Pinion collar
58	N F38-4701	Anti-reverse pawl spring B
59	N F40-1001	Bail holder washer