

MULTIPLYING REEL SEALINE — SG50H, SL50SH

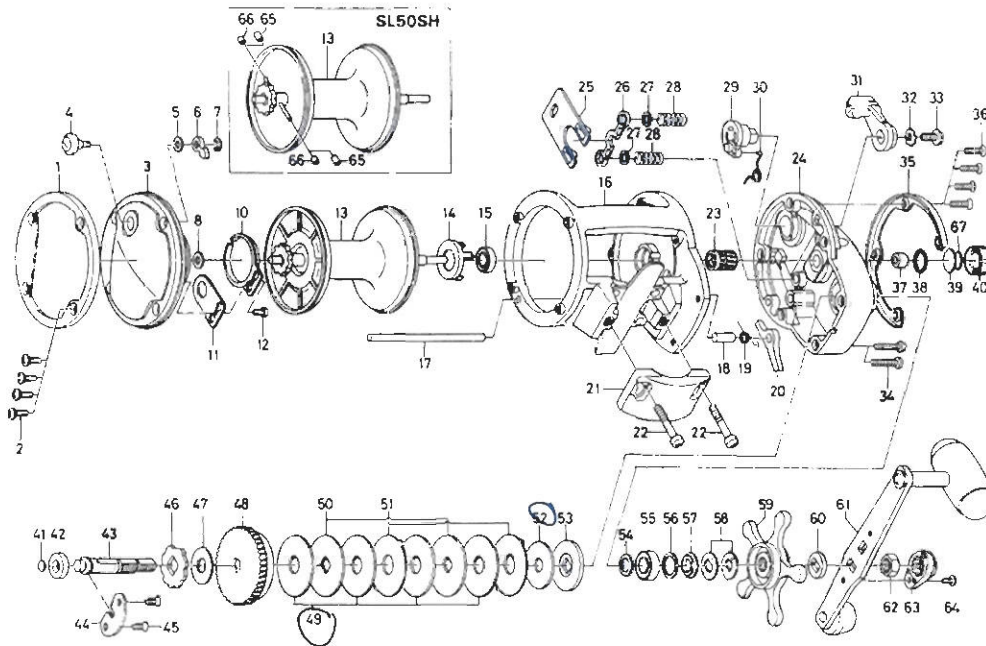

Key

Key No.	Part No.	Part Name
1	F09-9401	Left side outer ring
2	F09-3601	Left side plate screw
3	F09-8601	Left side plate
4	E36-1301	Click button
5	373-1600	Click pawl washer
6	030-6222	Click pawl
7	320-1402	Click pawl retainer
8	F13-2601	Spacer A
10	160-7922	Click spring
11	F13-1801	Click spring retainer
12	B83-4402	Click spring screw
13	F09-8801	Spool assembly
14	F09-7801	Bearing retainer
15	637-5701	Ball bearing A
16	F09-7401	Frame assembly
17	F09-9301	Stabilizer bar
18	F09-8201	Anti-reverse pawl pin
19	E31-6501	Anti-reverse pawl spring
20	B29-4301	Anti-reverse pawl
21	E31-8301	Rod clamp
22	E31-8401	Clamp bolt
23	F09-8001	Pinion gear
24	F09-6901	Right side plate
25	F09-7901	Yoke plate
26	E25-2101	Yoke
27	E03-7704	Yoke washer
28	E33-5301	Yoke spring
29	F09-7301	Clutch cam
30	144-6403	Clutch spring
31	E42-6802	Clutch lever
32	160-8001	Clutch lever lock washer
33	E00-7602	Clutch lever screw
34	E04-3302	Right side plate screw A
35	F09-7201	Right side outer ring
36	F09-3601	Right side plate screw B
37	636-3101	Bushing A
38	B05-5201	"O" ring
39	375-7501	Spacer B

Key

Key No.	Part No.	Part Name
40	E31-5401	Cast control cap
41	374-9102	Drive shaft washer A
42	B73-8001	Bushing B
43	F09-8301	Drive shaft
44	F09-8401	Drive shaft retainer
45	E31-6701	Drive shaft retainer screw
46	E25-2903	Anti-reverse ratchet
47	374-6605	Drive shaft washer B
48	F09-8501	Drive gear
49	E31-6902	Drag washer A
50	E31-7001	Key washer A
51	E31-7101	Eared washer
52	E32-6502	Drag washer B
53	E31-7201	Key washer B
54	373-7807	Bearing washer A
55	B62-8601	Ball bearing B
56	B68-4402	Bearing washer B
57	E25-3301	Ball bearing collar
58	E25-3501	Drag spring washer
59	E25-3602	Star drag
60	E25-3901	Spacing sleeve
61	E17-5503	Handle assembly
62	B86-2101	Handle nut
63	E44-0001	Handle nut plate
64	352-2503	Handle nut plate screw
67	B17-5503	Spacer C

SL50SH Special Parts:

3	F11-2101	Left side plate
13	F11-2201	Spool assembly
16	F12-4901	Frame assembly
23	F11-1701	Pinion gear
24	F09-6902	Right side plate
42	637-5701	Ball bearing C
48	F11-2001	Drive gear
65	B35-2701	Brake collar A
66	B35-2801	Brake collar B