

# MULTIPLYING REEL SEALINE — SG27LC / 47LC

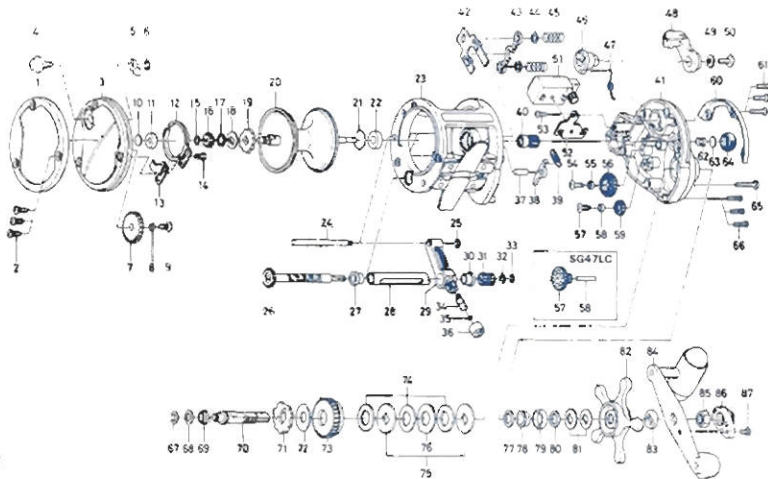

**Key**

Key No.	Part No.	Part Name
1	F09-3901	Left side outer ring
2	F09-3601	Left side plate screw
3	F09-3701	Left side plate
4	B21-6602	Click button
5	030-6612	Click pawl
6	320-1402	Click pawl retainer
7	B21-5801	Idle gear
8	B65-6201	Idle gear collar
9	E10-7401	Idle gear screw
10	375-7405	Bushing washer
11	637-5601	Bushing A
12	160-7922	Click spring
13	B21-5501	Click spring retainer
14	B83-4402	Click spring screw
15	320-8002	Spool gear retaining ring
16	403-2901	Spool gear
17	E15-4801	Click lever washer
18	E36-1401	Click spring washer
19	B21-6701	Click gear
15-20	F09-4201	Spool
21	B27-0501	Bearing retainer
22	F07-8301	Bushing B
23	F09-2301	Frame assembly
24	F09-3001	Stabilizer bar
25	320-5901	Stabilizer bar retainer
26	F09-2601	Worm shaft assembly
27	E14-4801	Worm bearing
28	F09-2801	Level wind guard
29	E36-2401	Line guide assembly
30	E14-4801	Worm bearing
31	F09-2901	Counter gear
32	B41-1702	Worm shaft holder washer
33	320-5901	Worm shaft retainer
34	122-0601	Line guide pawl
35	375-4101	Line guide washer
36	E35-4101	Pawl cap
37	E25-2301	Anti-reverse pawl pin
38	B62-6801	Anti-reverse pawl
39	E23-4201	Anti-reverse pawl spring
40	F13-5401	Pinion gear
41	F09-1701	Right side plate
42	F09-3101	Yoke plate
43	E25-9101	Yoke
44	E03-7704	Yoke washer
45	E33-5301	Yoke spring
46	F09-2001	Clutch cam
47	E32-2301	Clutch spring
48	E42-6802	Clutch lever

**Key**

Key No.	Part No.	Part Name
49	160-8001	Clutch lever lock washer
50	E00-7602	Clutch lever screw
51	F09-2101	Counter assembly
52	E24-1801	Counter plate
53	E15-7502	Counter screw
54	E10-7401	Counter gear screw
55	B65-6201	Counter gear collar
56	E24-1901	Counter gear A
57	E10-7401	Counter gear screw
58	B65-6201	Counter gear collar
59	F09-2201	Counter gear B
60	F09-3501	Right side outer ring
61	F09-3601	Right side plate screw A
62	B93-9601	Spool tension spring
63	357-7405	Spacer A
64	B93-9702	Cast control cap
65	B00-9702	Right side plate screw B
66	E11-9601	Right side plate screw C
67	320-7602	Drive shaft retainer
68	375-5805	Drive shaft washer A
69	E25-2501	Drive shaft bush
70	E25-2601	Drive shaft
71	E25-2801	Anti-reverse ratchet
72	374-6604	Drive shaft washer B
73	F09-3401	Drive gear
74	E32-6501	Drag washer
75	E20-0201	Key washer
76	376-3101	Eared washer
77	373-7806	Spacer B
78	E32-6301	Spacing sleeve
79	E32-6401	Bushing C
80	373-7806	Spacer C
81	E25-3501	Drag spring washer
82	E25-3601	Star drag
83	E25-3901	Spacing sleeve
84	F09-4101	Handle assembly
85	B86-2101	Handle nut
86	E44-0001	Handle nut plate
87	351-1803	Handle nut plate screw

**SG47LC Special Parts:**

3	F09-3702	Left side plate
15-20	F09-5901	Spool
23	F09-5201	Frame assembly
24	F09-5801	Stabilizer bar
26	F09-5501	Worm shaft assembly
28	F09-5701	Lever wind guard
40	F09-3201	Pinion gear
41	F09-1702	Right side plate